

# **Assembly Instruction**

**Loading platform kit for Carson Goldhofer STN-L3  
M1:14 with two spare wheel holder**

**Best.-Nr.: 2023-9345-GOPLA-A1**

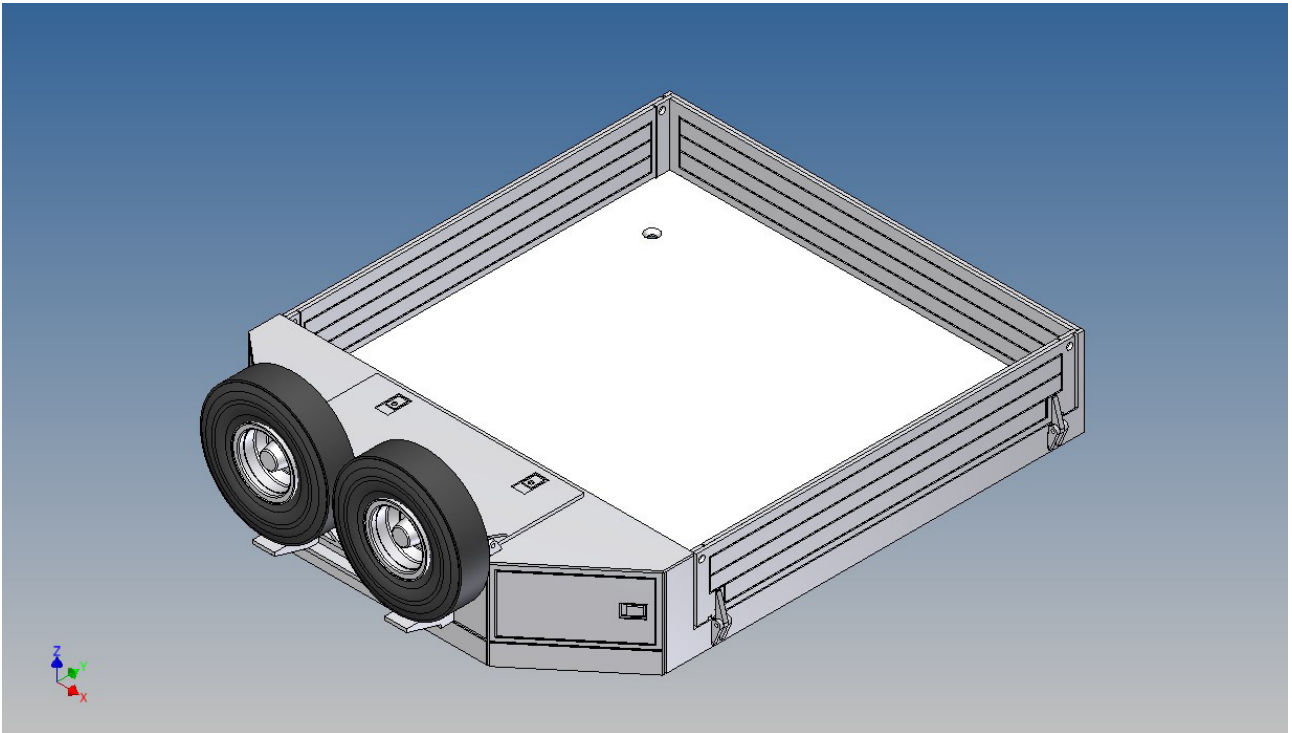

**Version 1.0 – 20.07.2023**

## **General Description**

This set of polystyrene milling parts is designed for a loading platform as an accessory for the Carson Goldhofer STN-L3 low loader.

The platform is screwed on with the same four screws as the original loading platform of the Carson kit.

Both, the front cover on the top and the two side walls, can be opened.

Magnets are included to close the side flaps.

The front storage space is ideal for storing electronics or a battery (opening size 89mm x 39mm).

For the attached spare wheel holder + rim (3D printed PLA) there are already position engravings in the front panel.

We recommend the Carson low-loader tire set (500907583) as a spare tire.

## **Assembly Procedure**

Before you put the parts together please read the assembly instructions carefully and pay attention to the assembly sequence and test the fitting accuracy of the parts before gluing them together.

It is helpful to fix the parts at first only on a few points with super-glue and after a check along the edges fully with super-glue or a polystyrene-glue.

The parts are made of polystyrene, if you use super-glue in combination with activator spray, please be aware that the activator spray can destroy polystyrene – because of that you should use it very carefully or use only polystyrene-glue.

Grundplatte /  
base plate

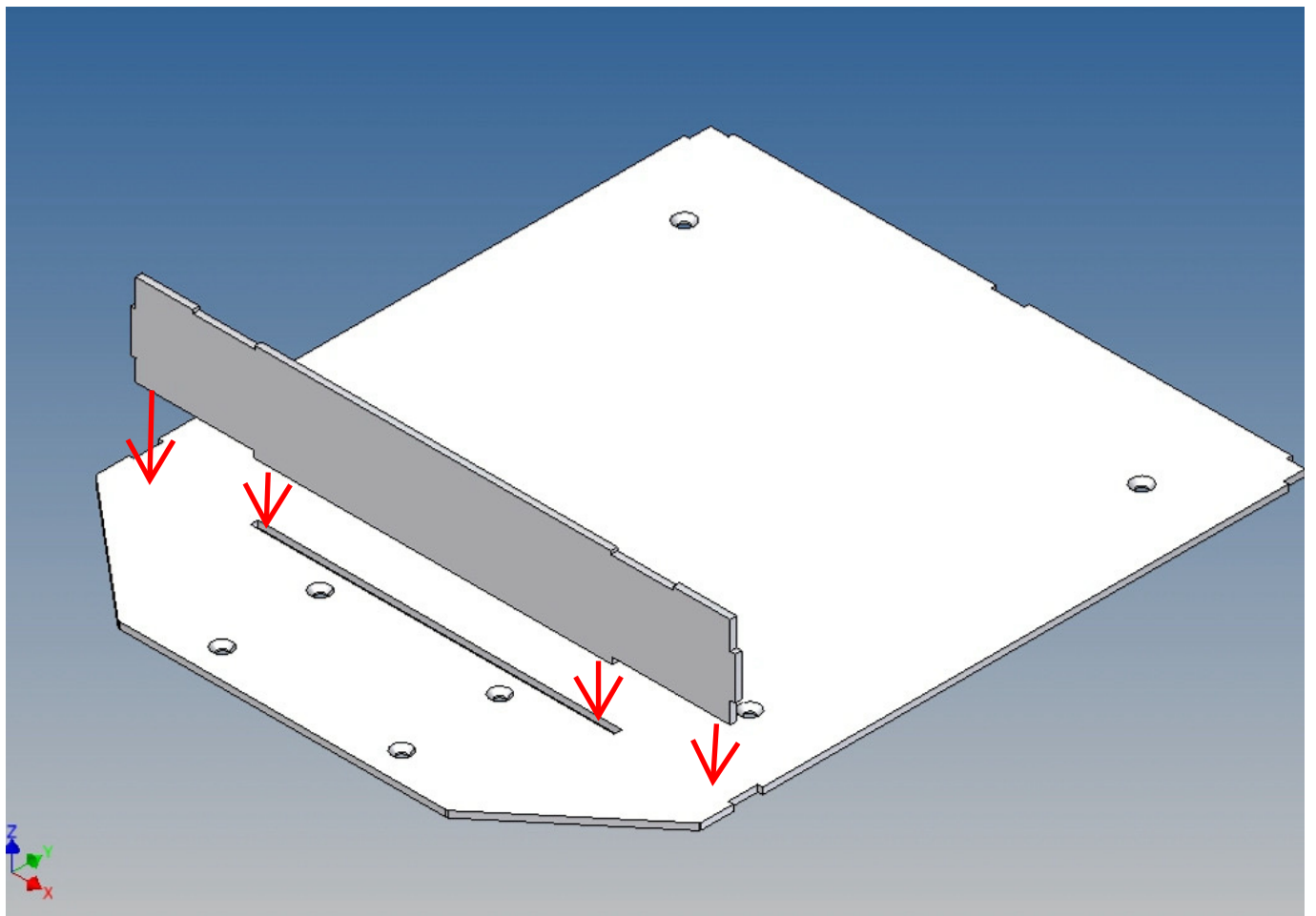
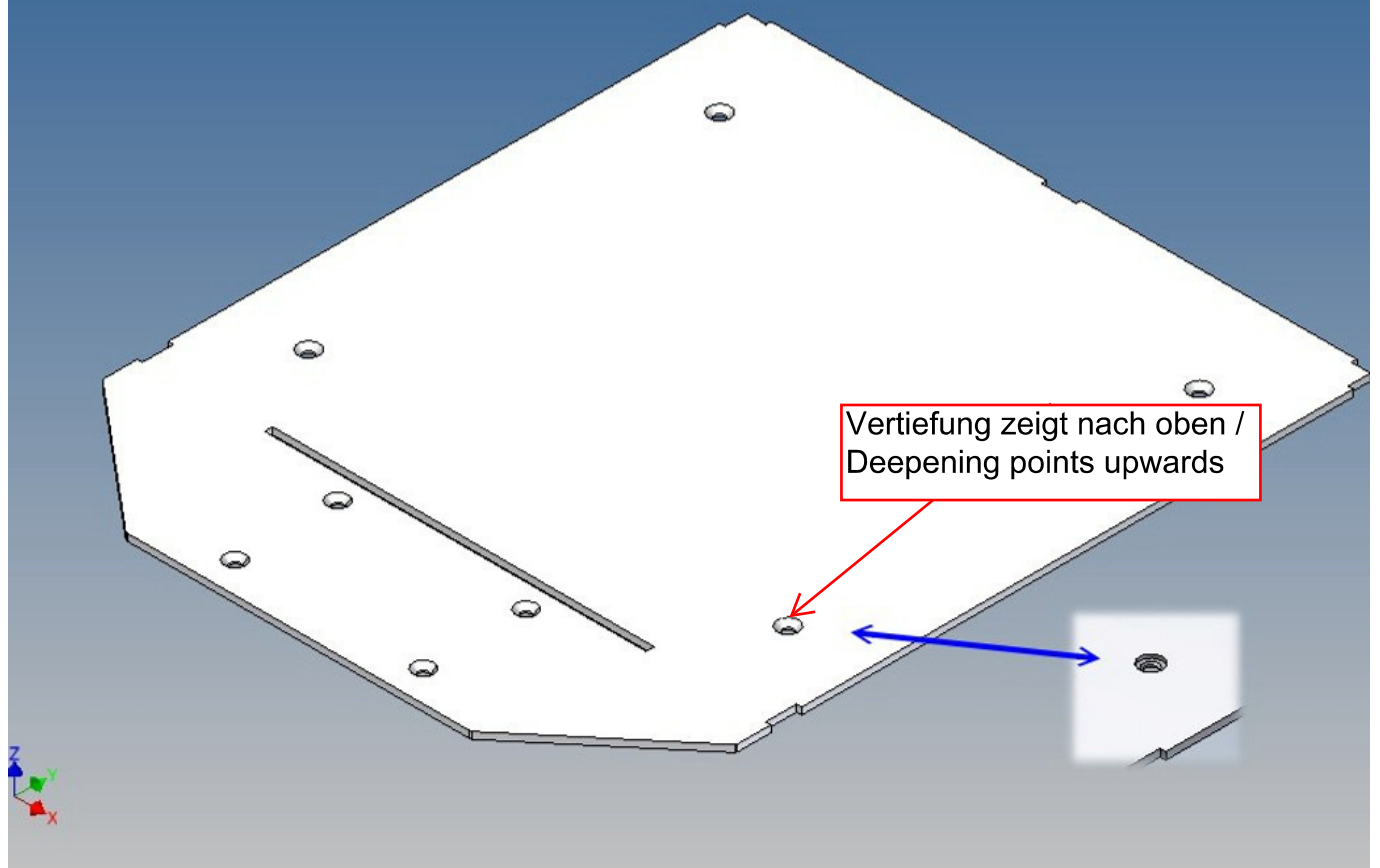

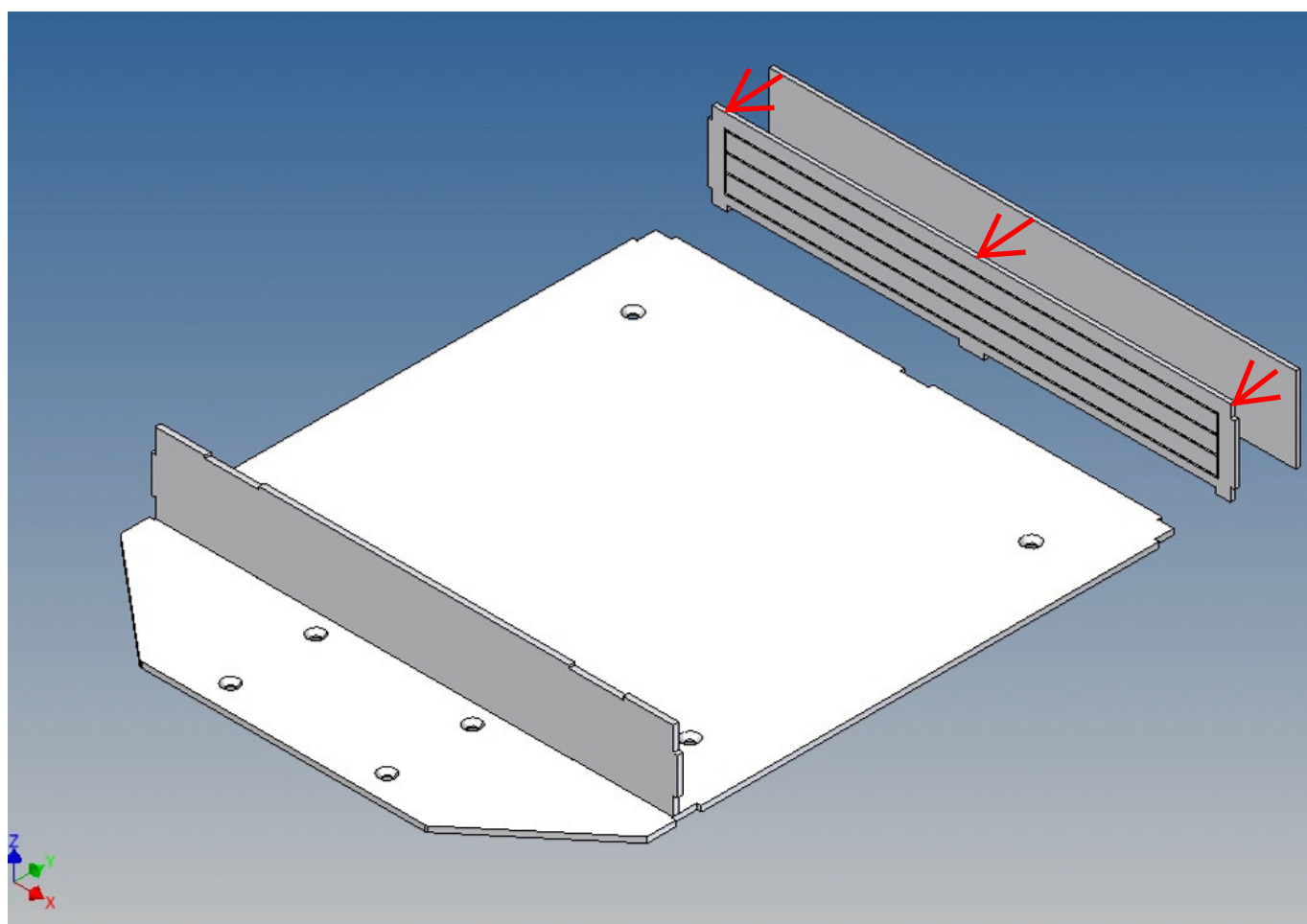
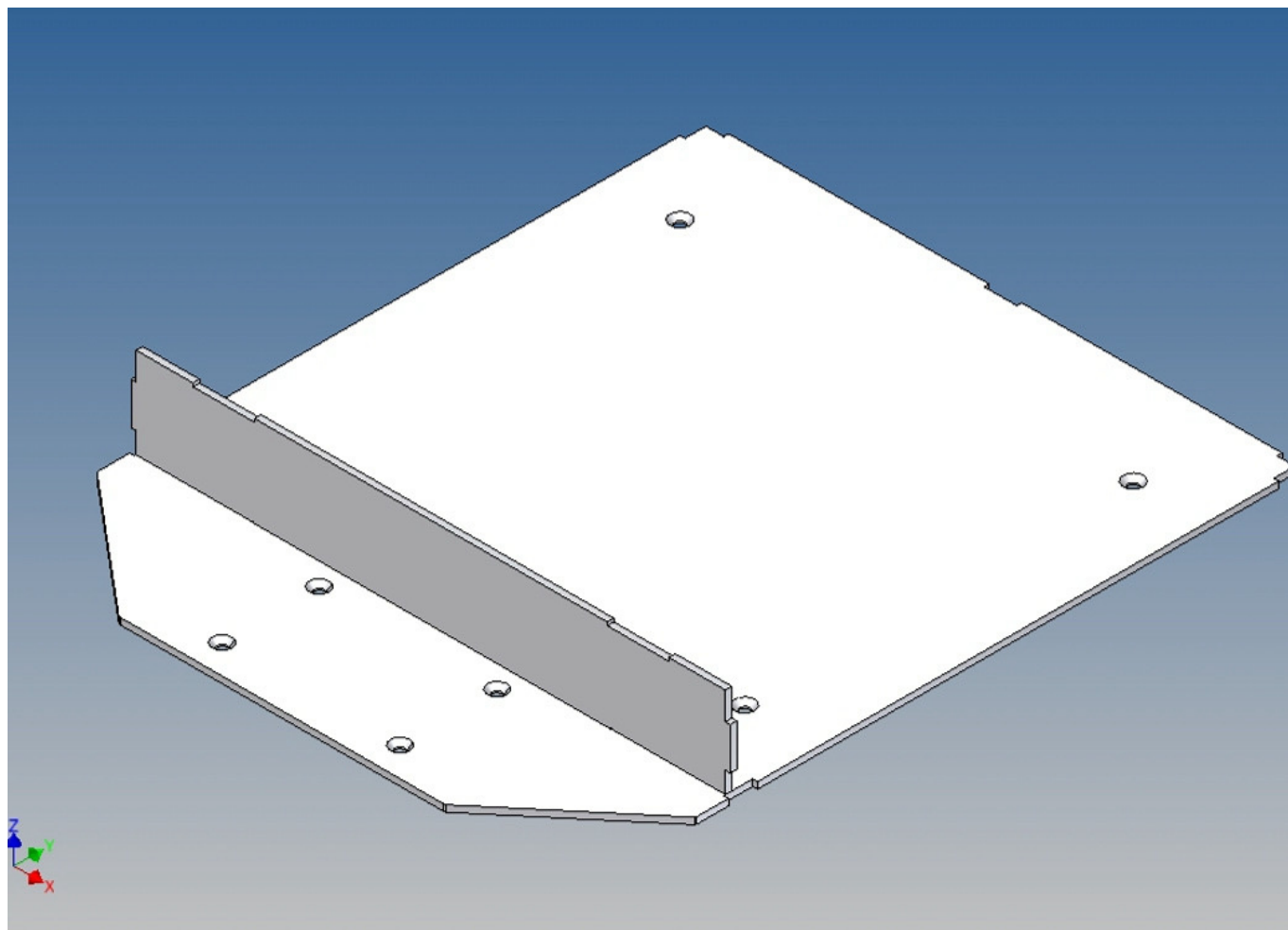



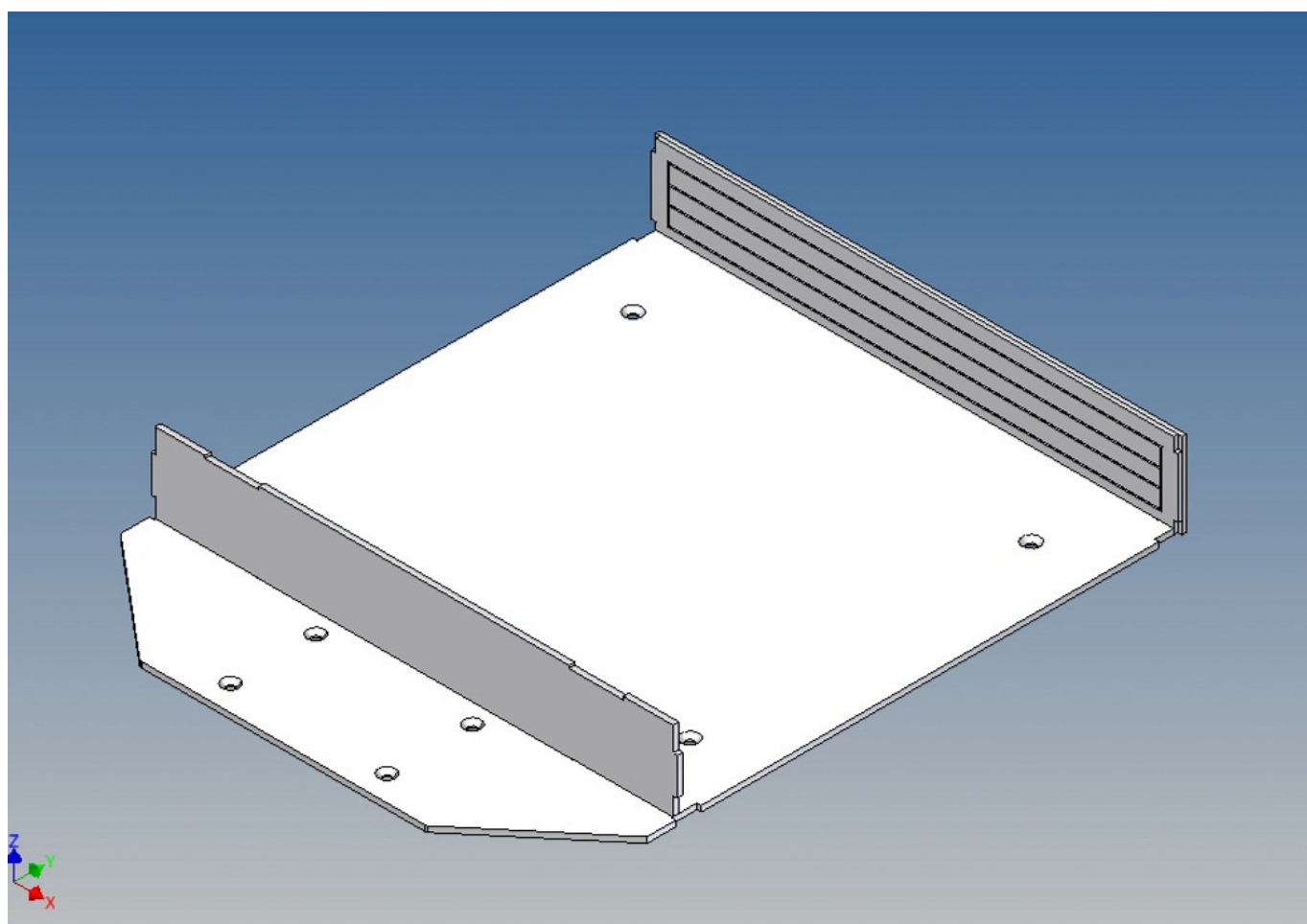
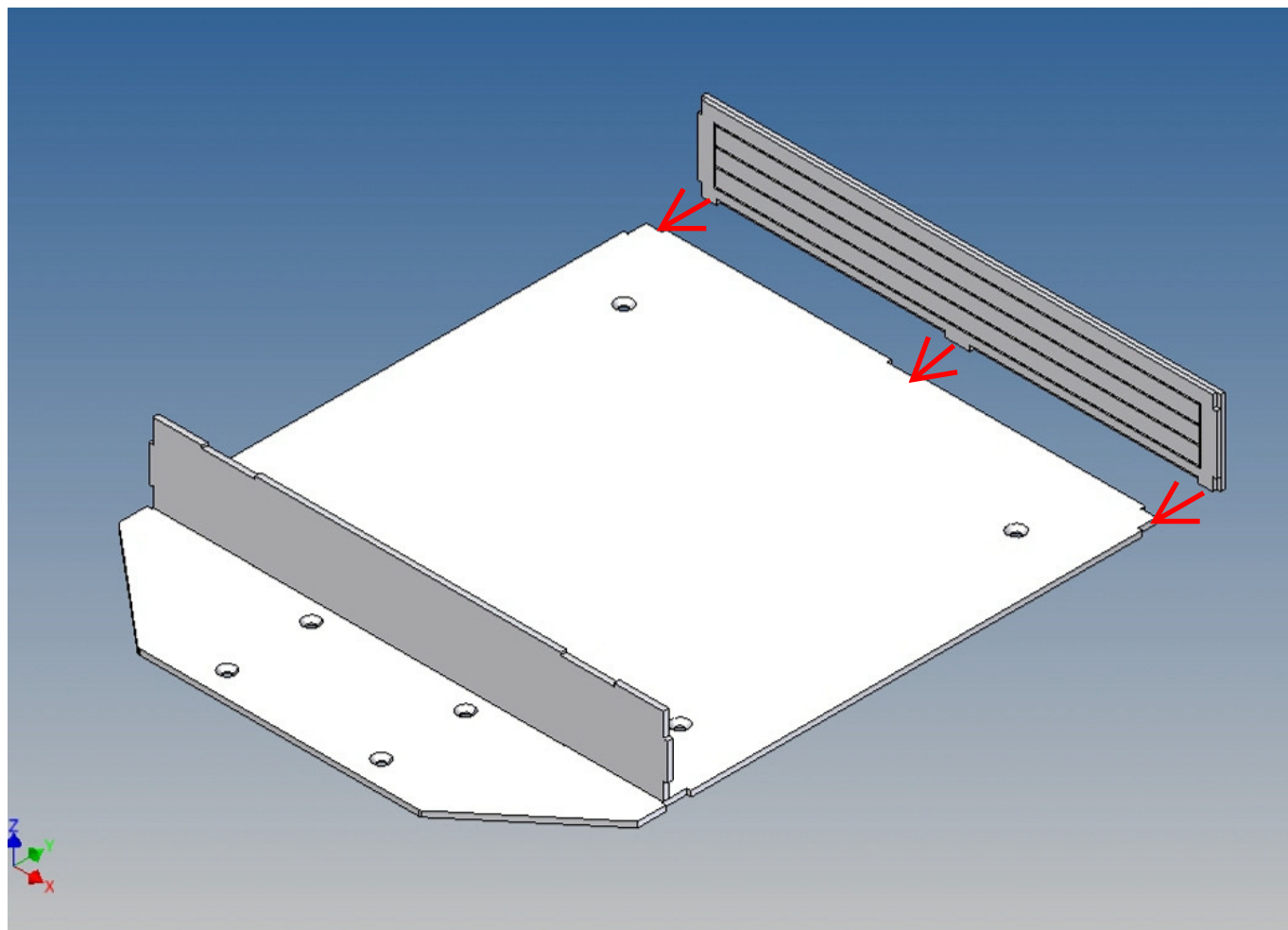

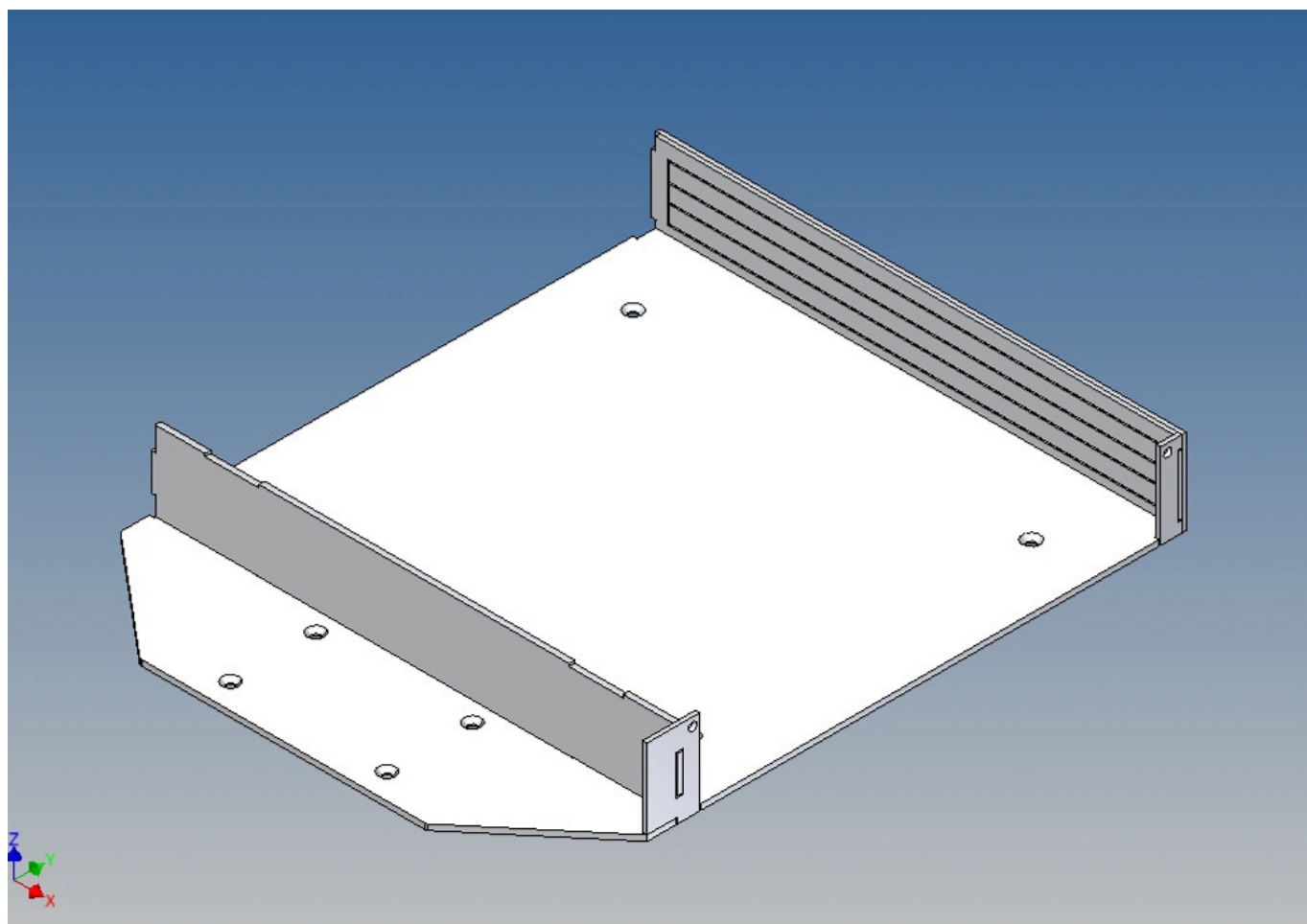
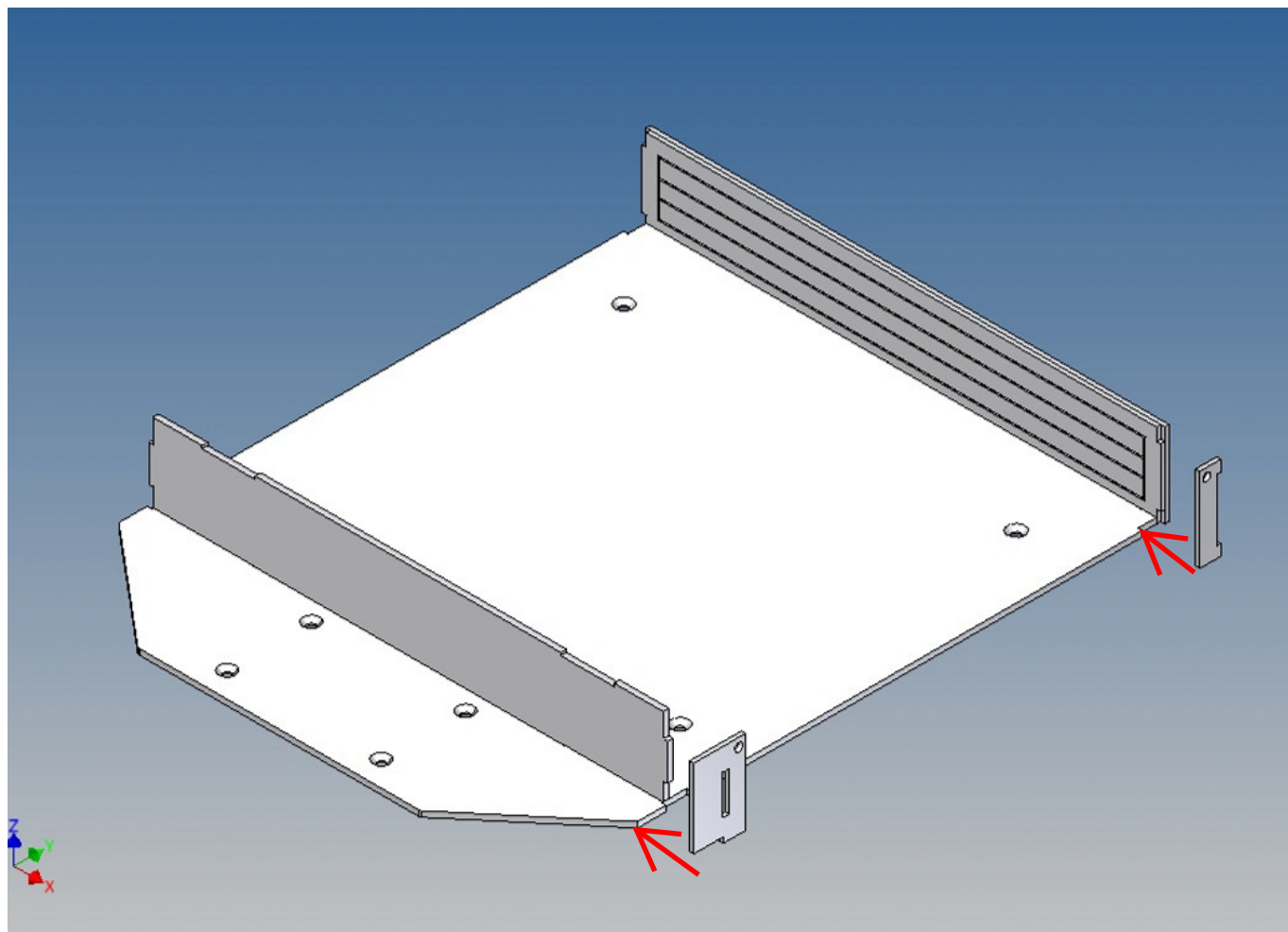

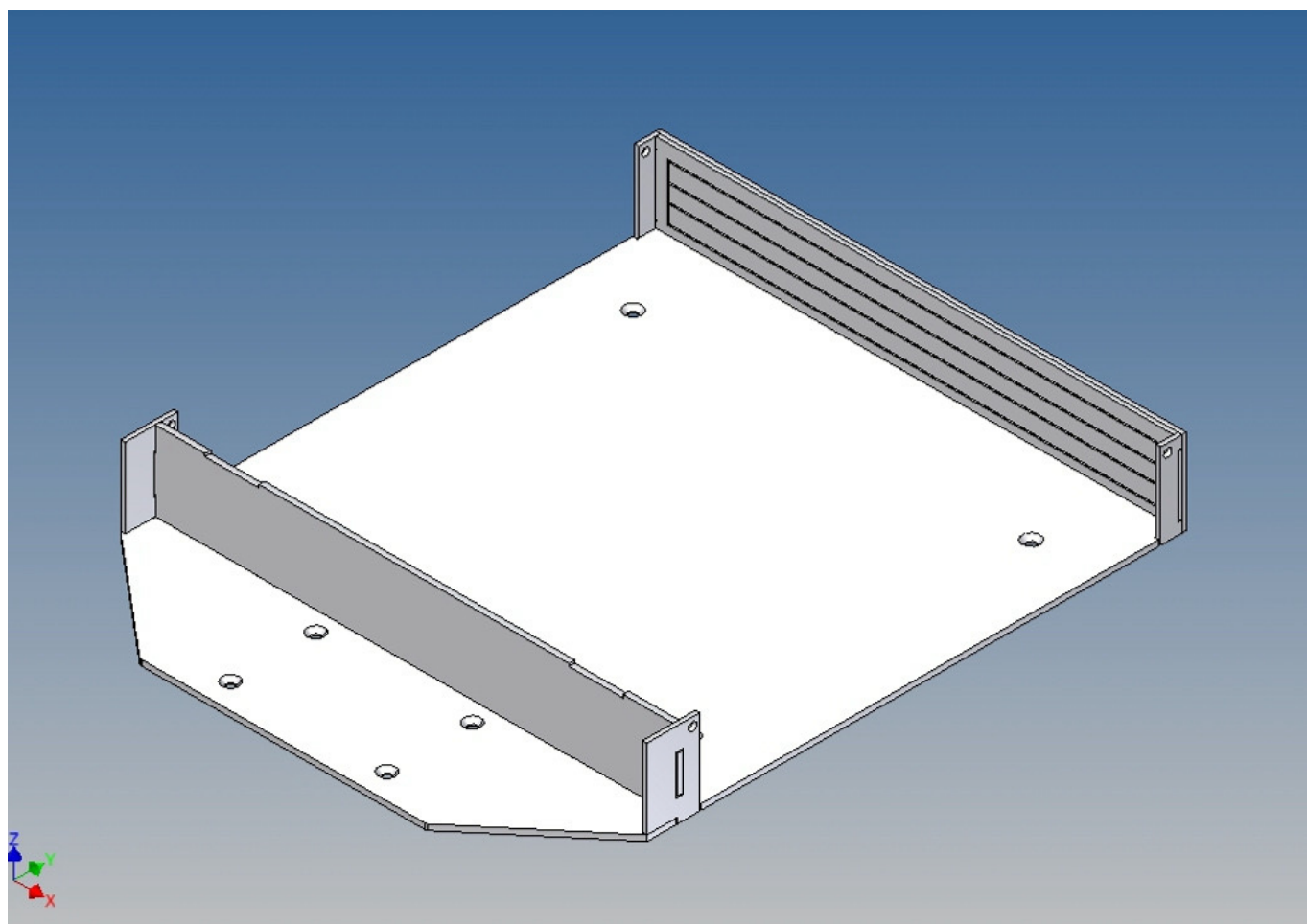
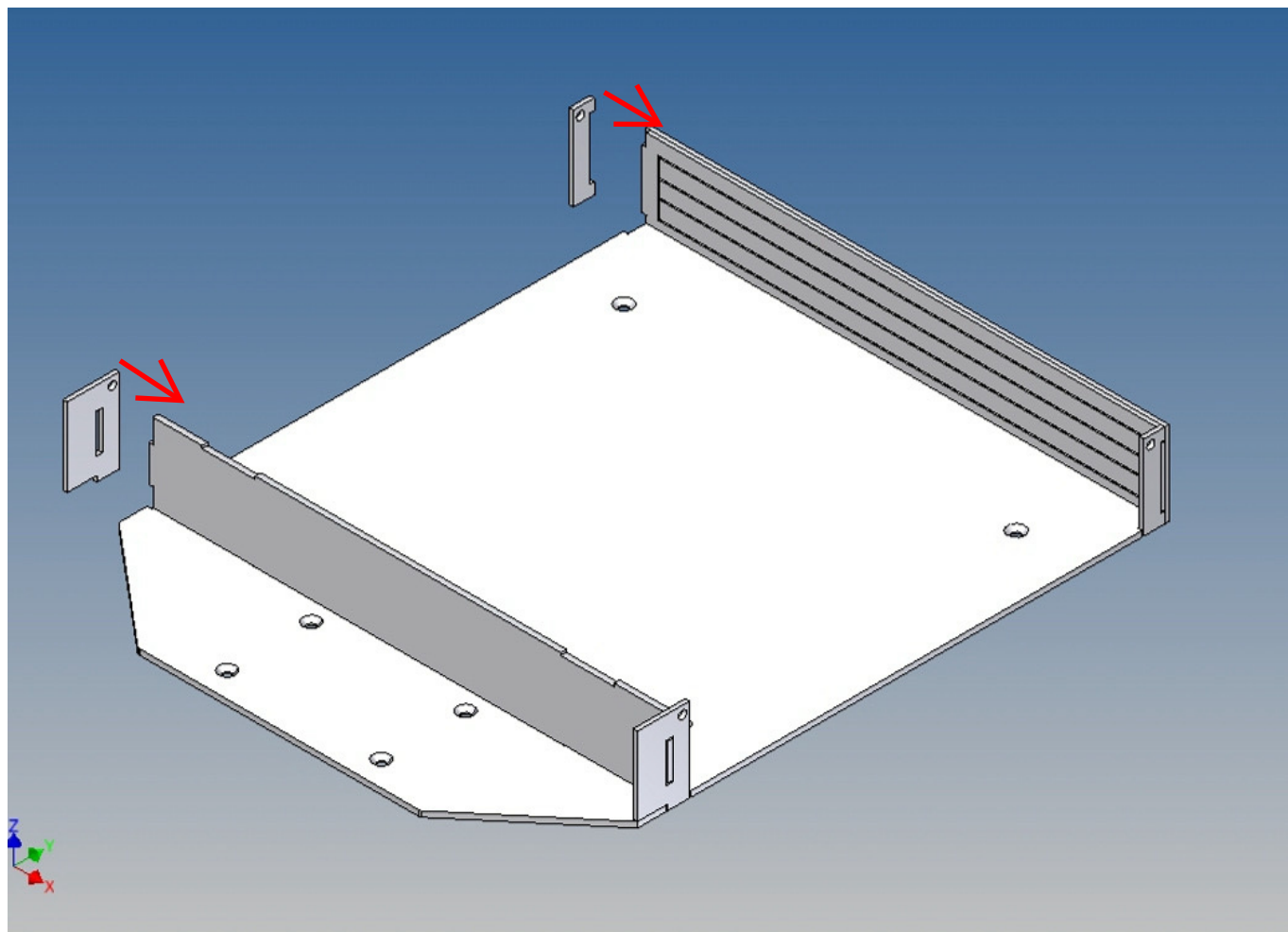

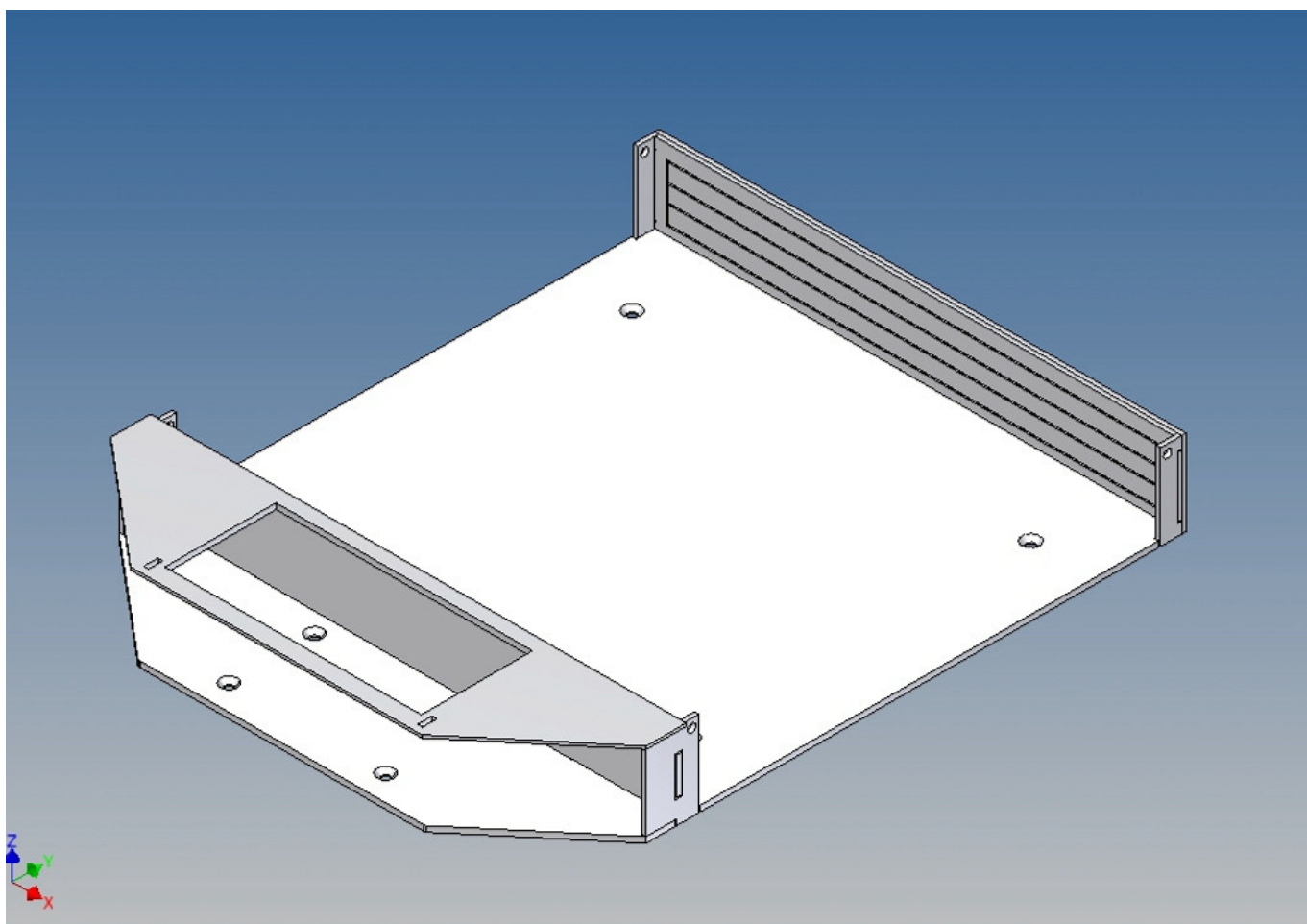
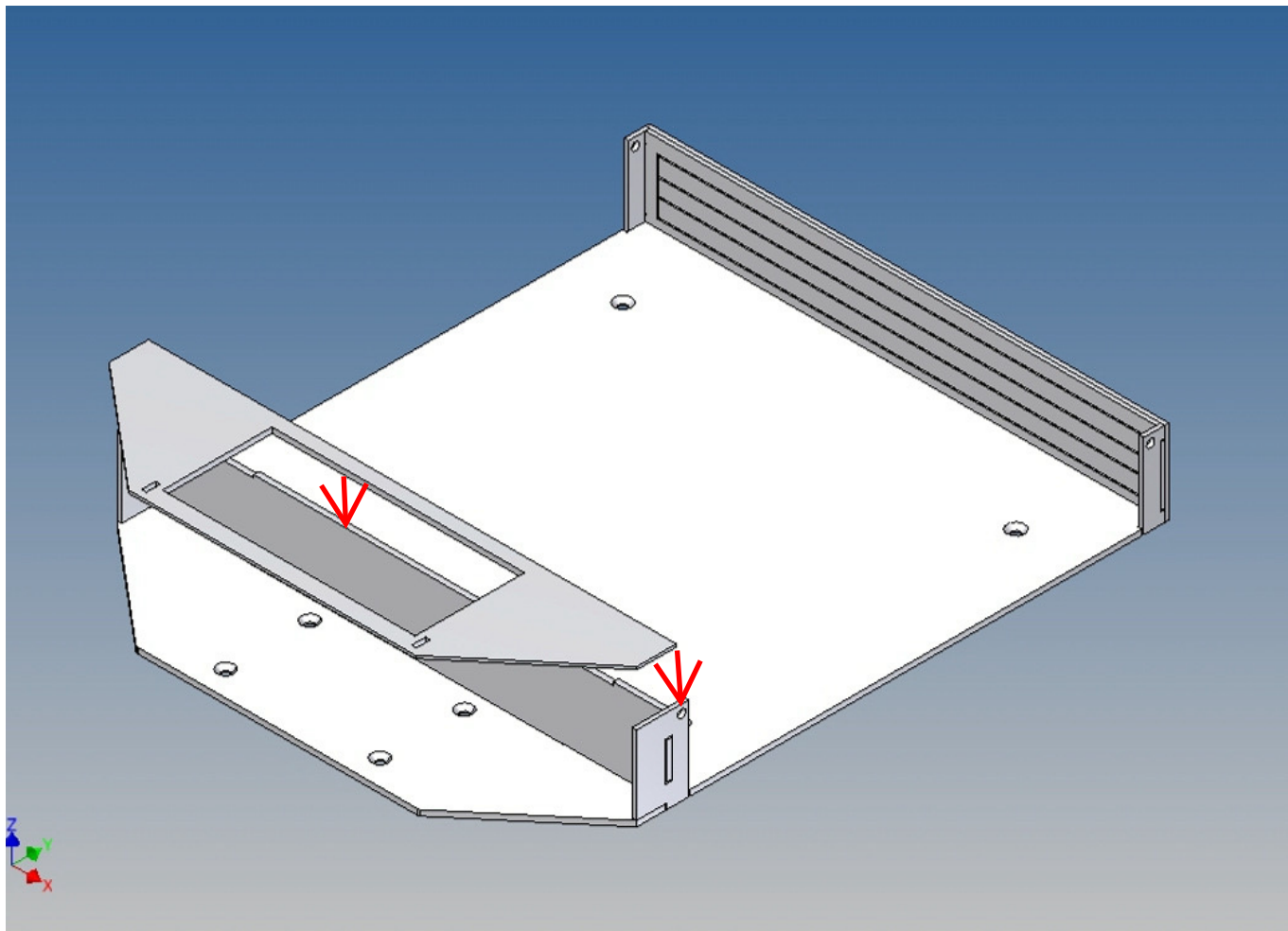



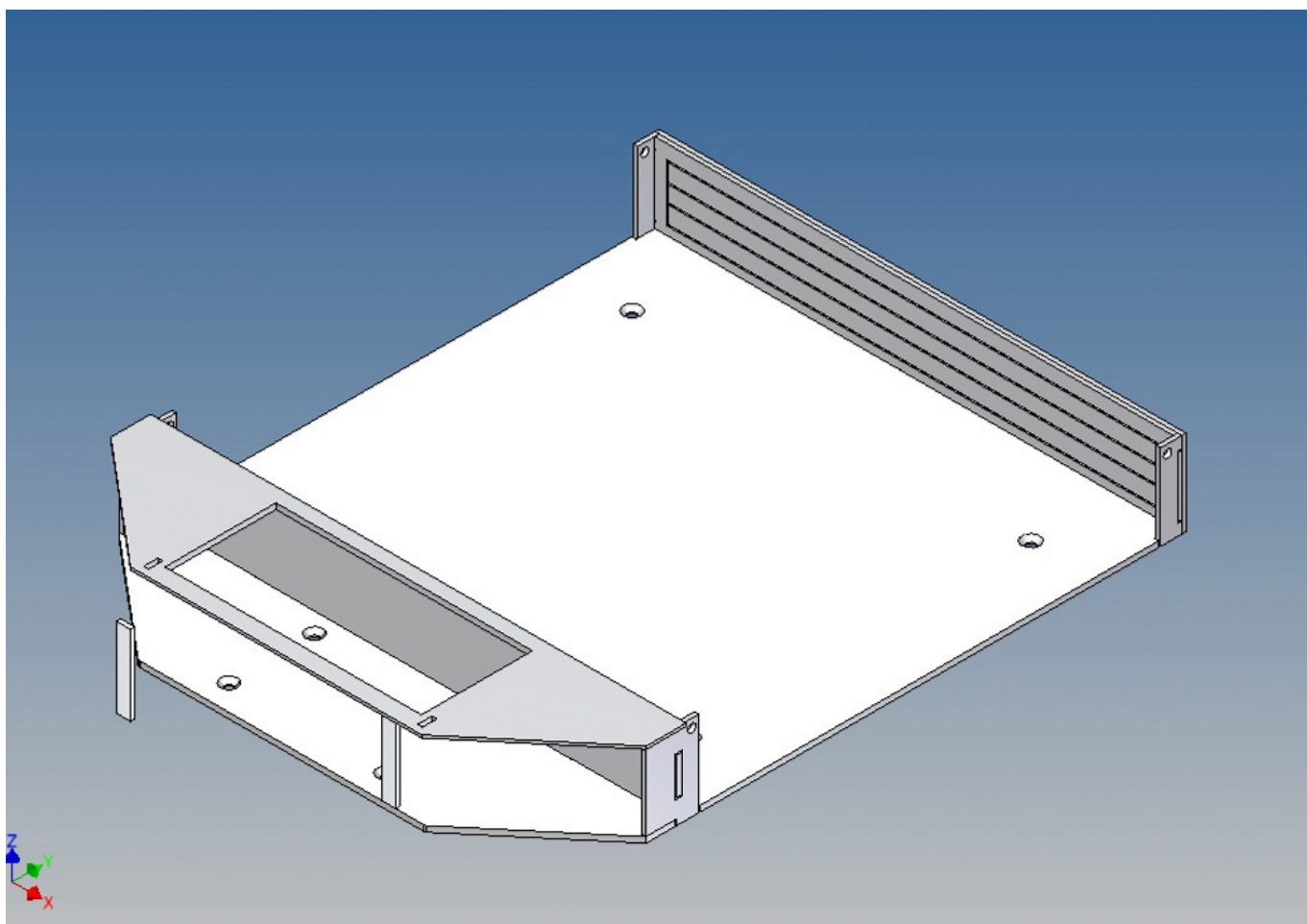
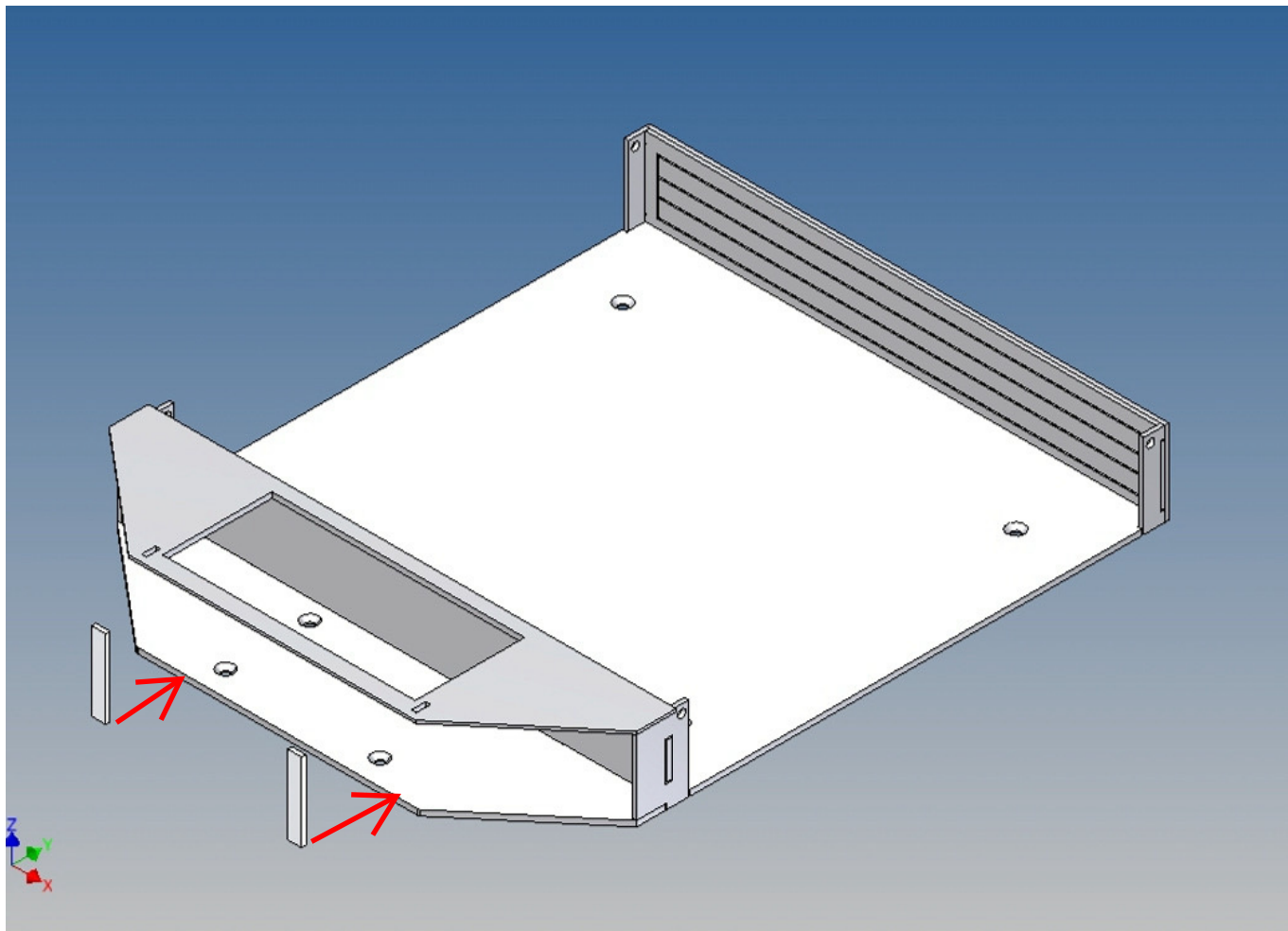

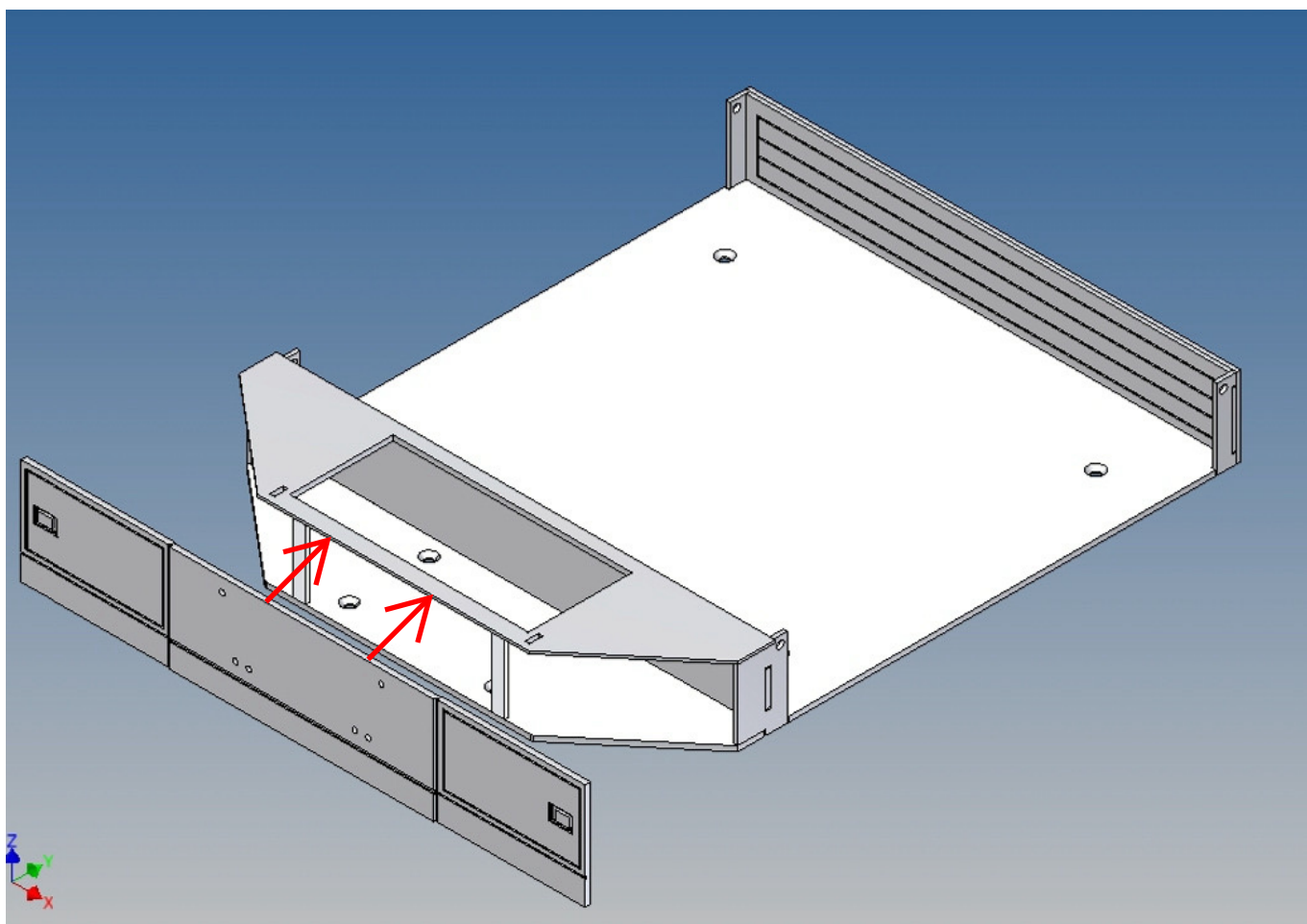
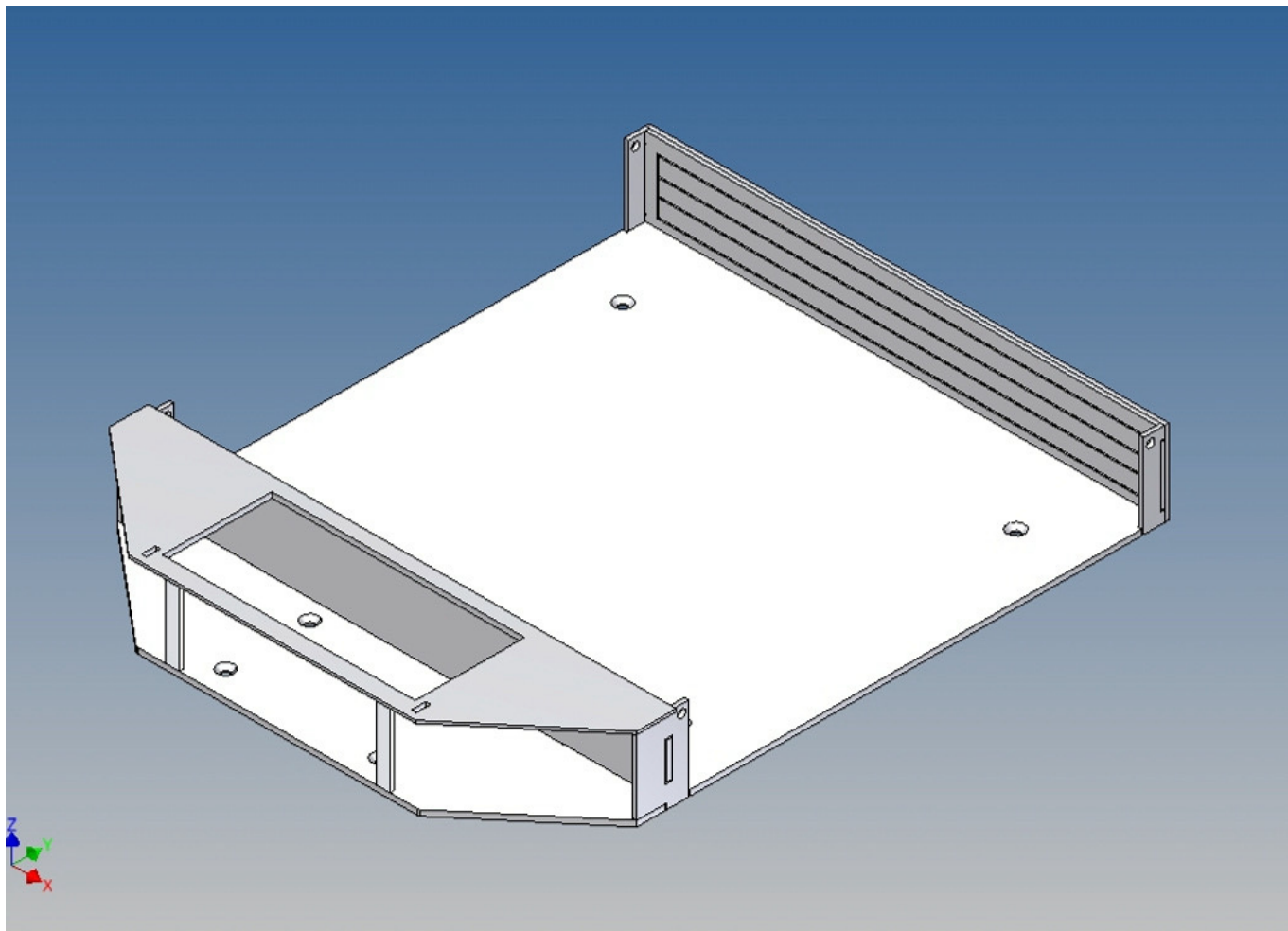

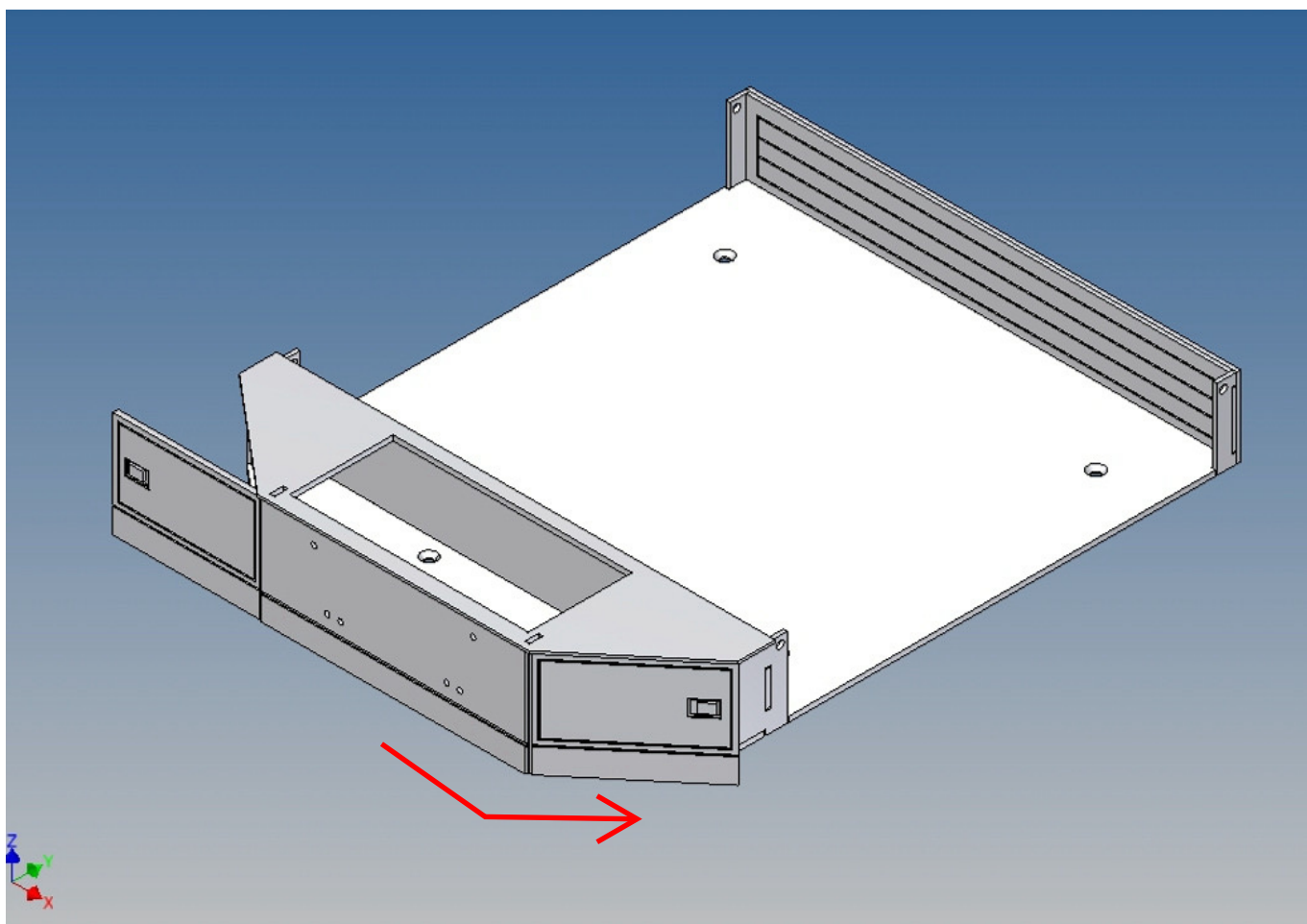
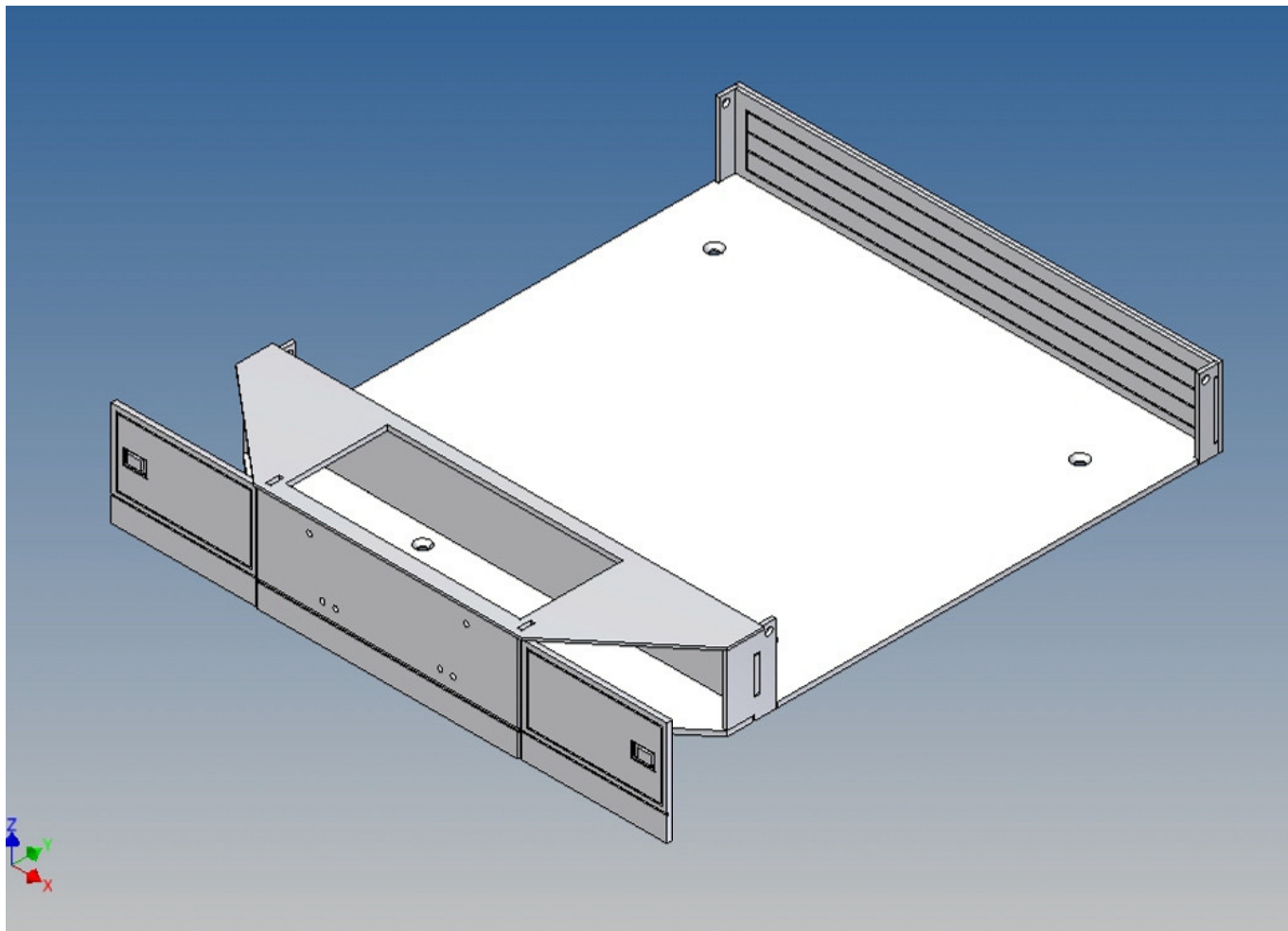

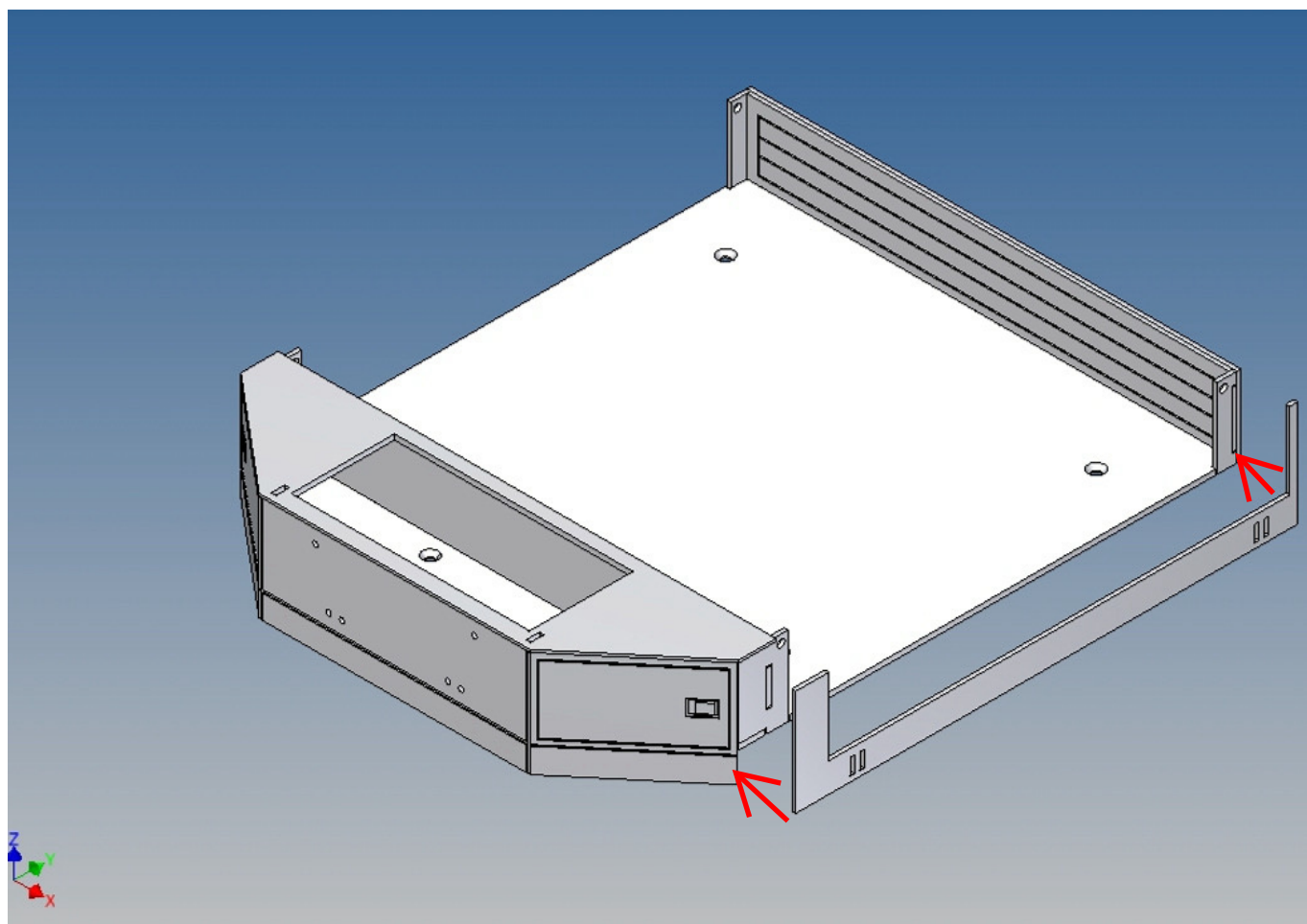
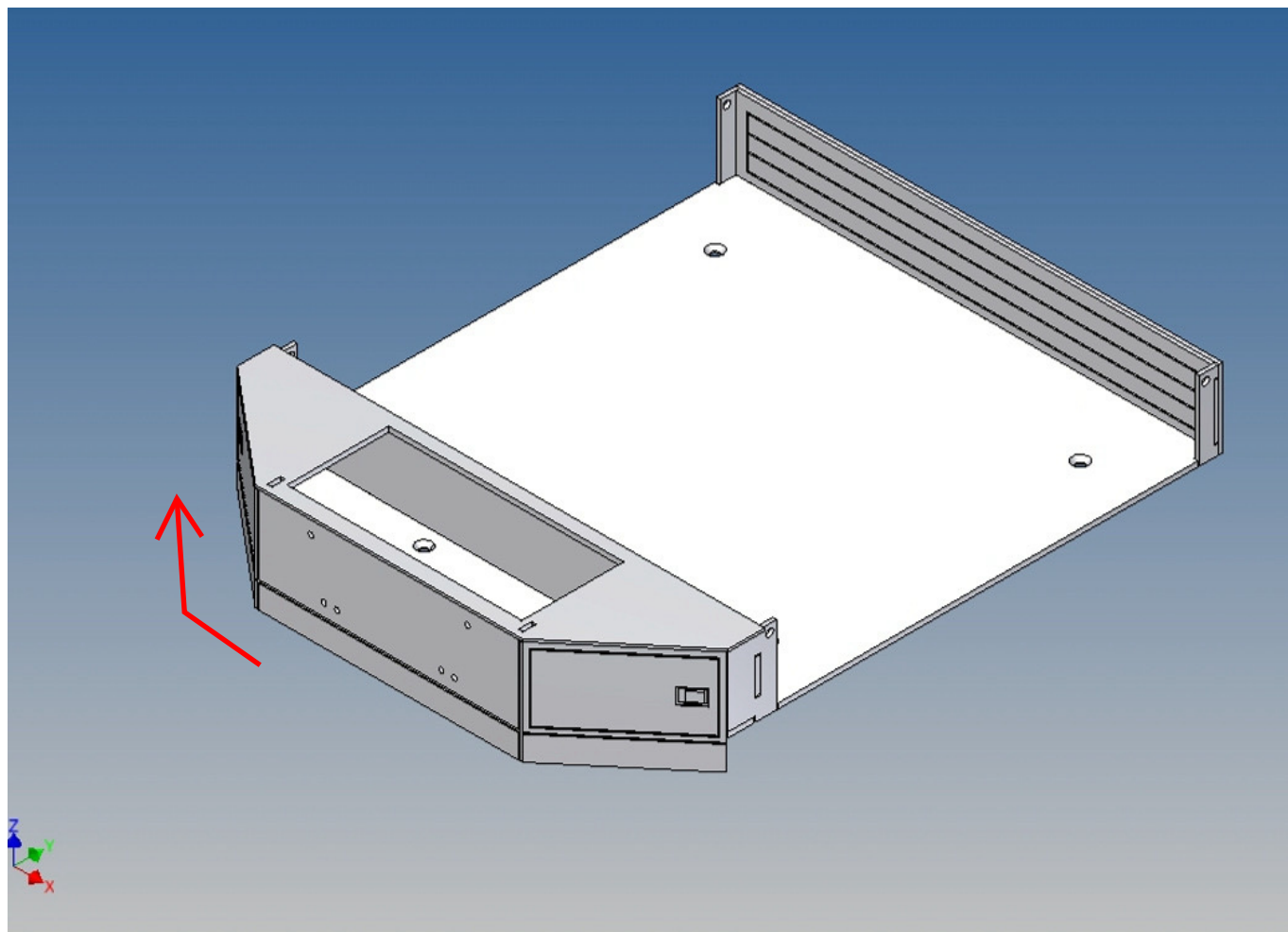



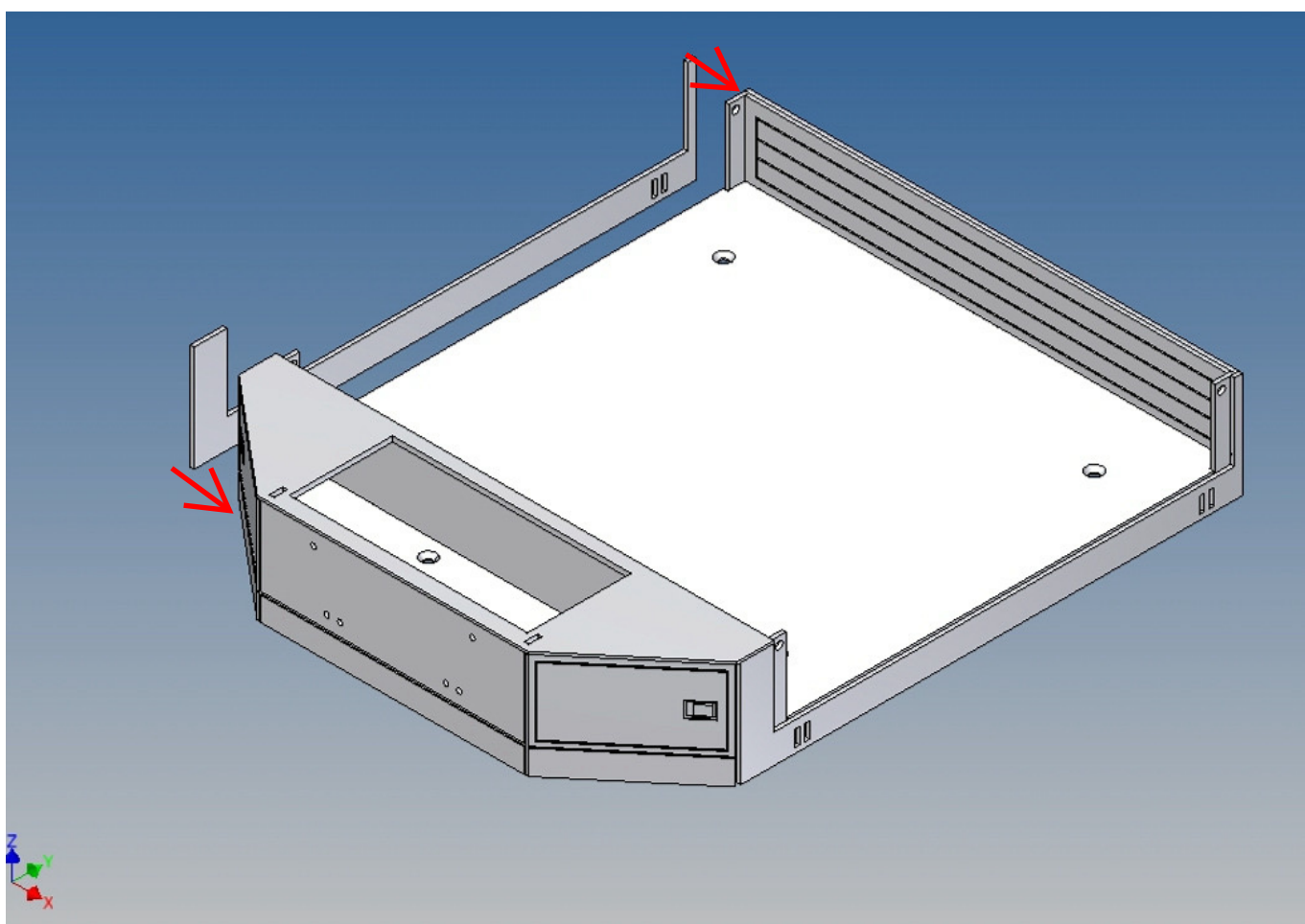
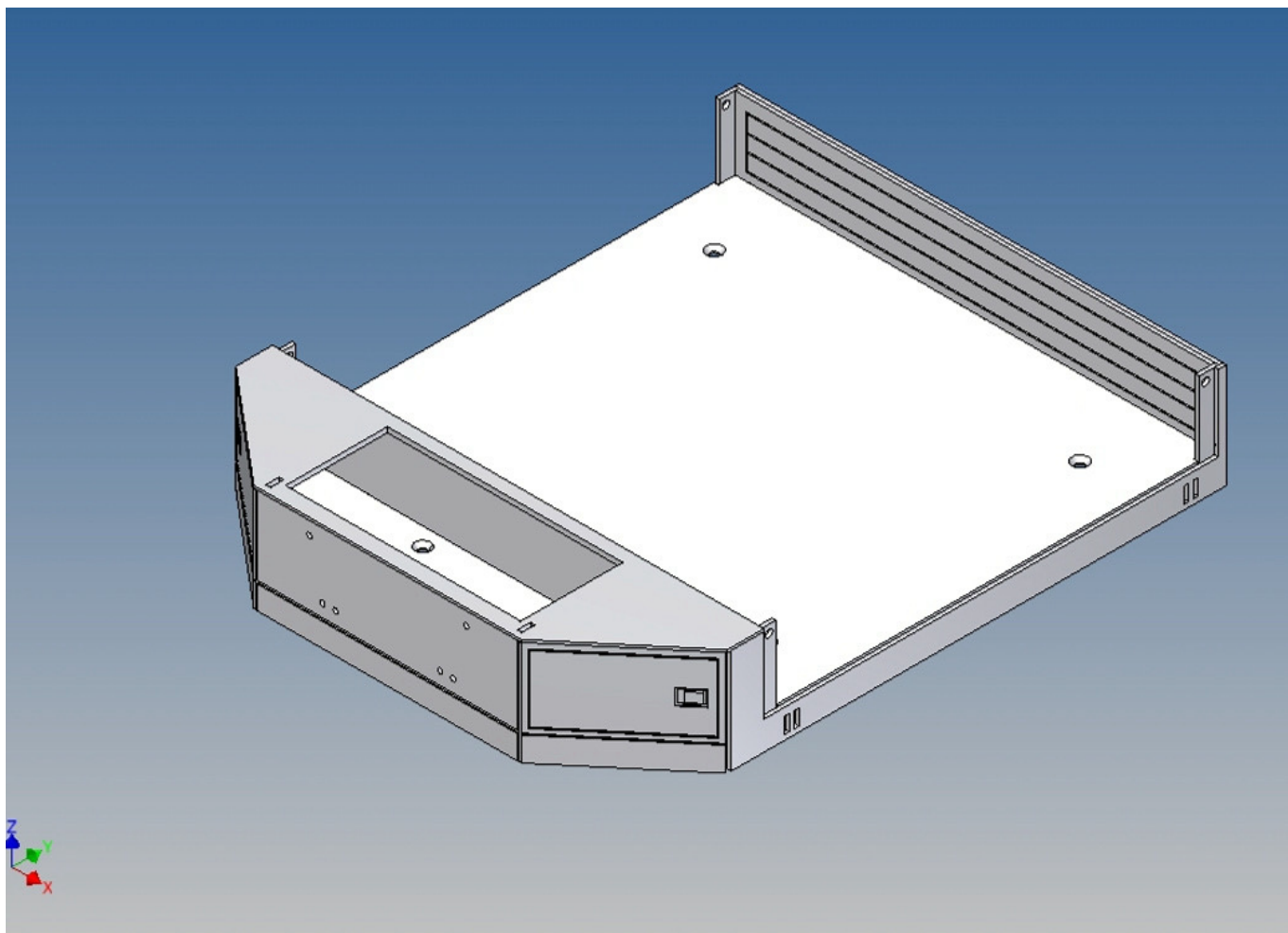

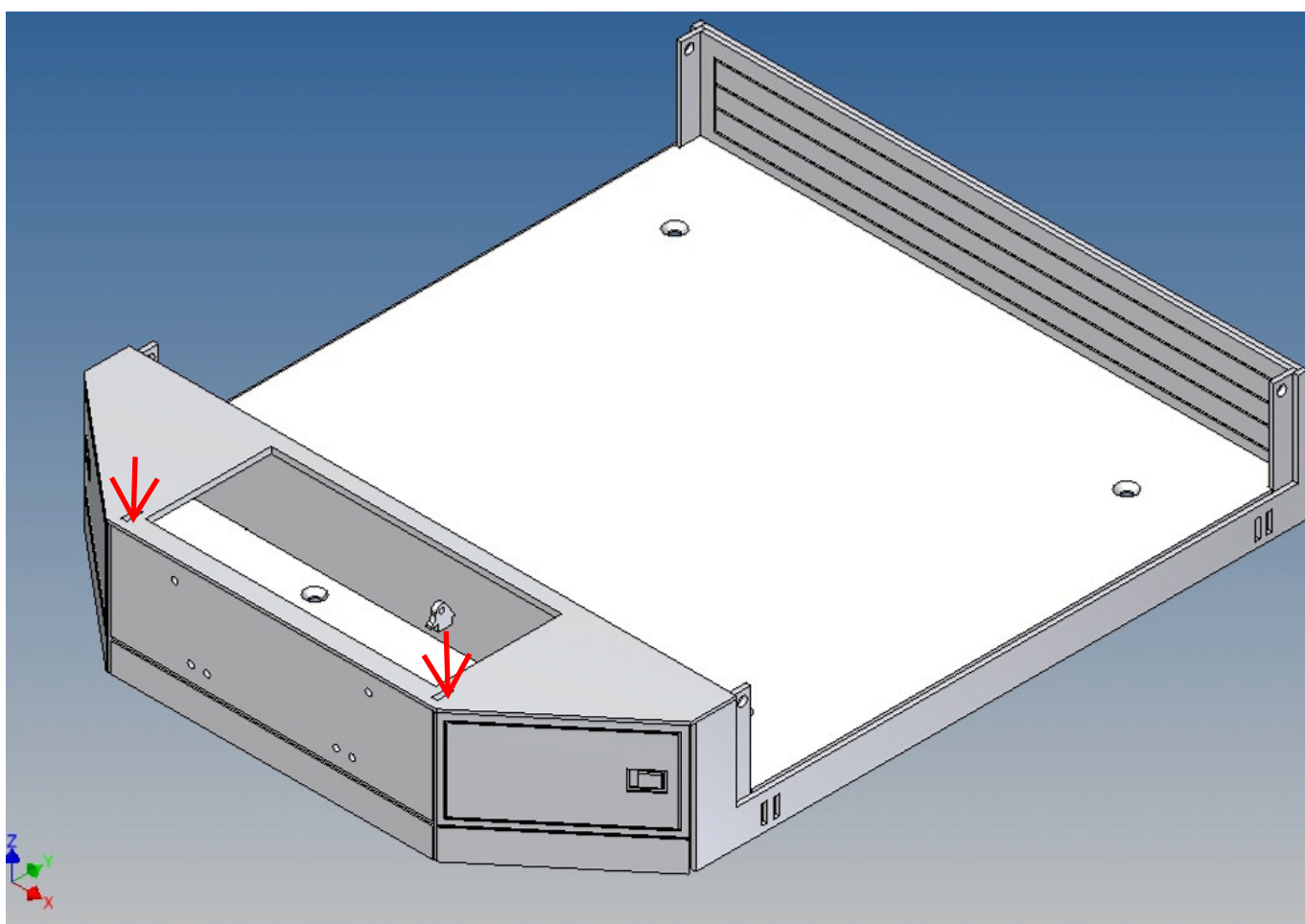
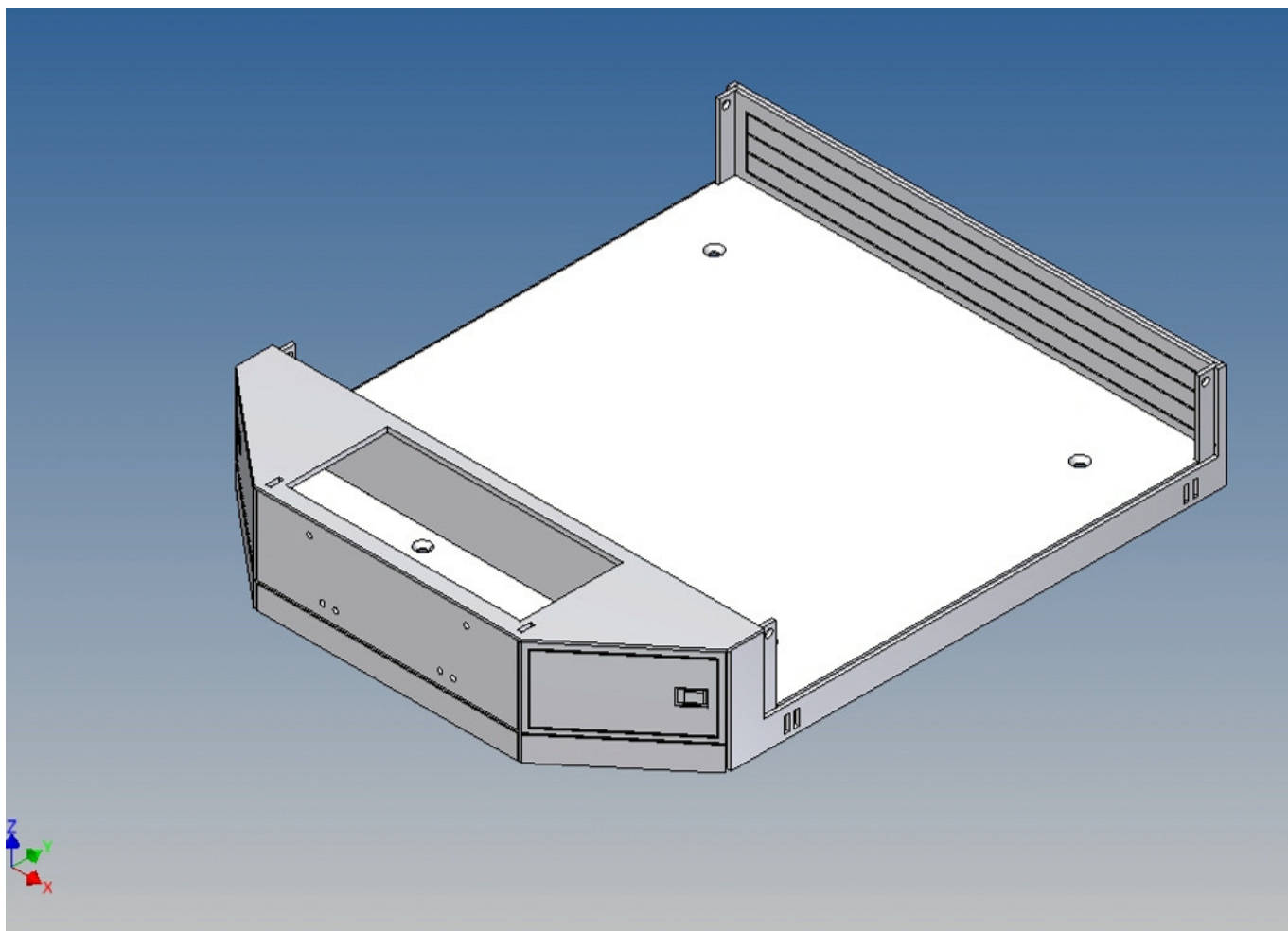

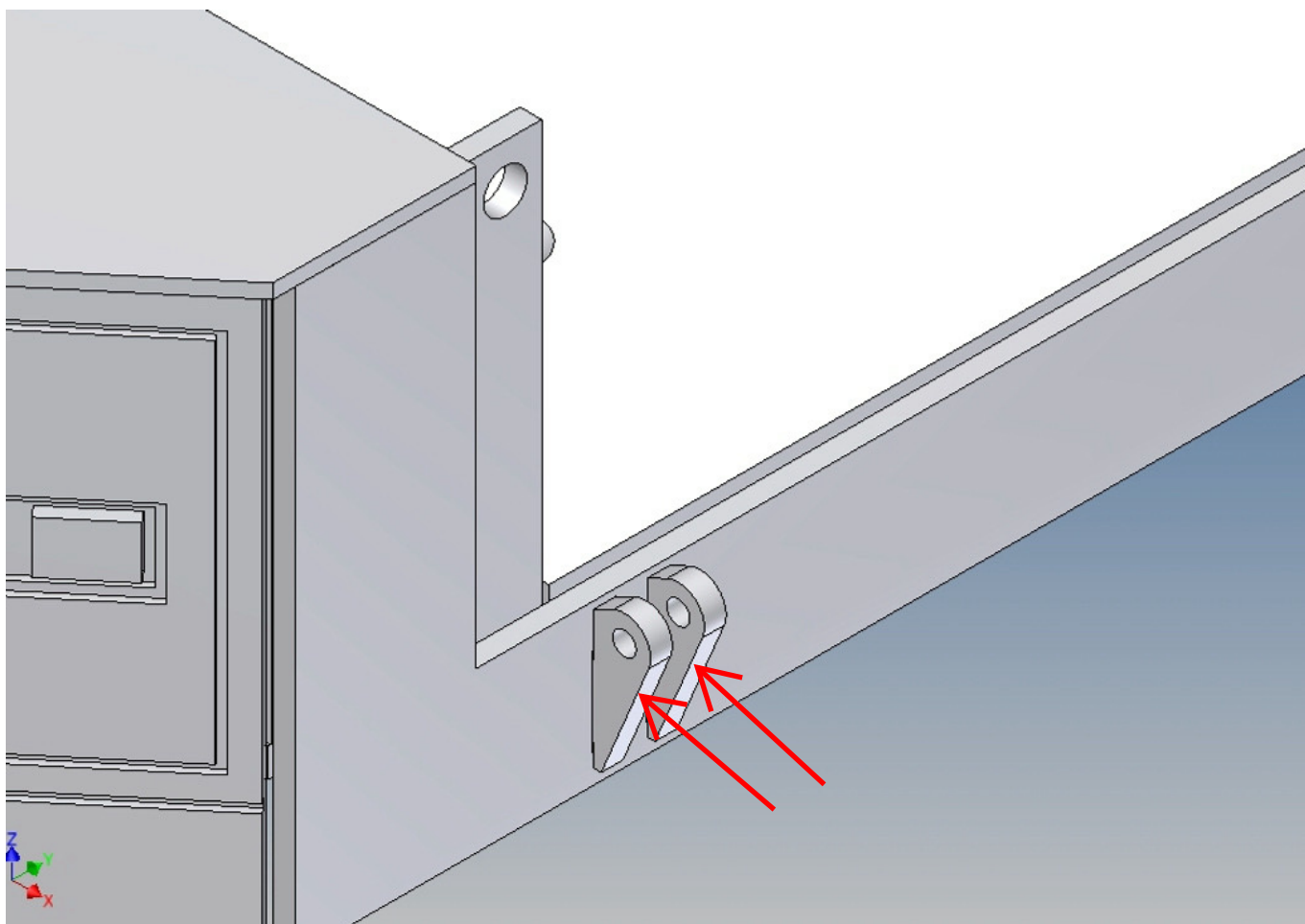
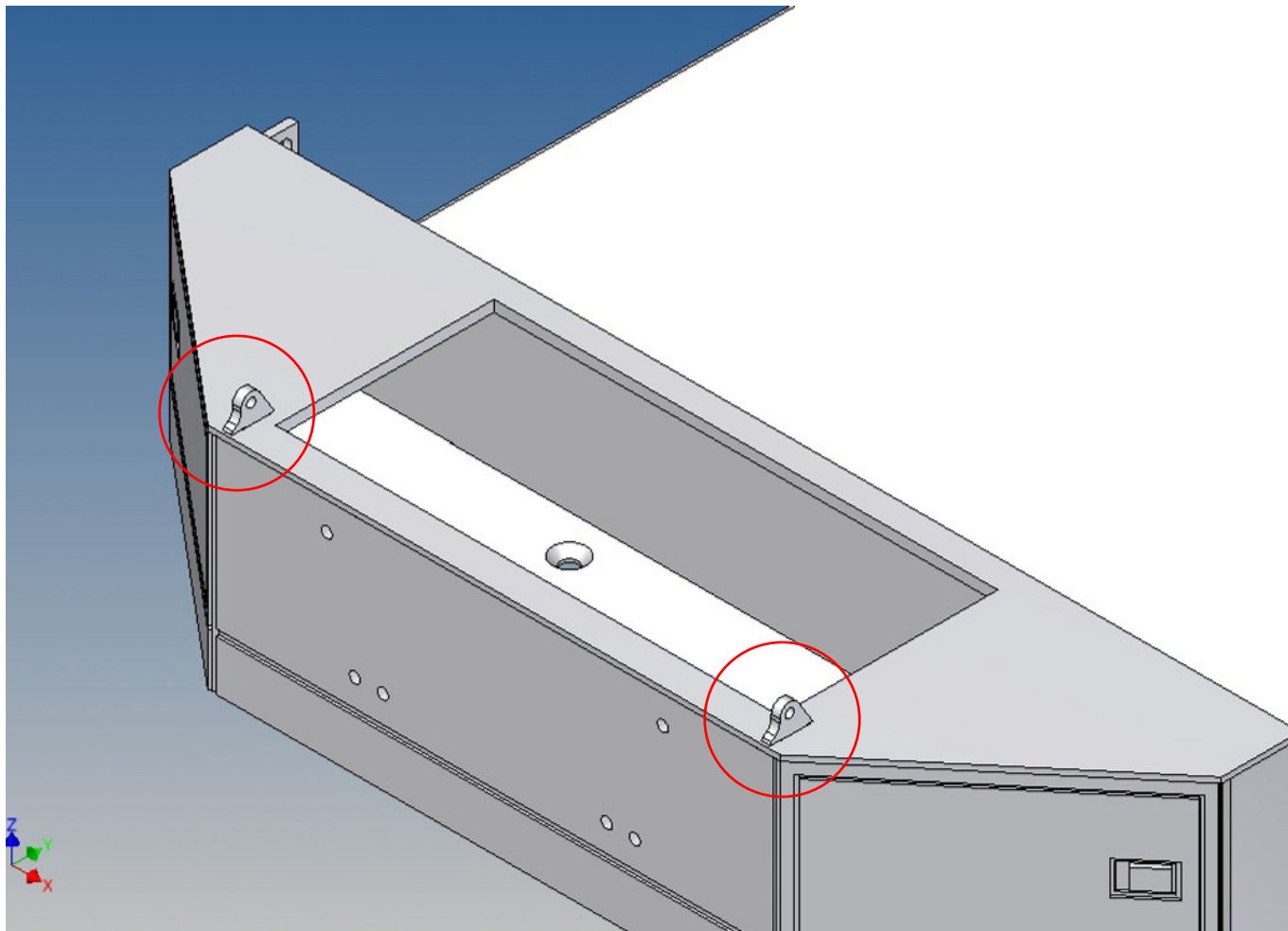

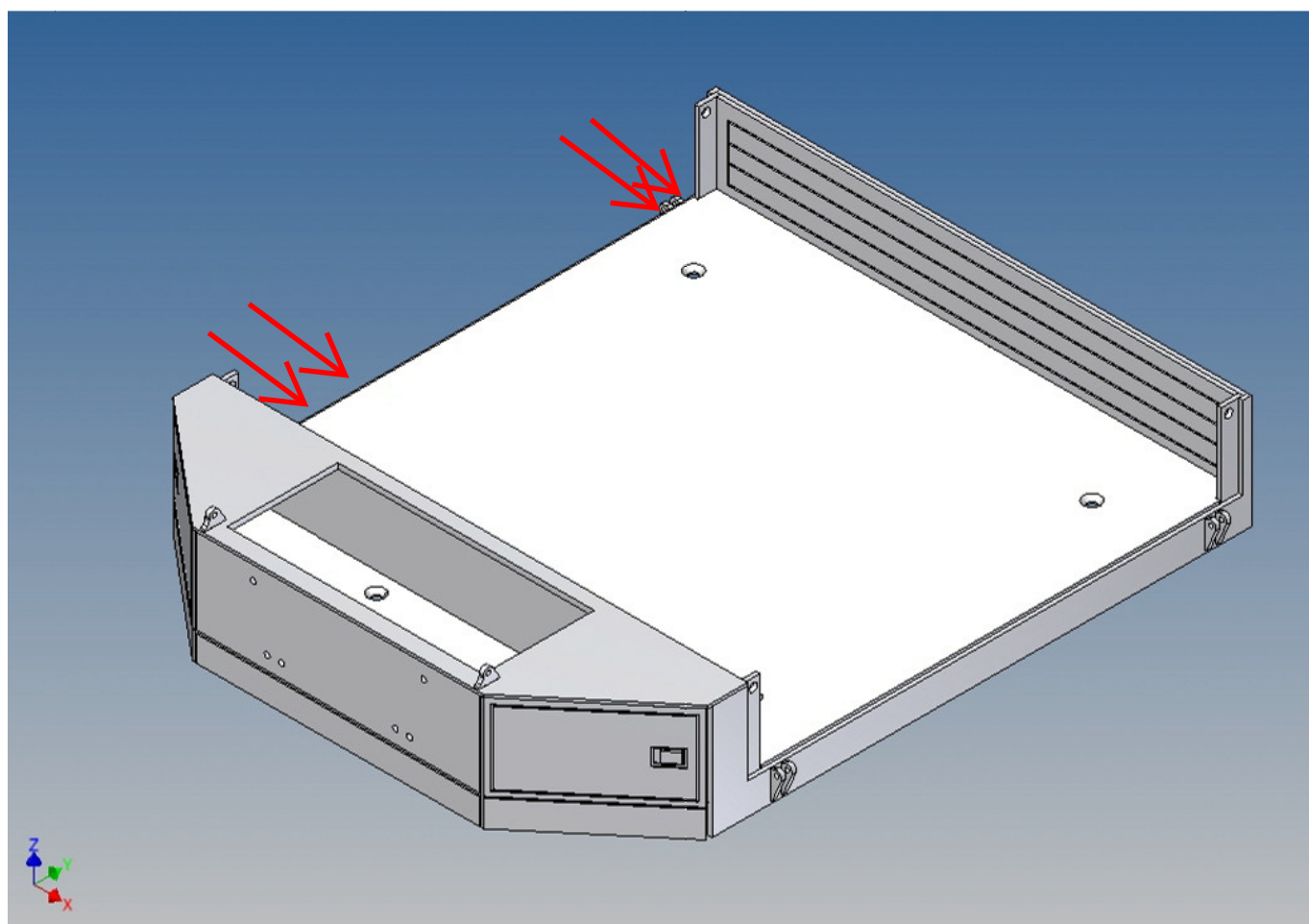
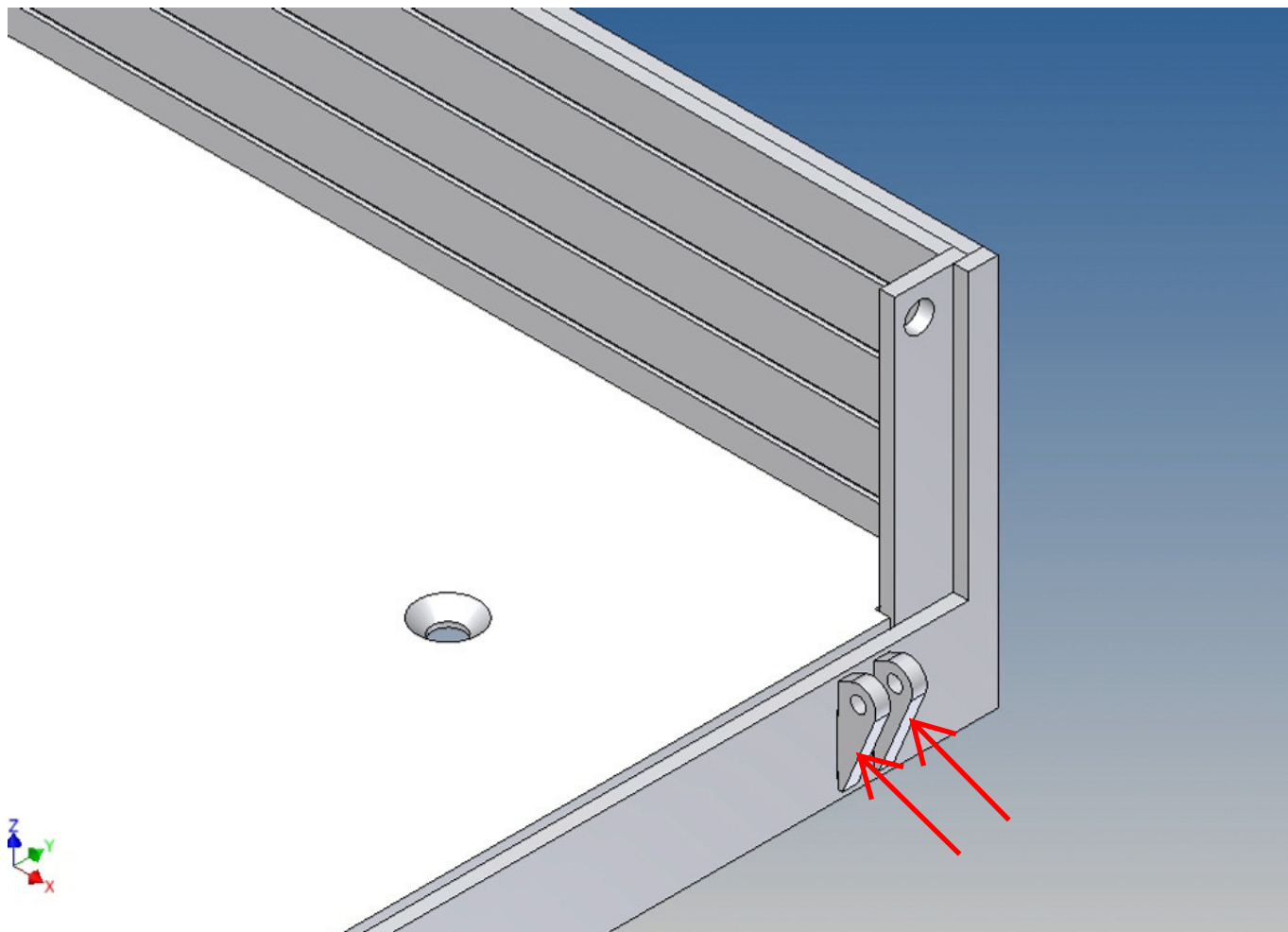



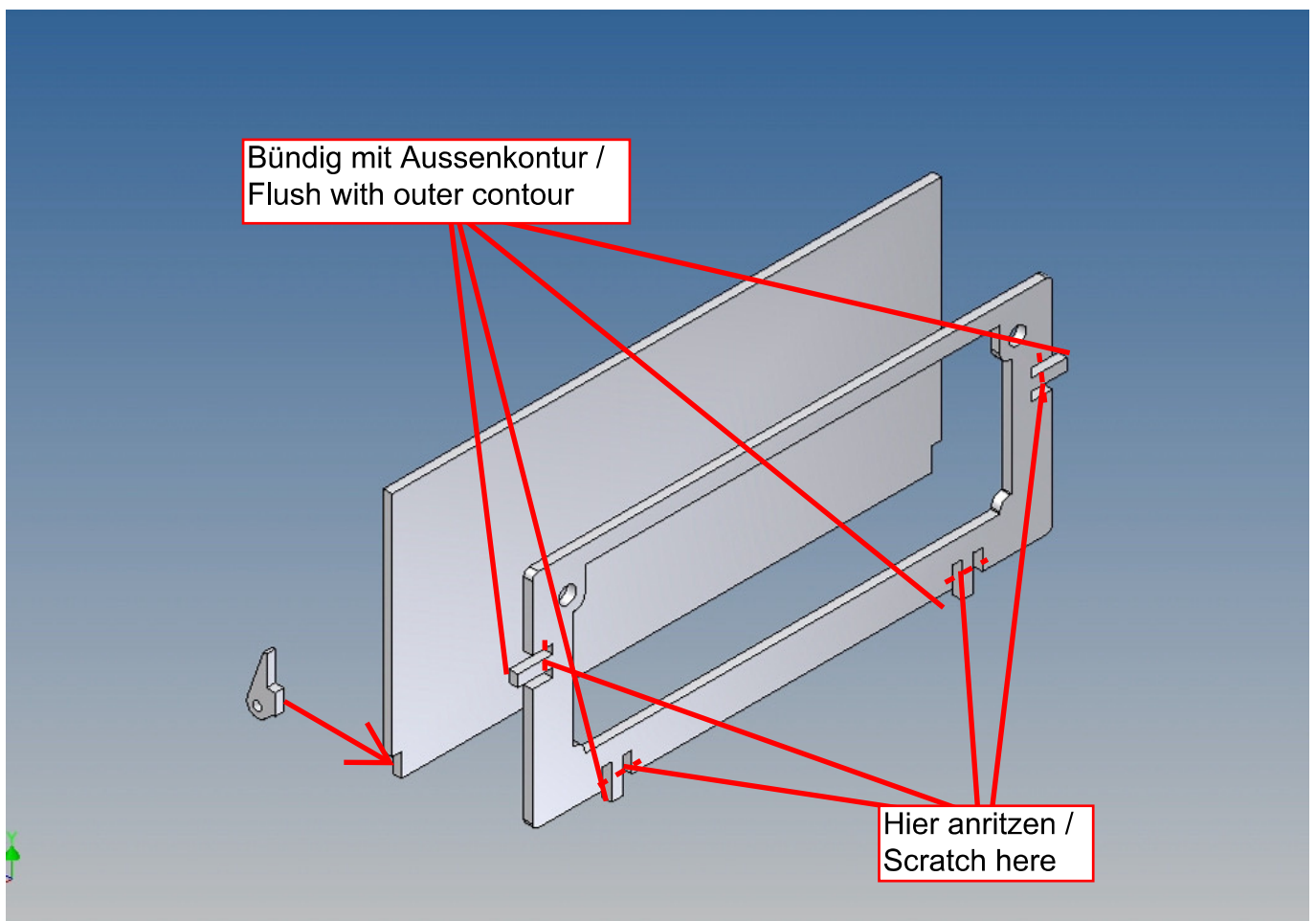
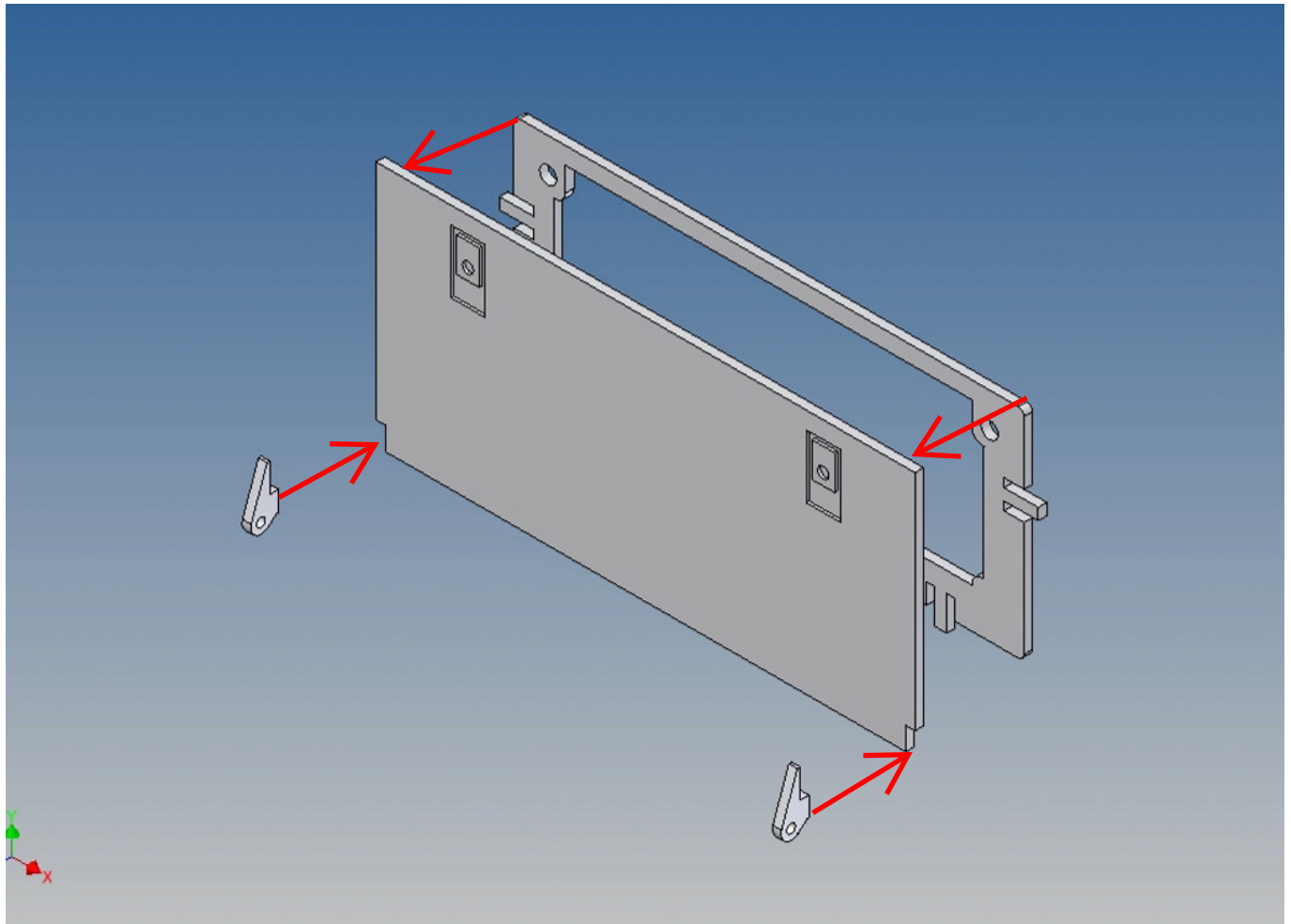

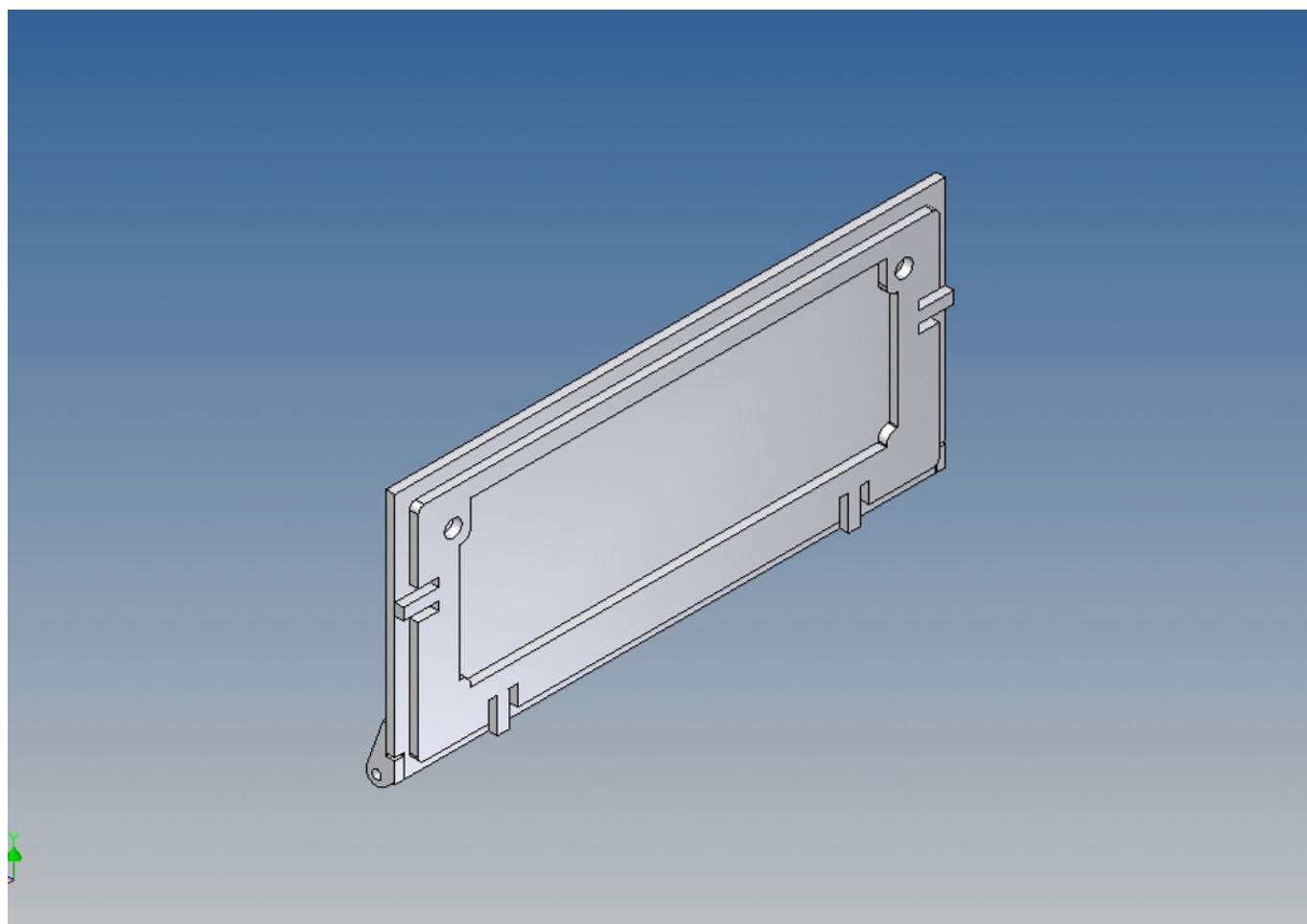
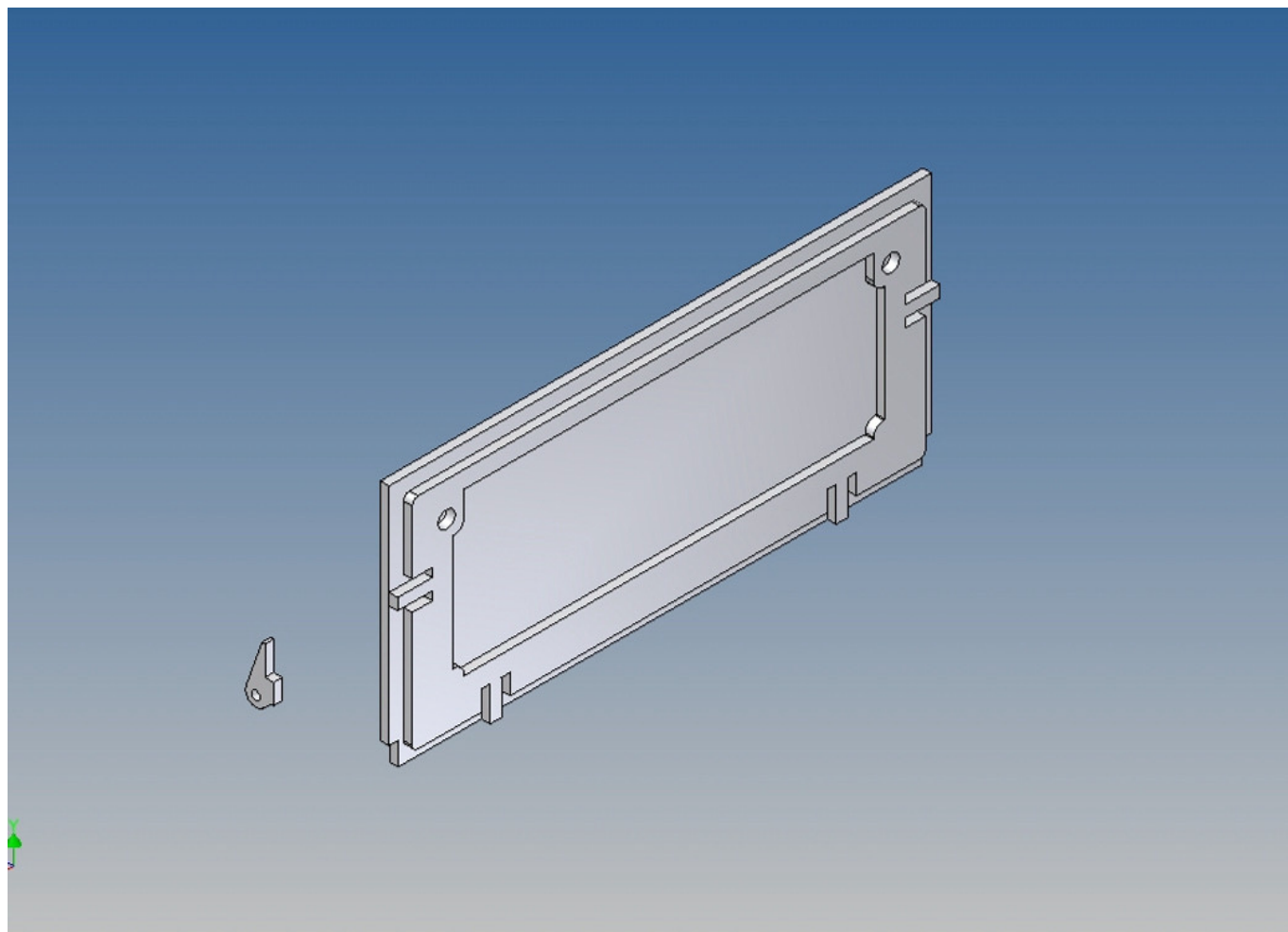

Nach dem verkleben, abtrennen /  
After gluing, detach

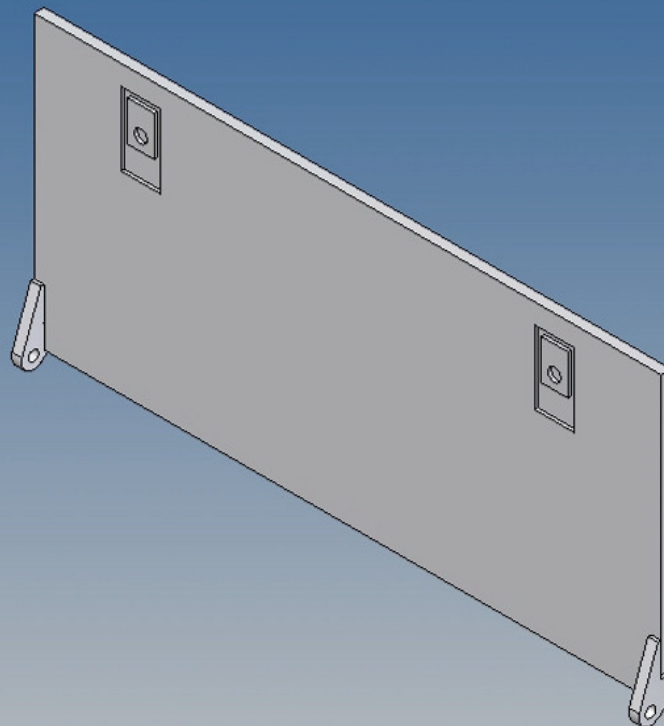
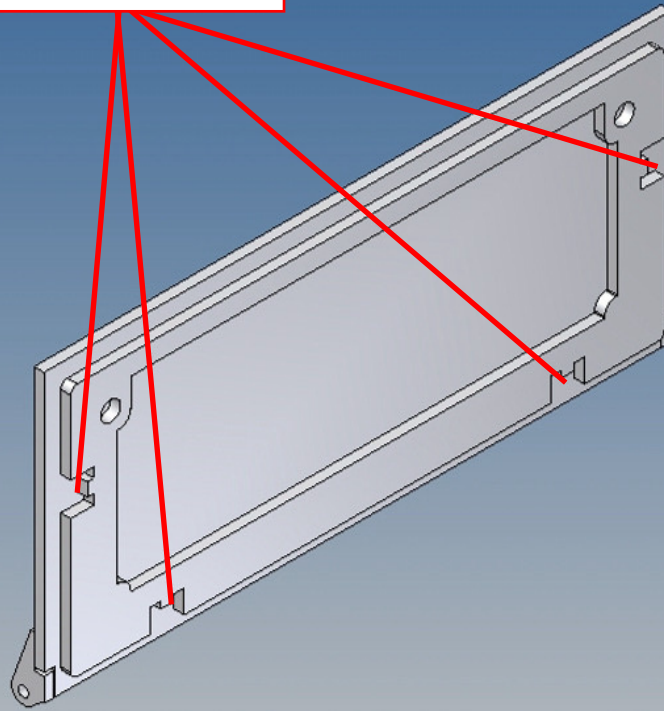

Seitenklappen (2x) /  
Side flaps (2x)

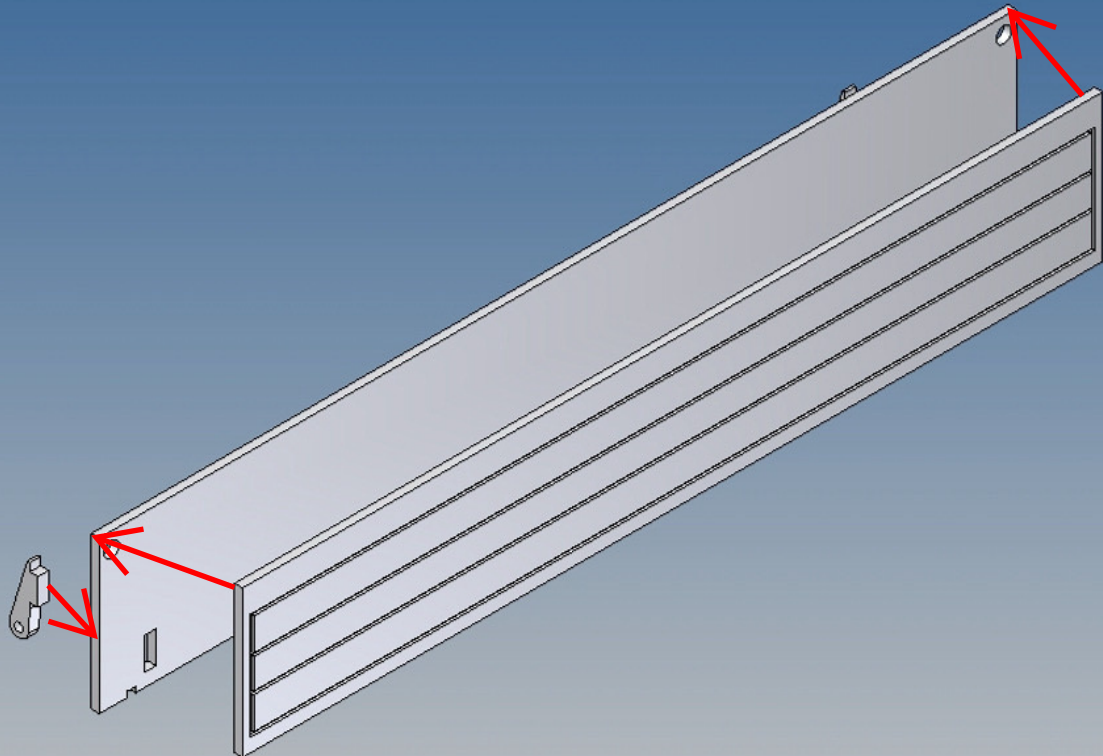
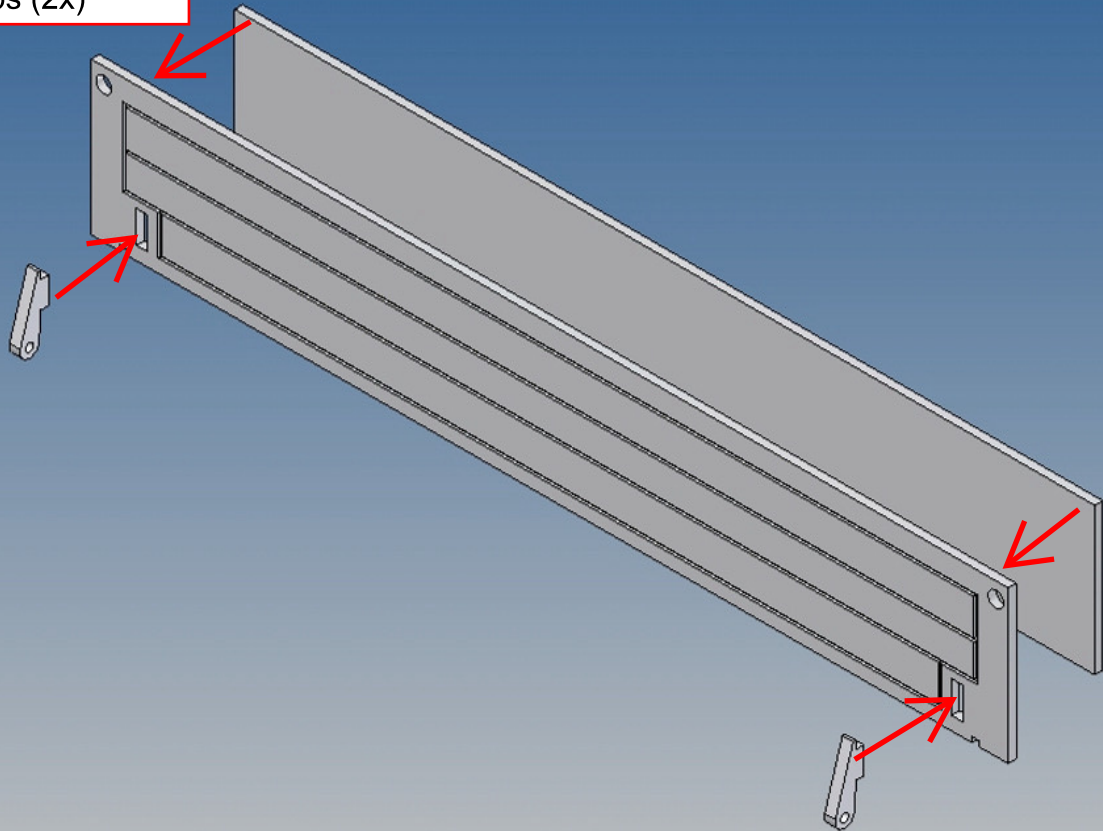



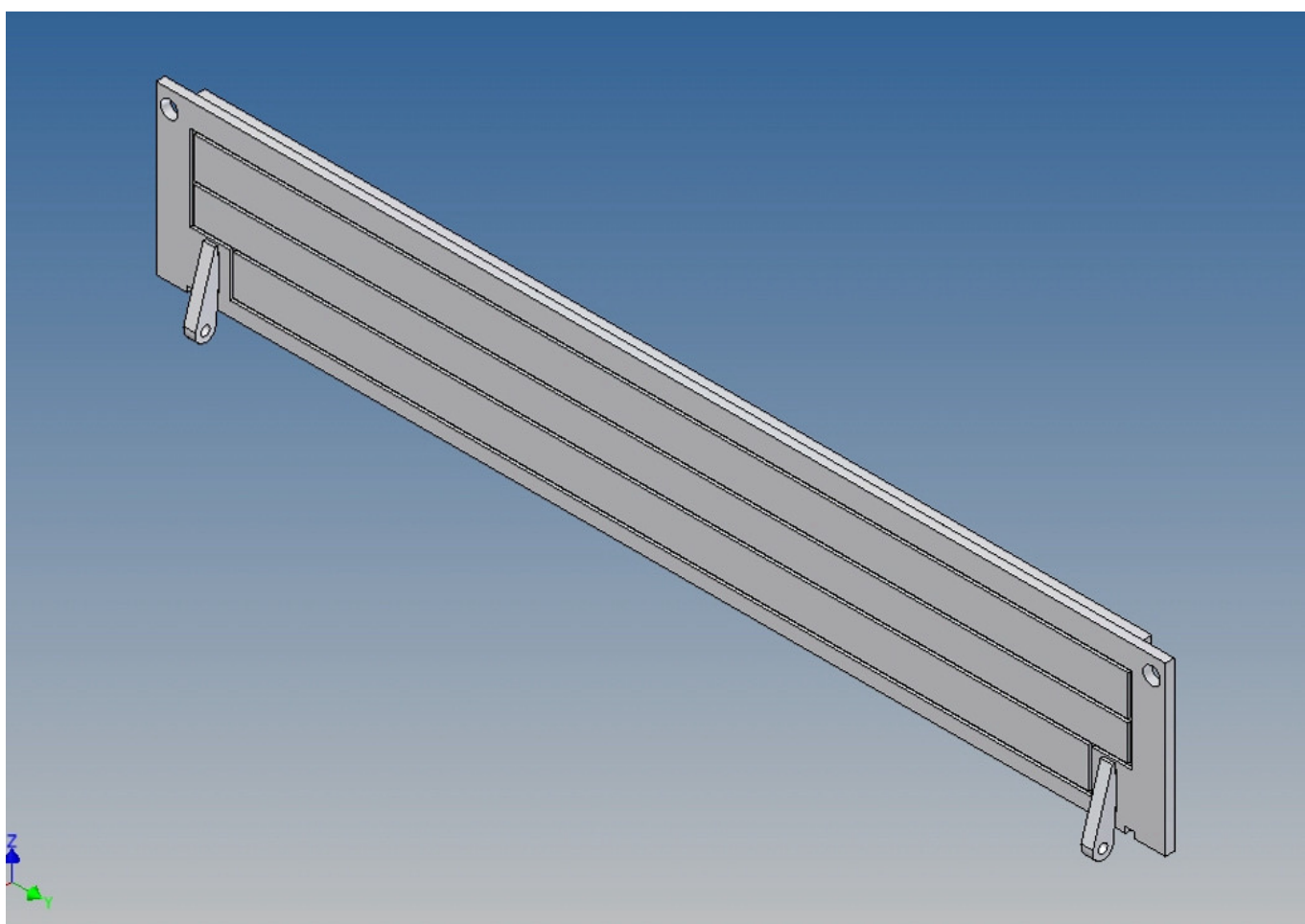
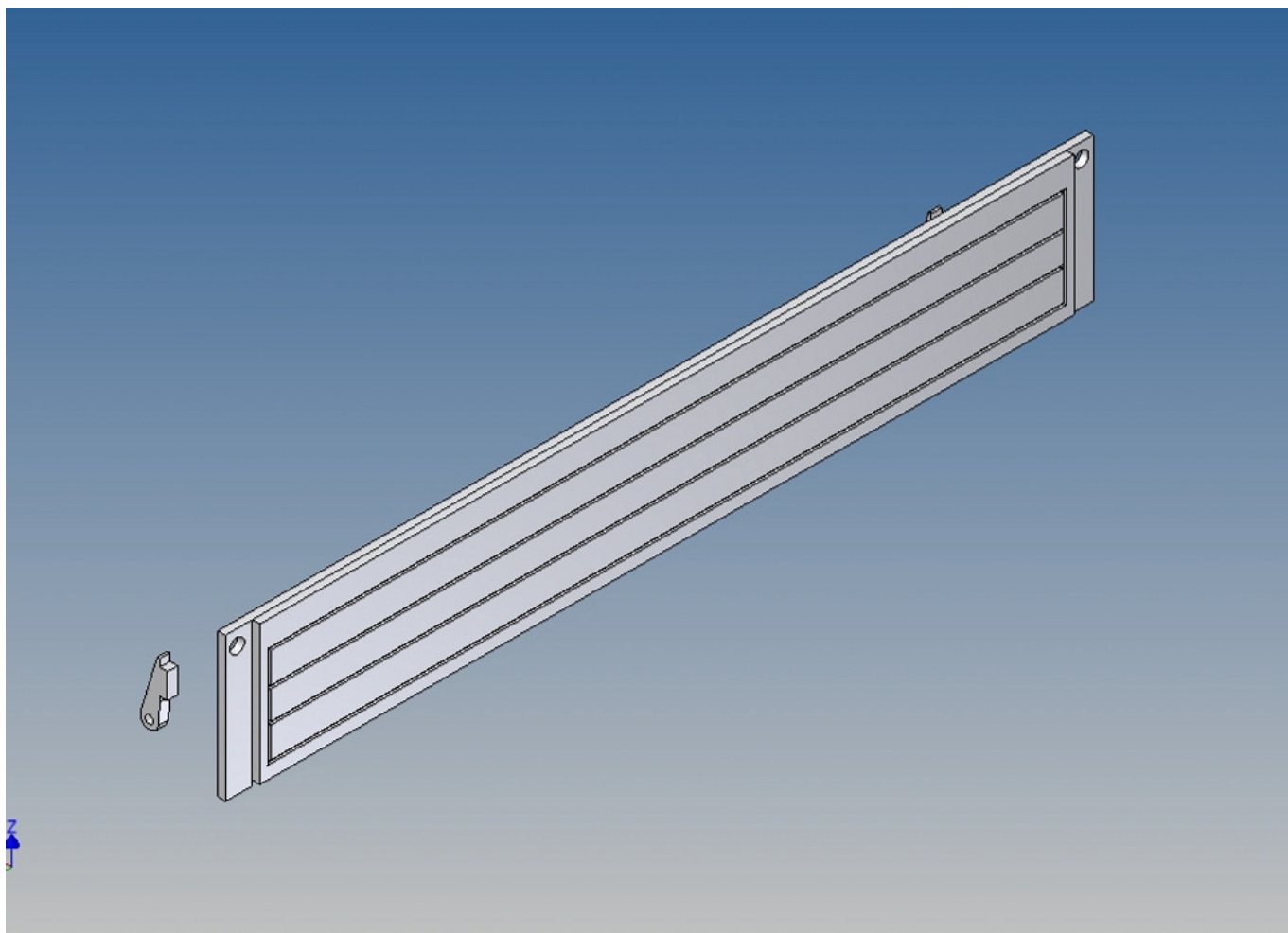

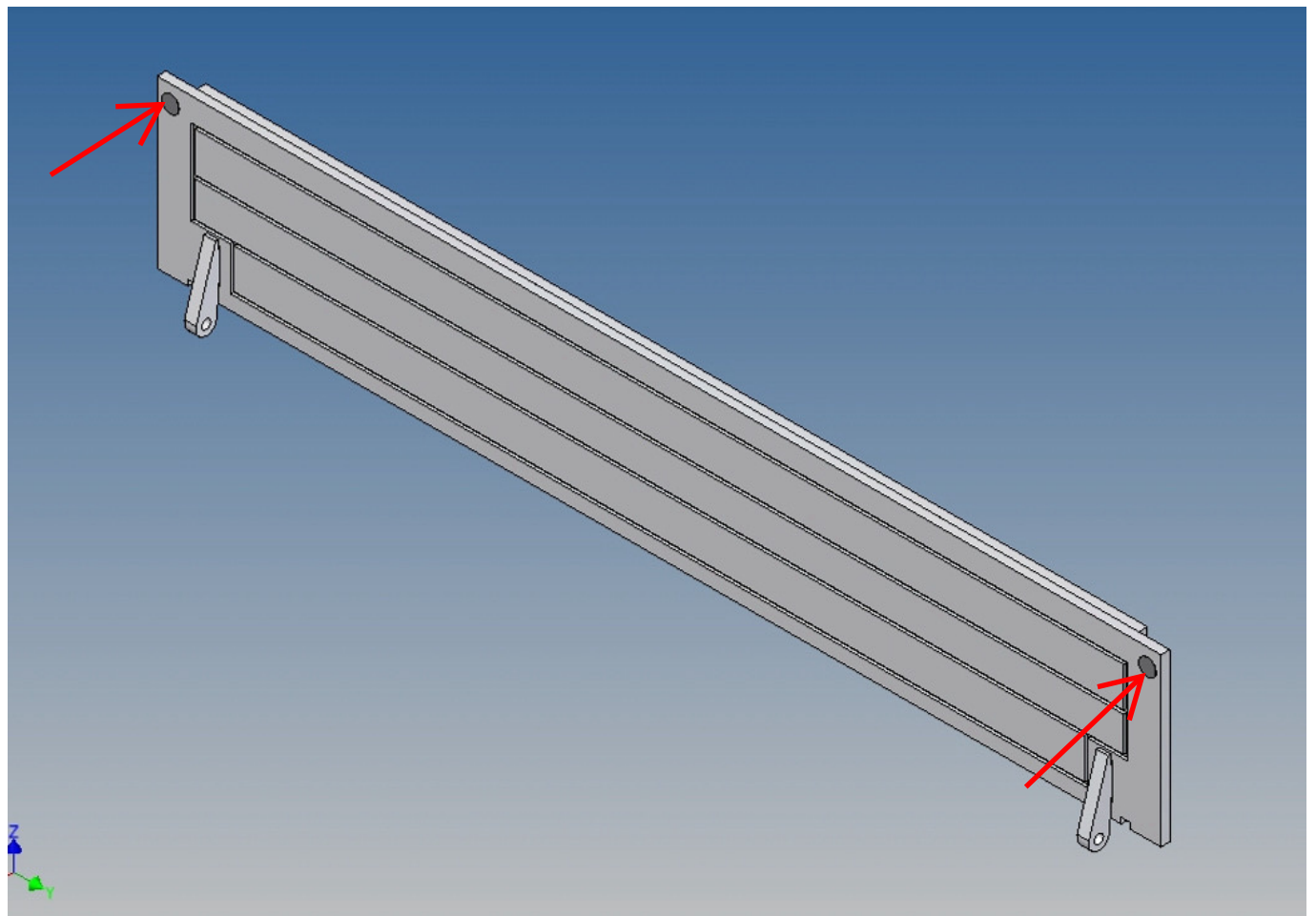
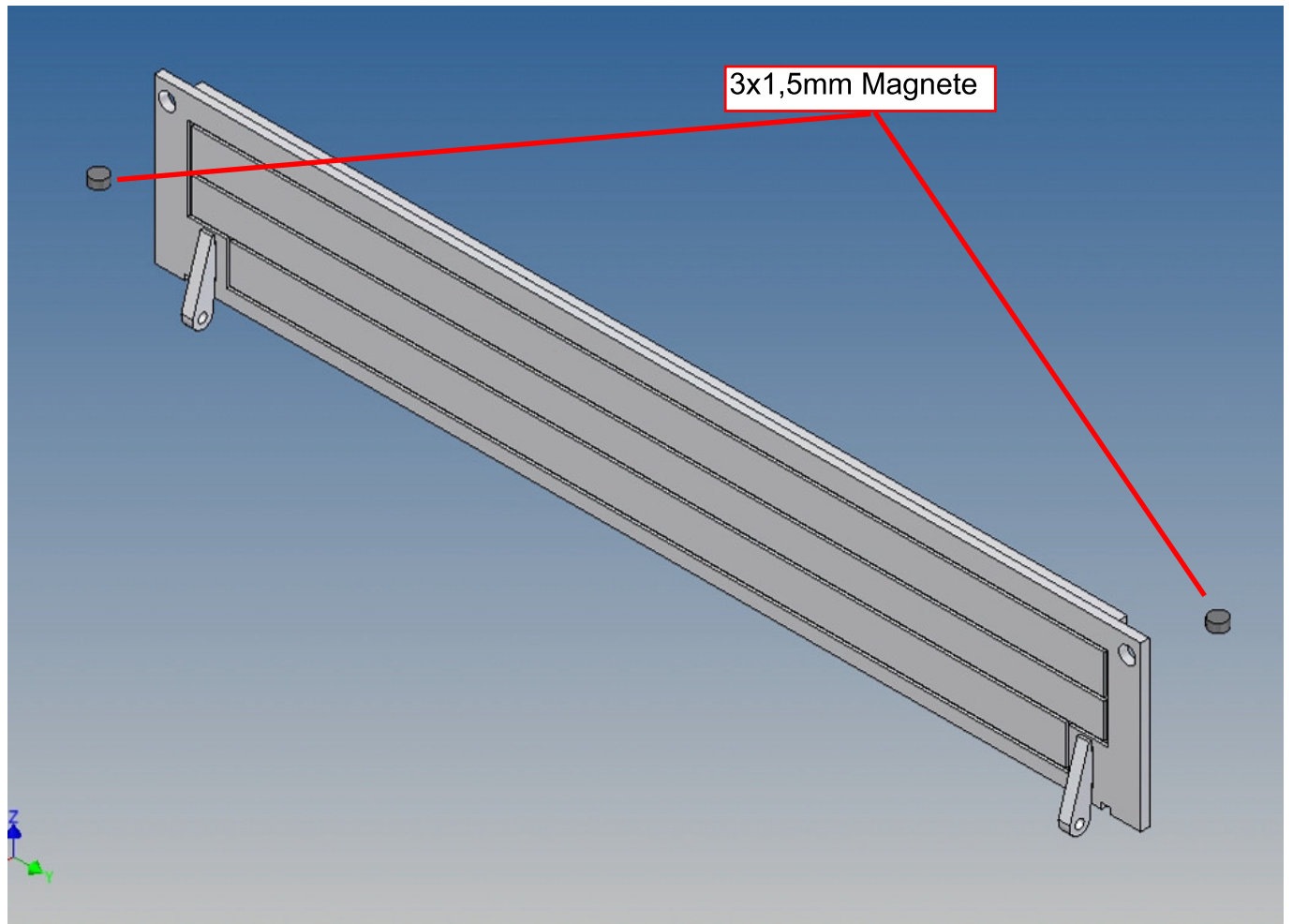

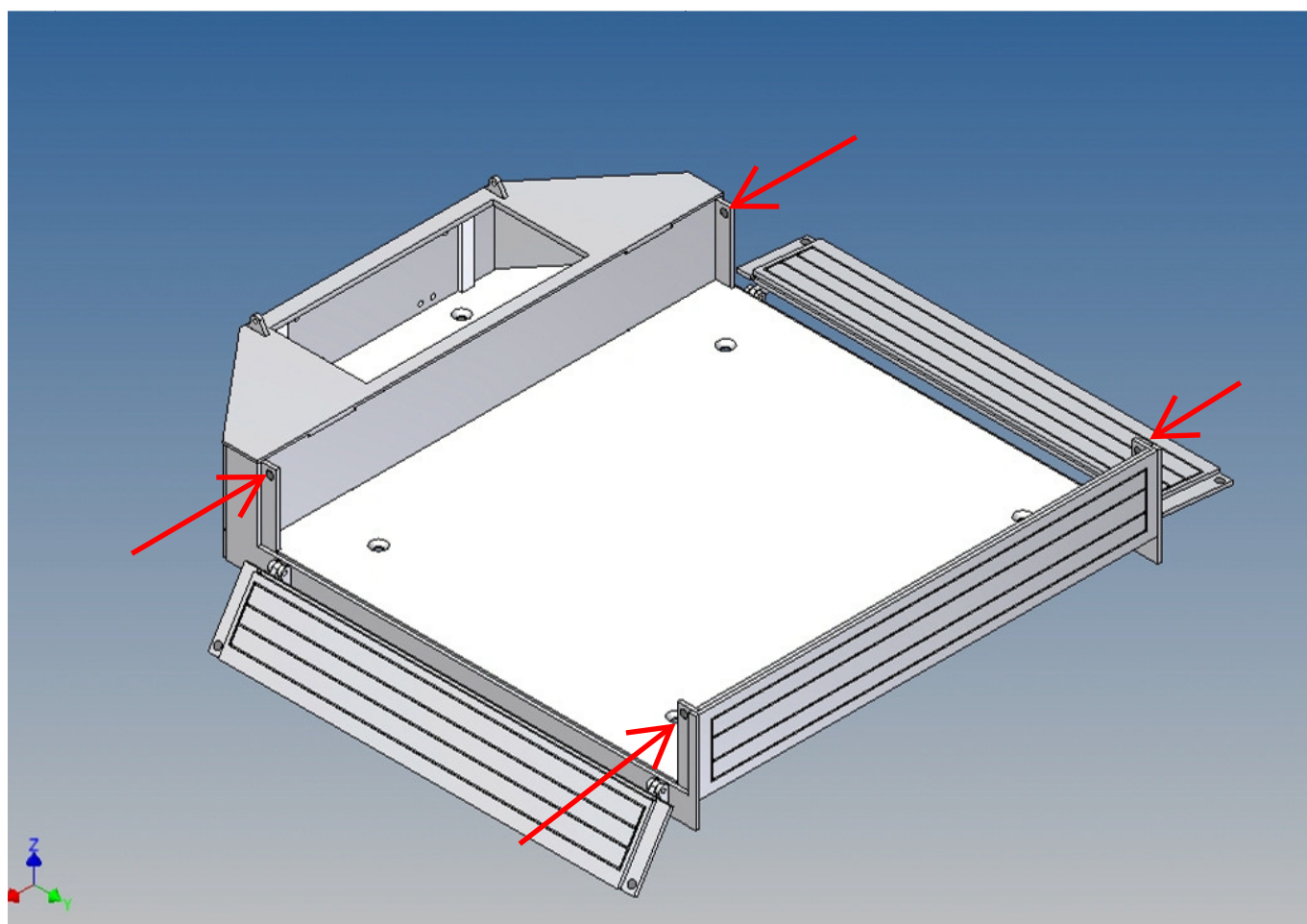
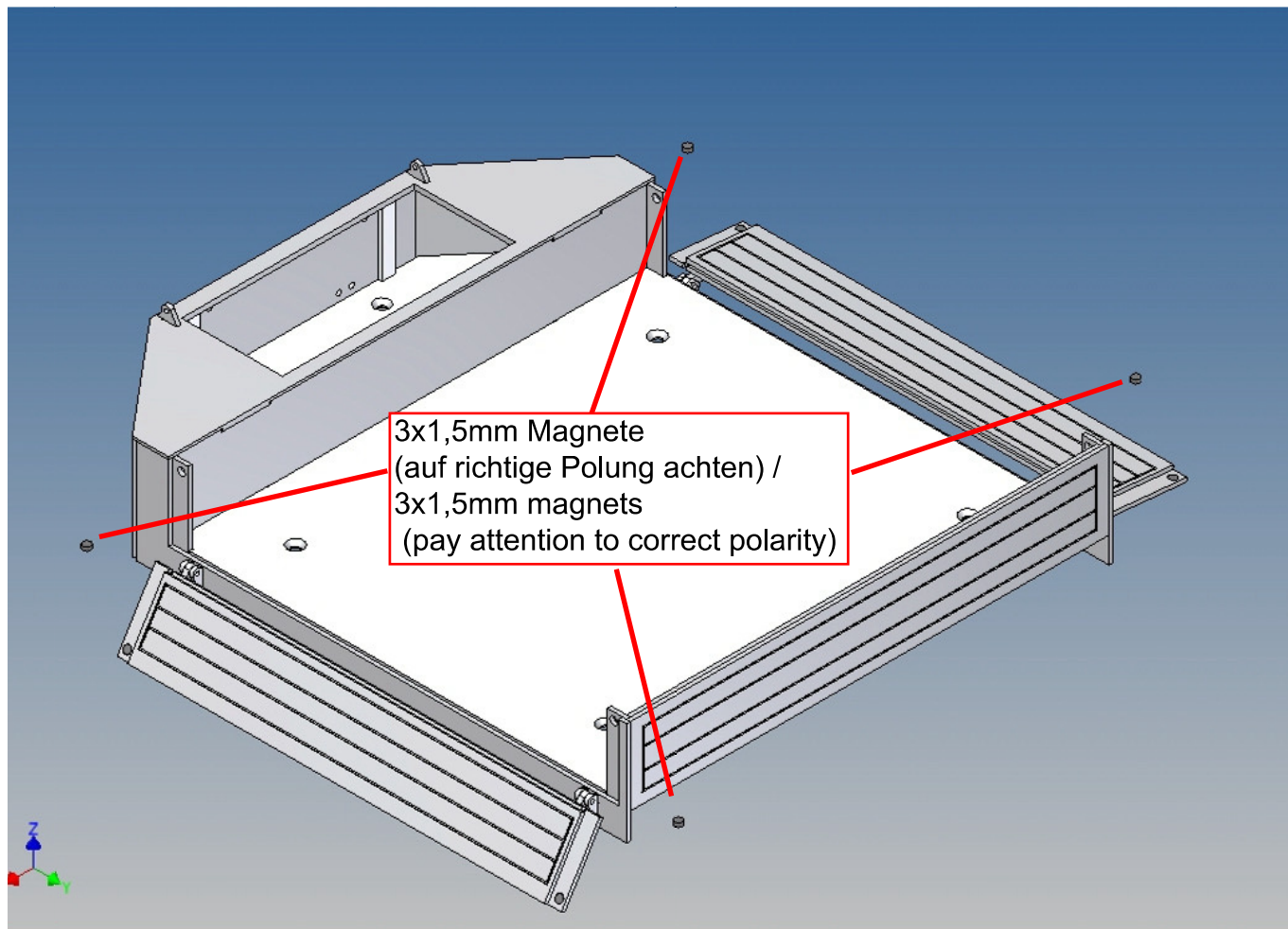



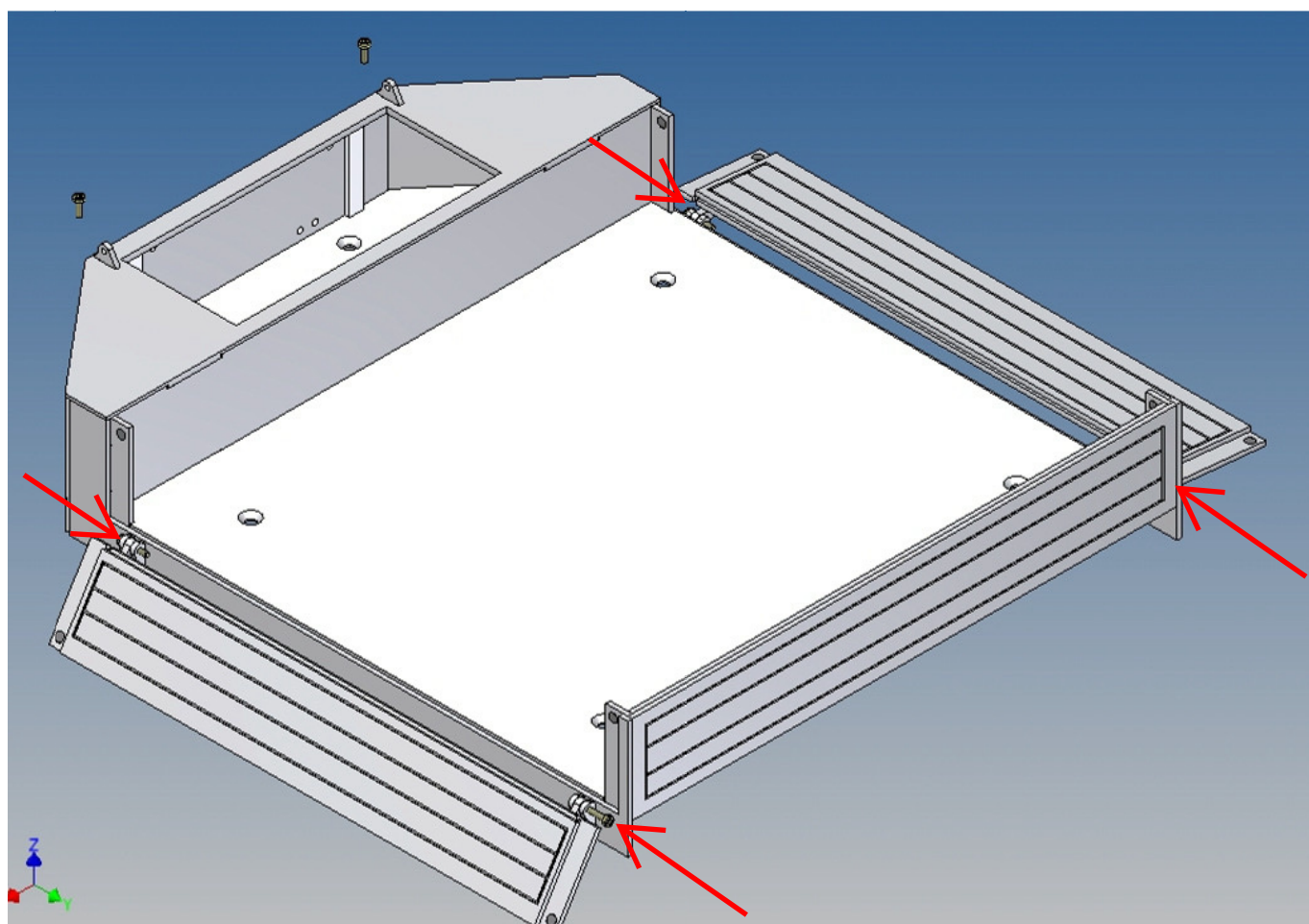
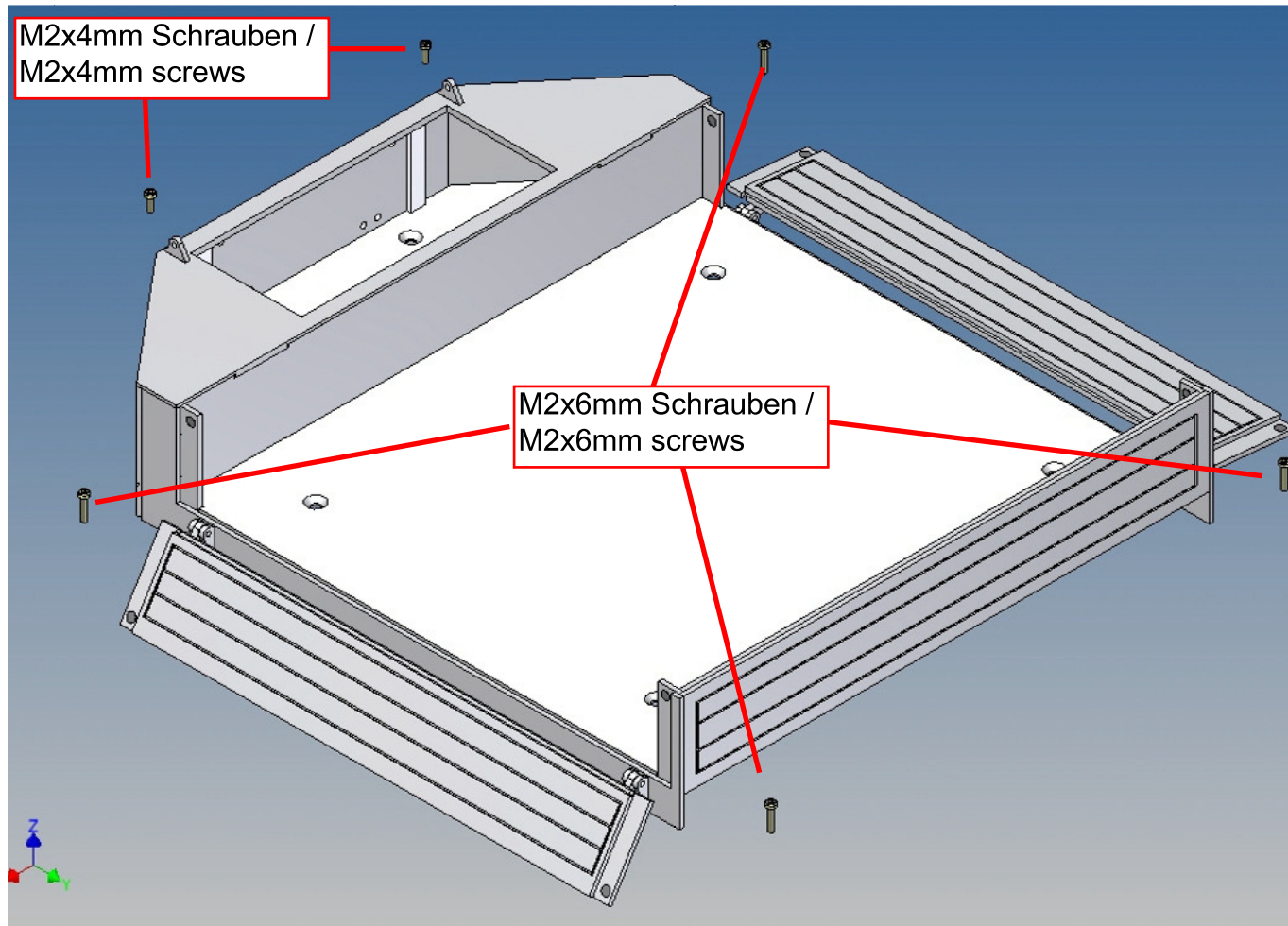

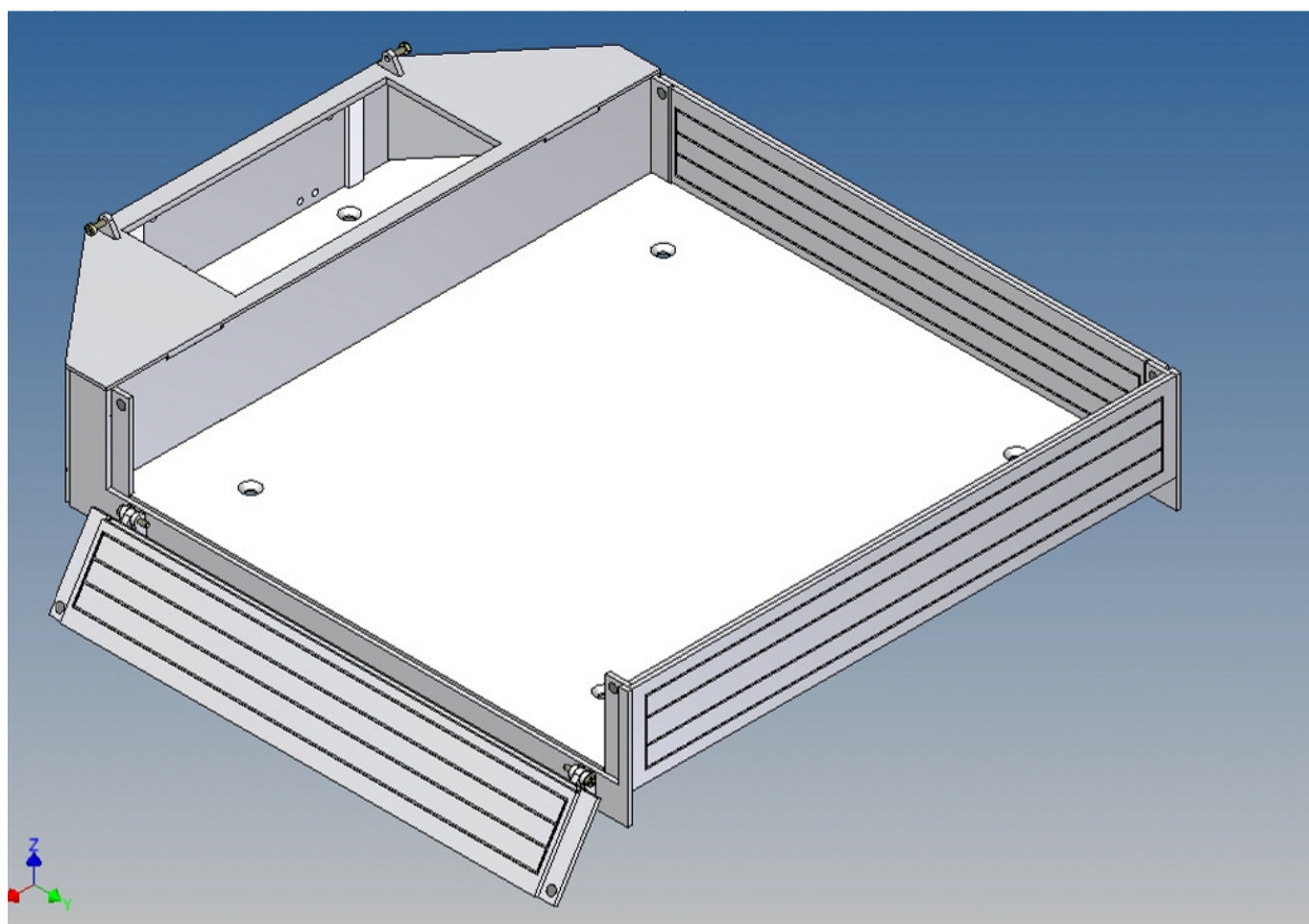
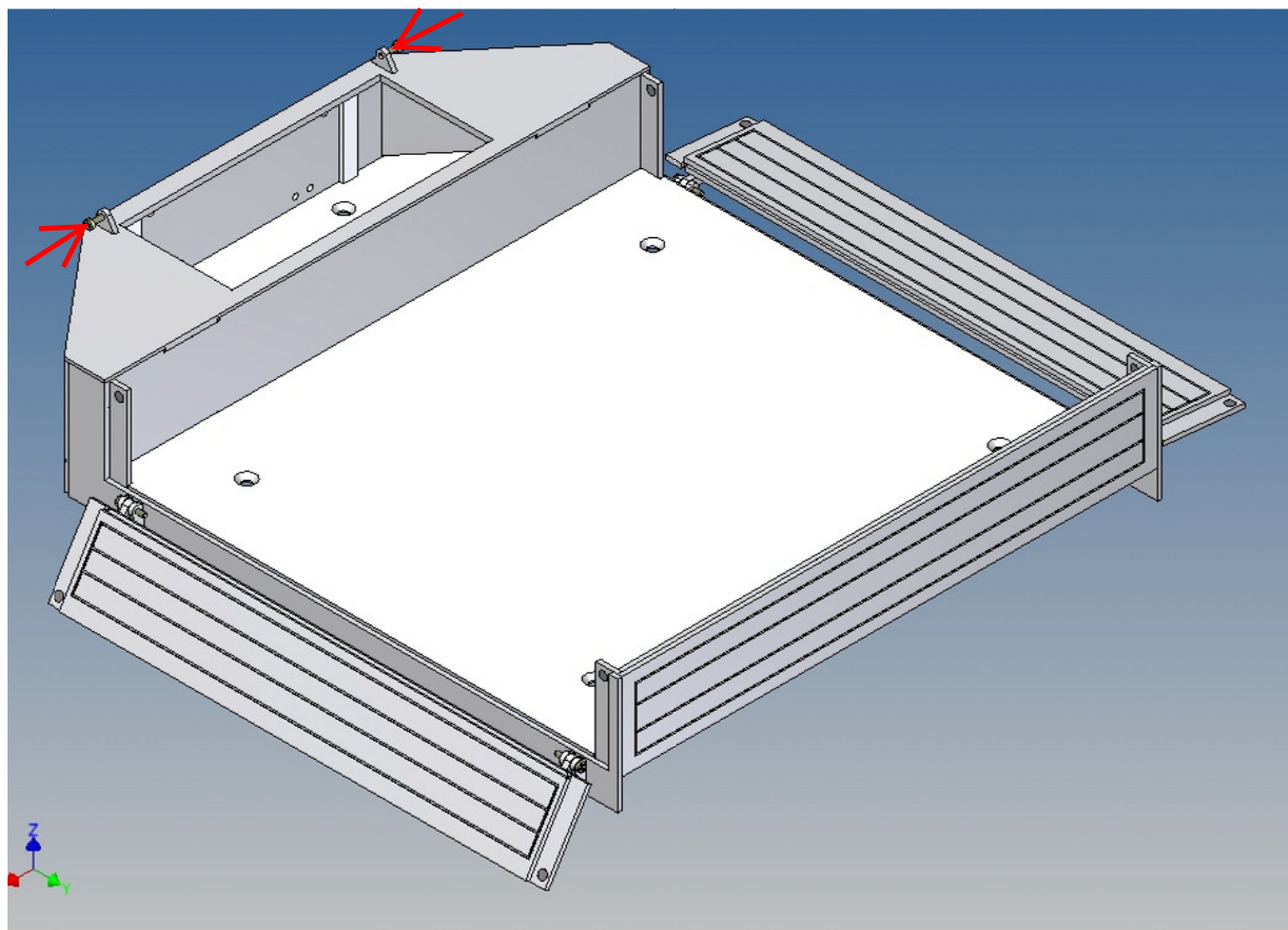



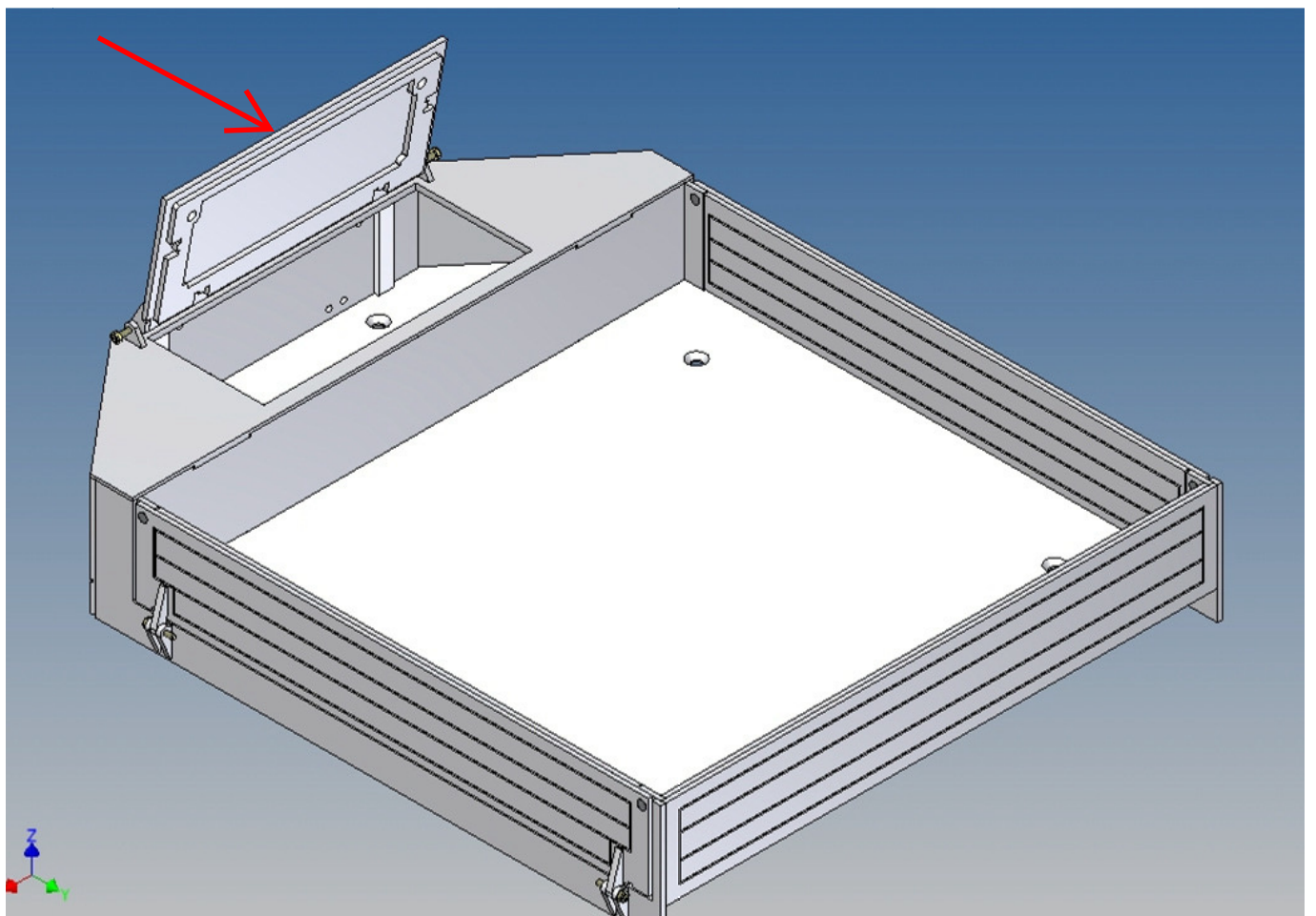
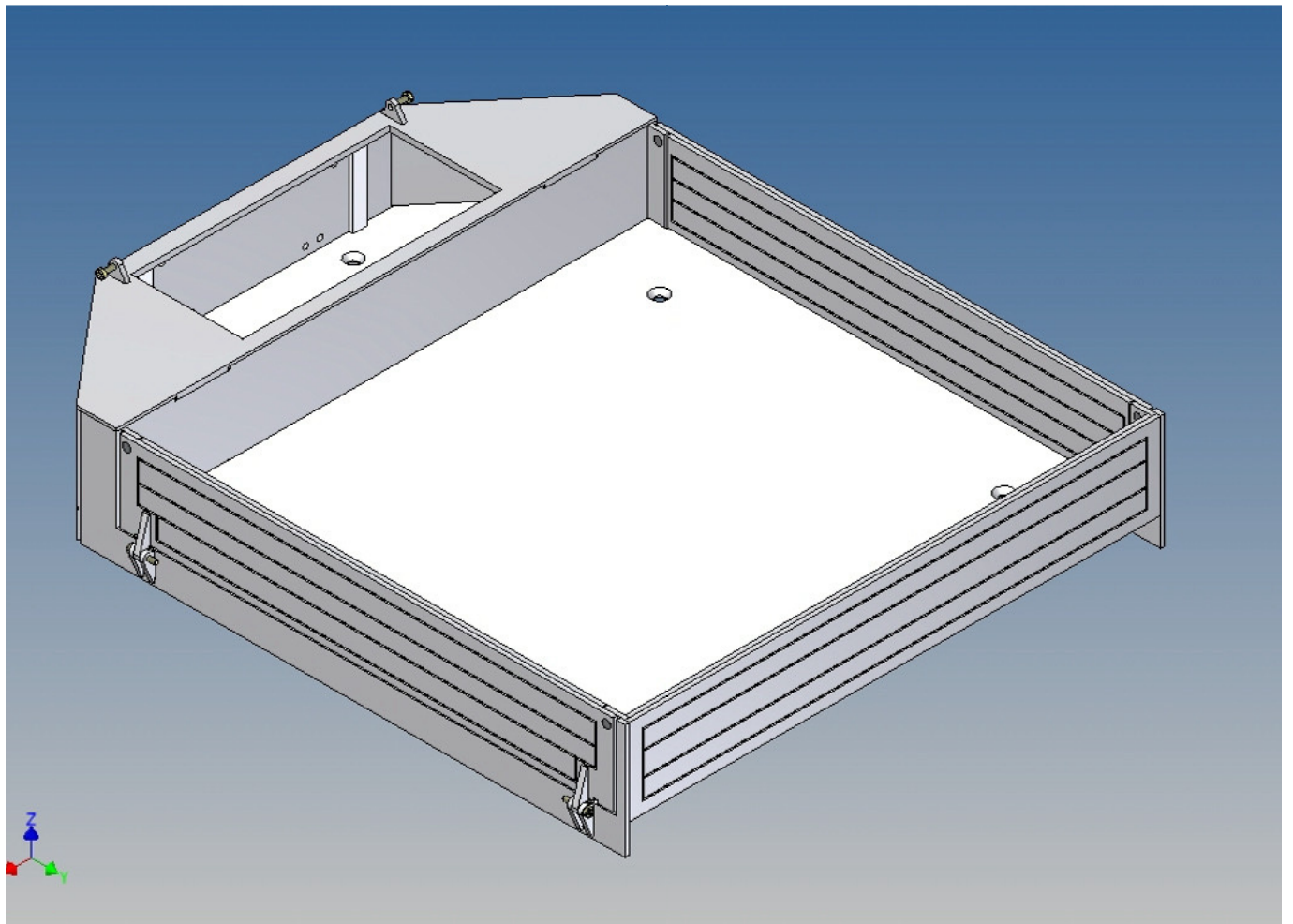

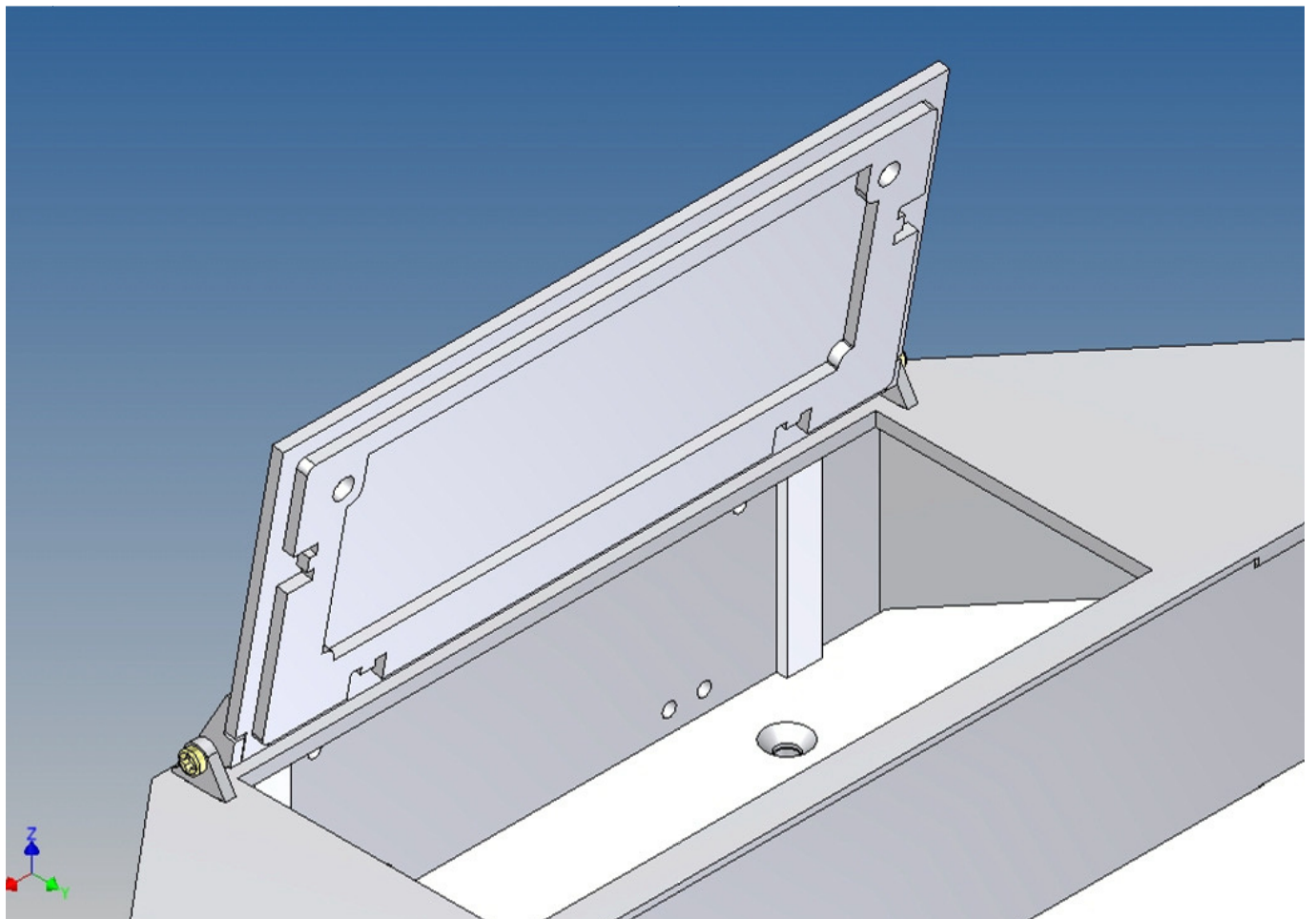
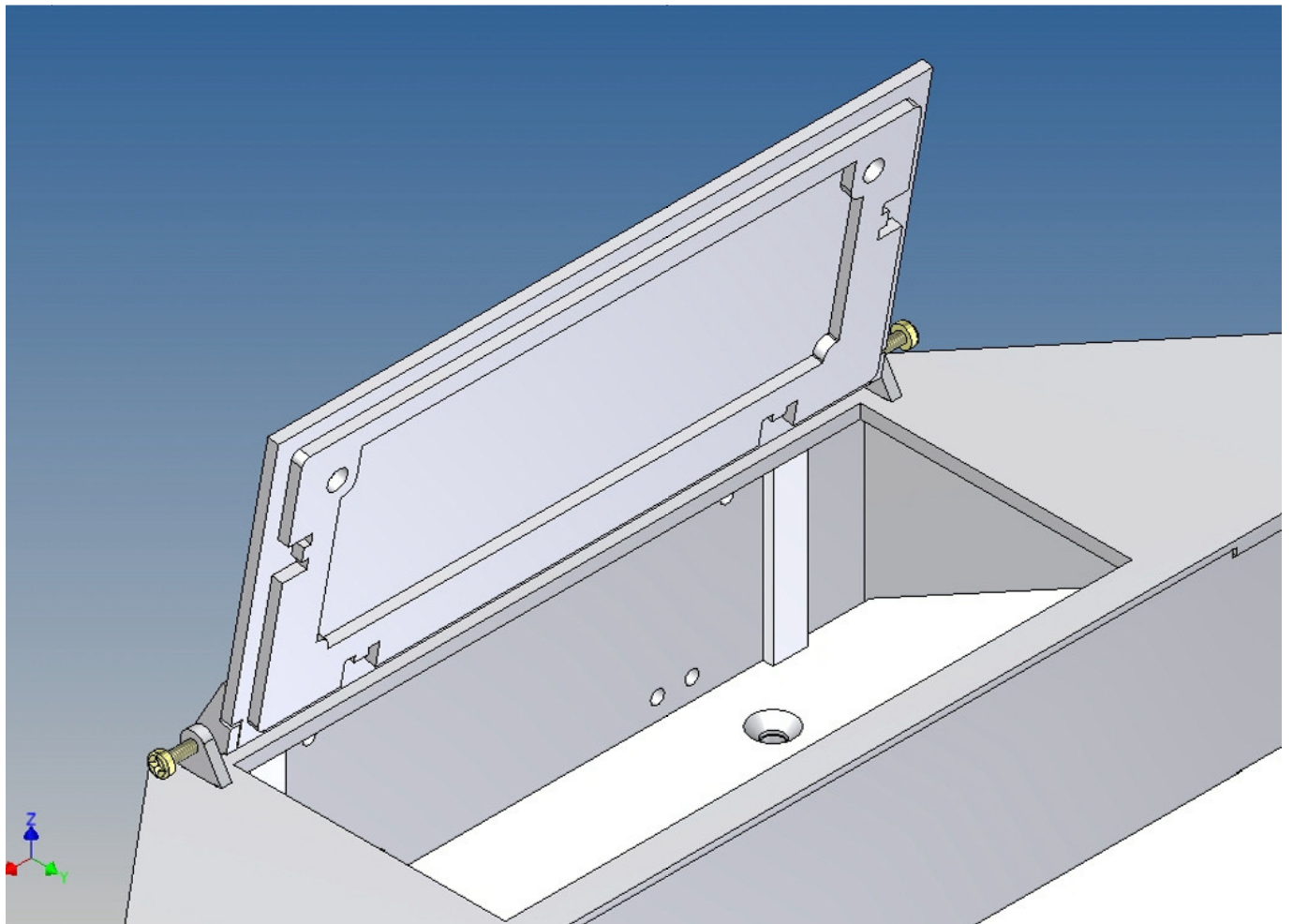

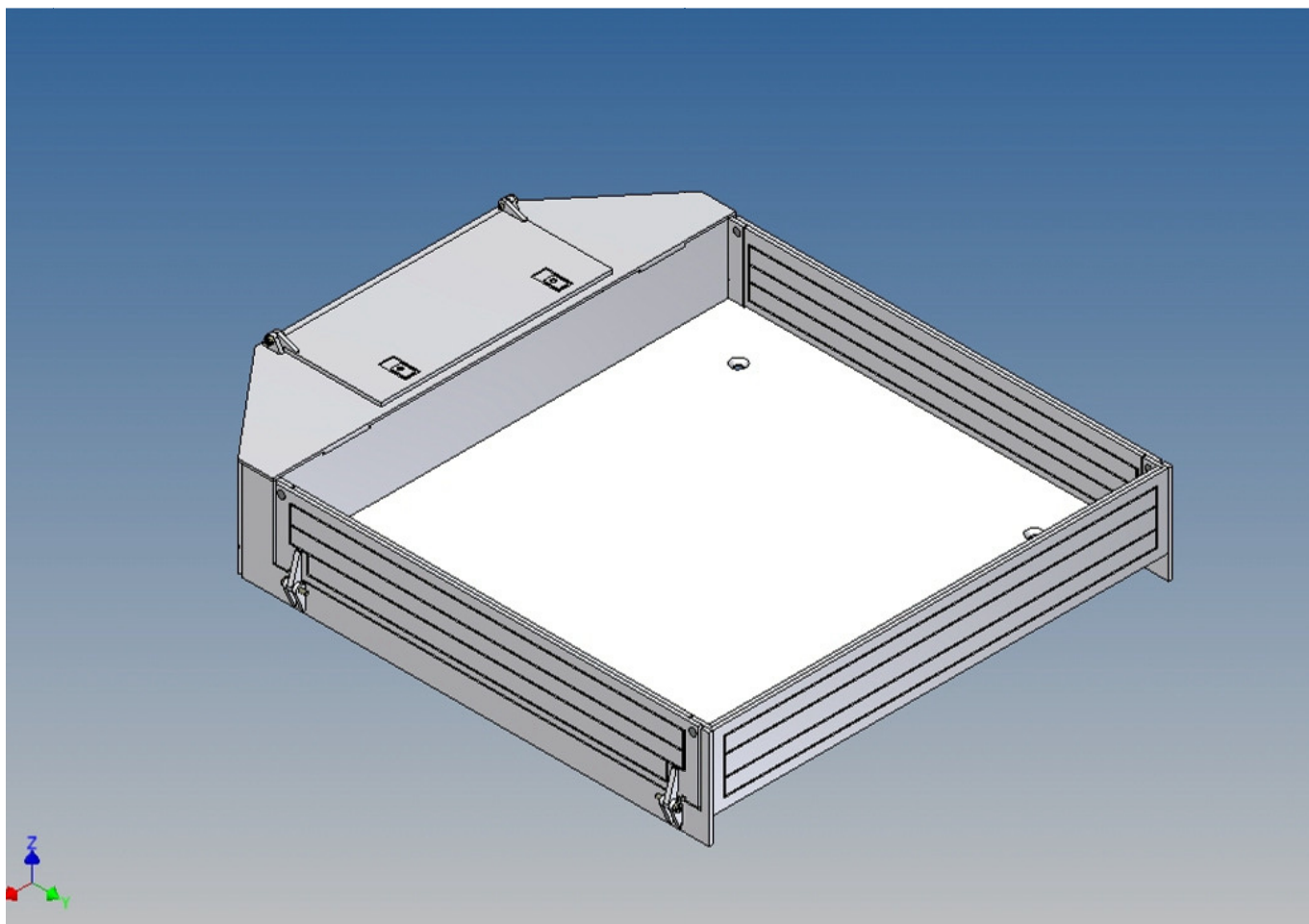
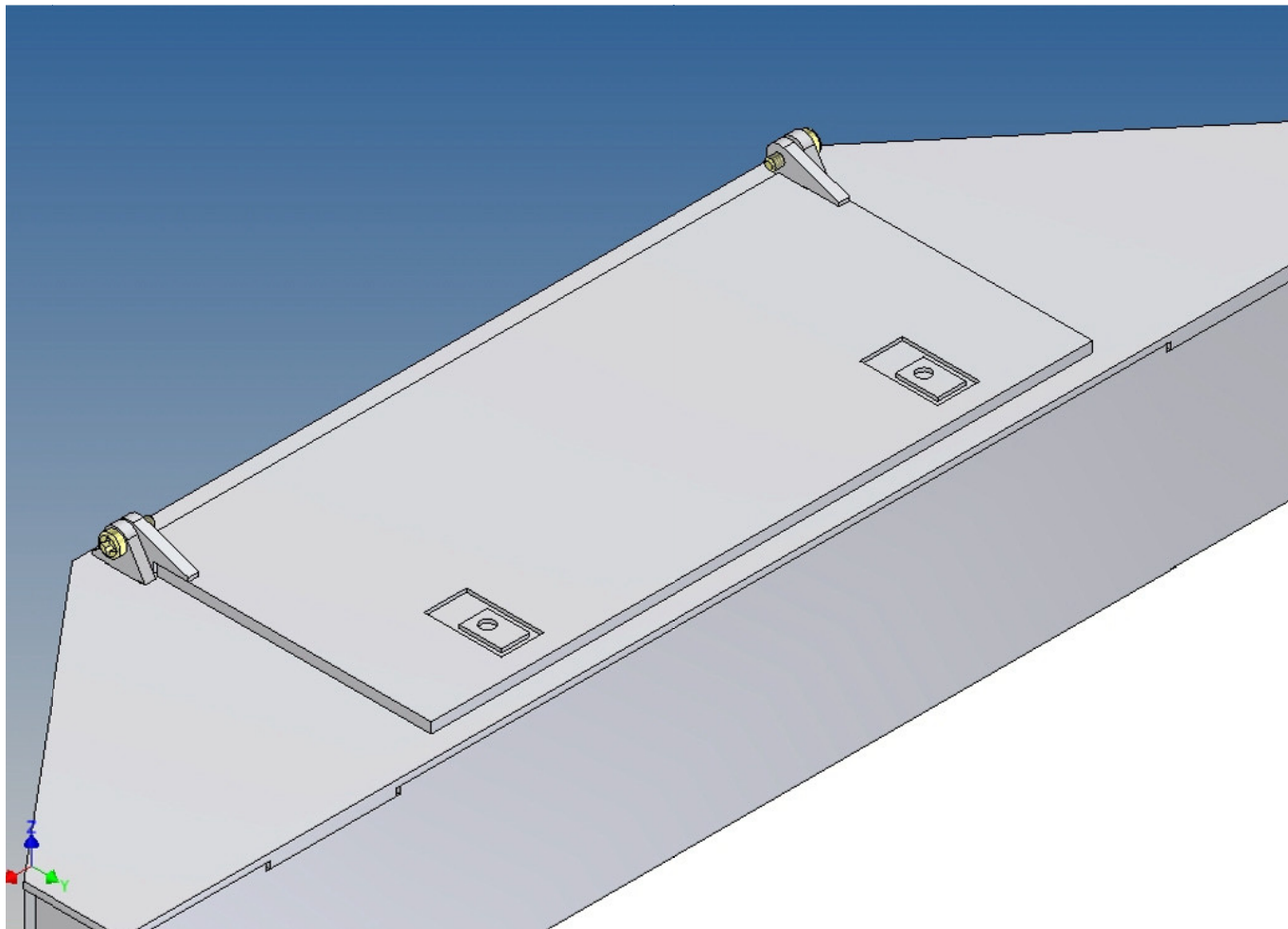



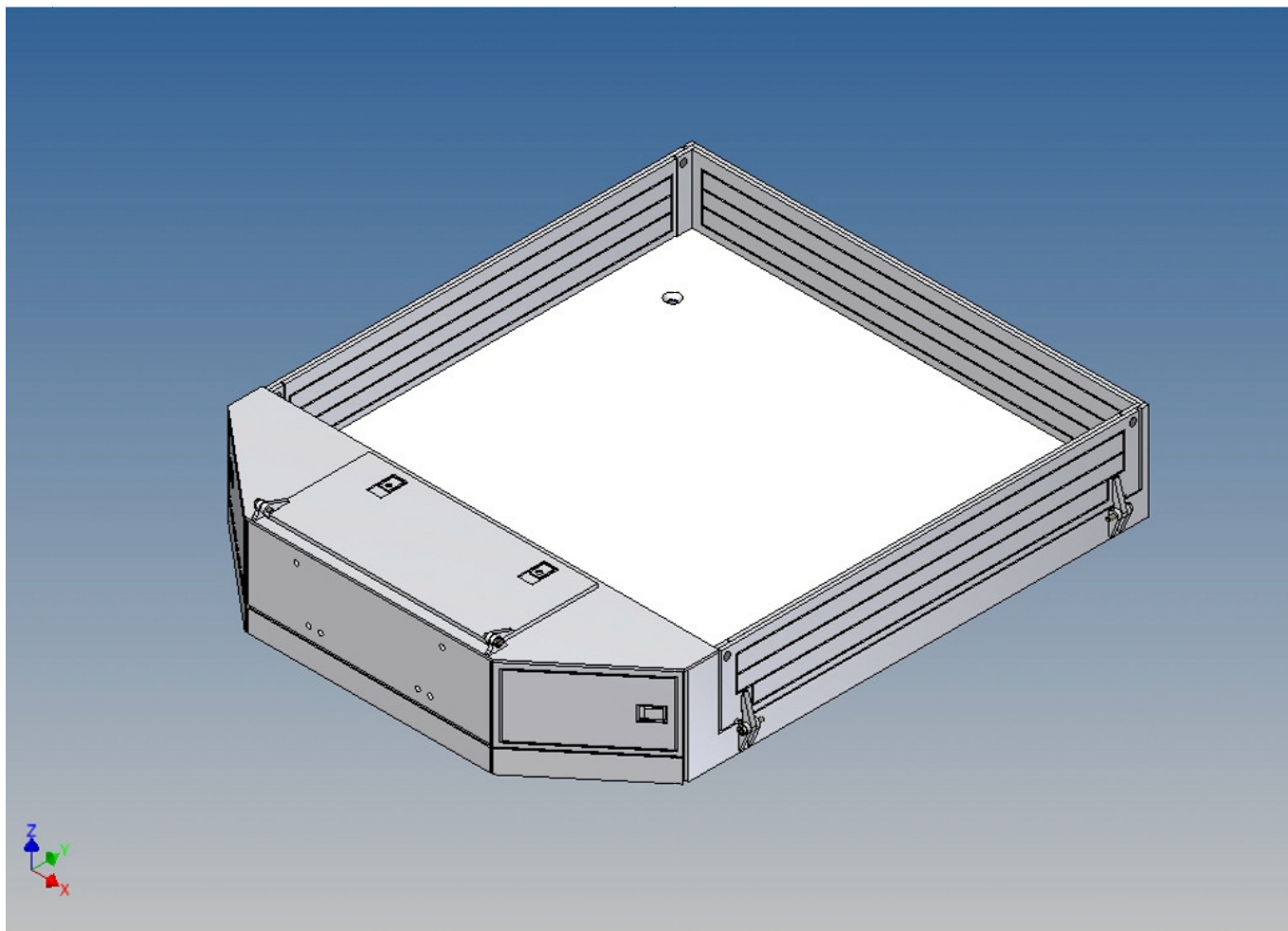

Je nach gekaufter Version, vorgeprägte Löcher bohren und Ersatzradhalter montieren /  
Depending on the purchased version, drill pre-stamped holes and mount spare wheel holder

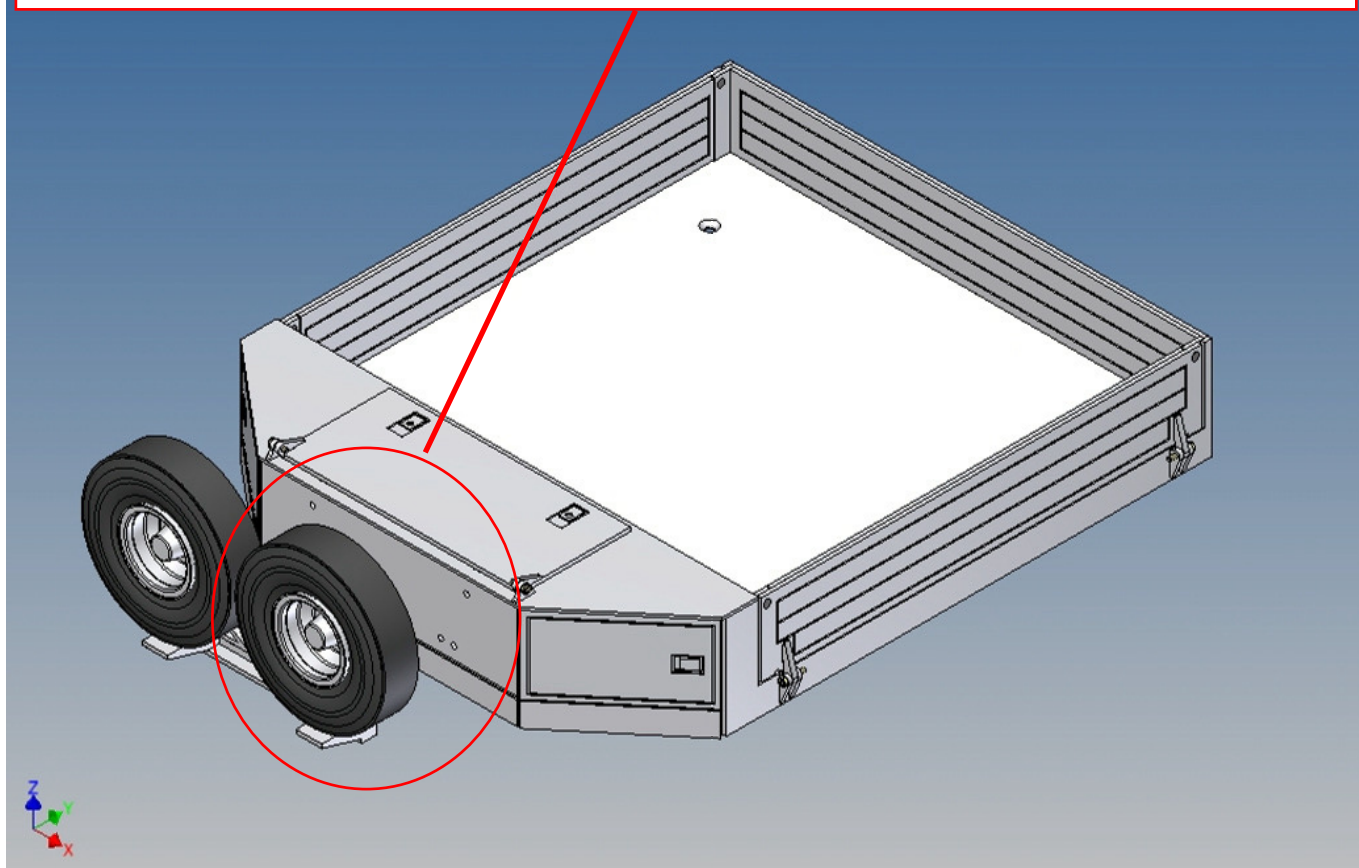

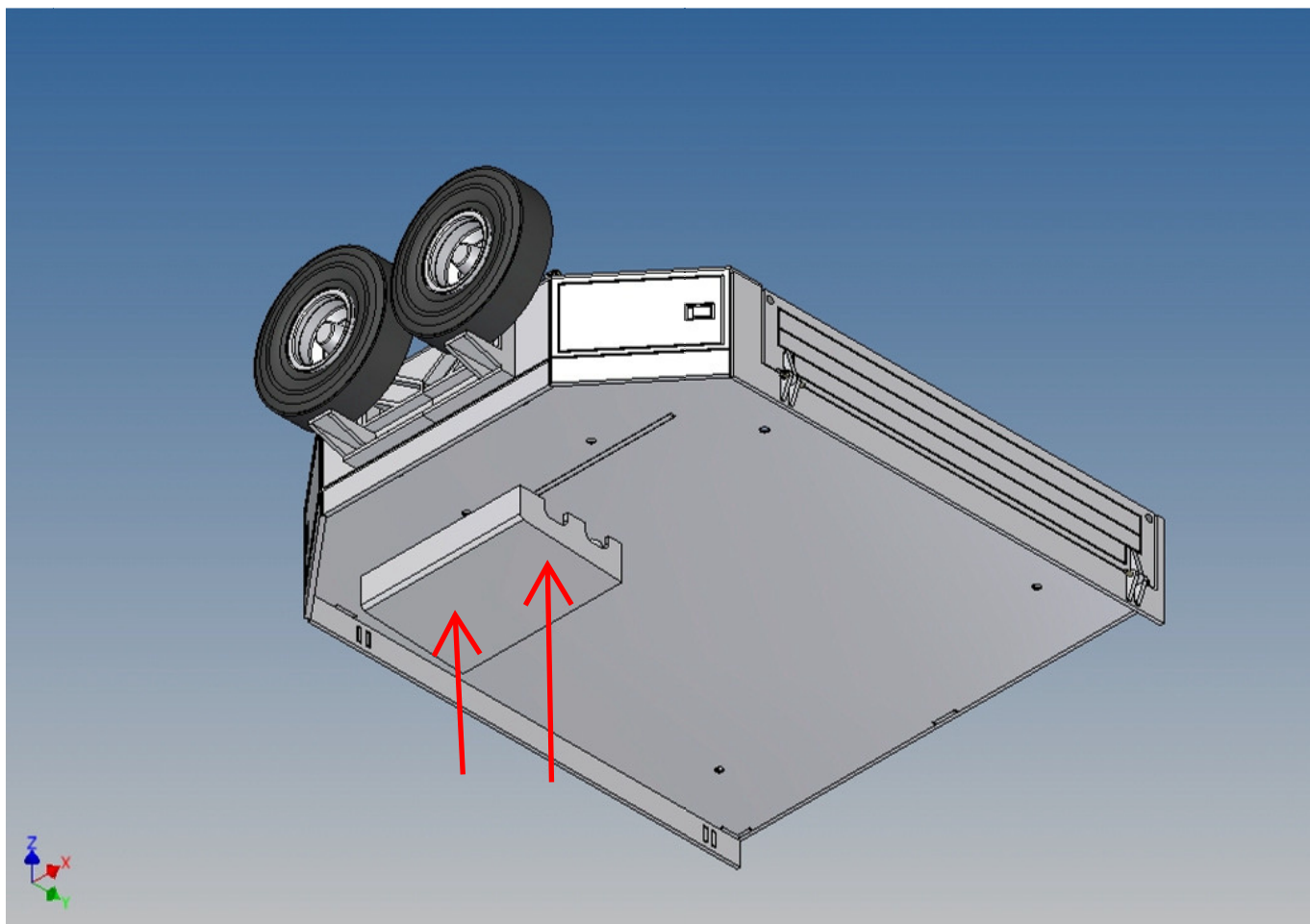
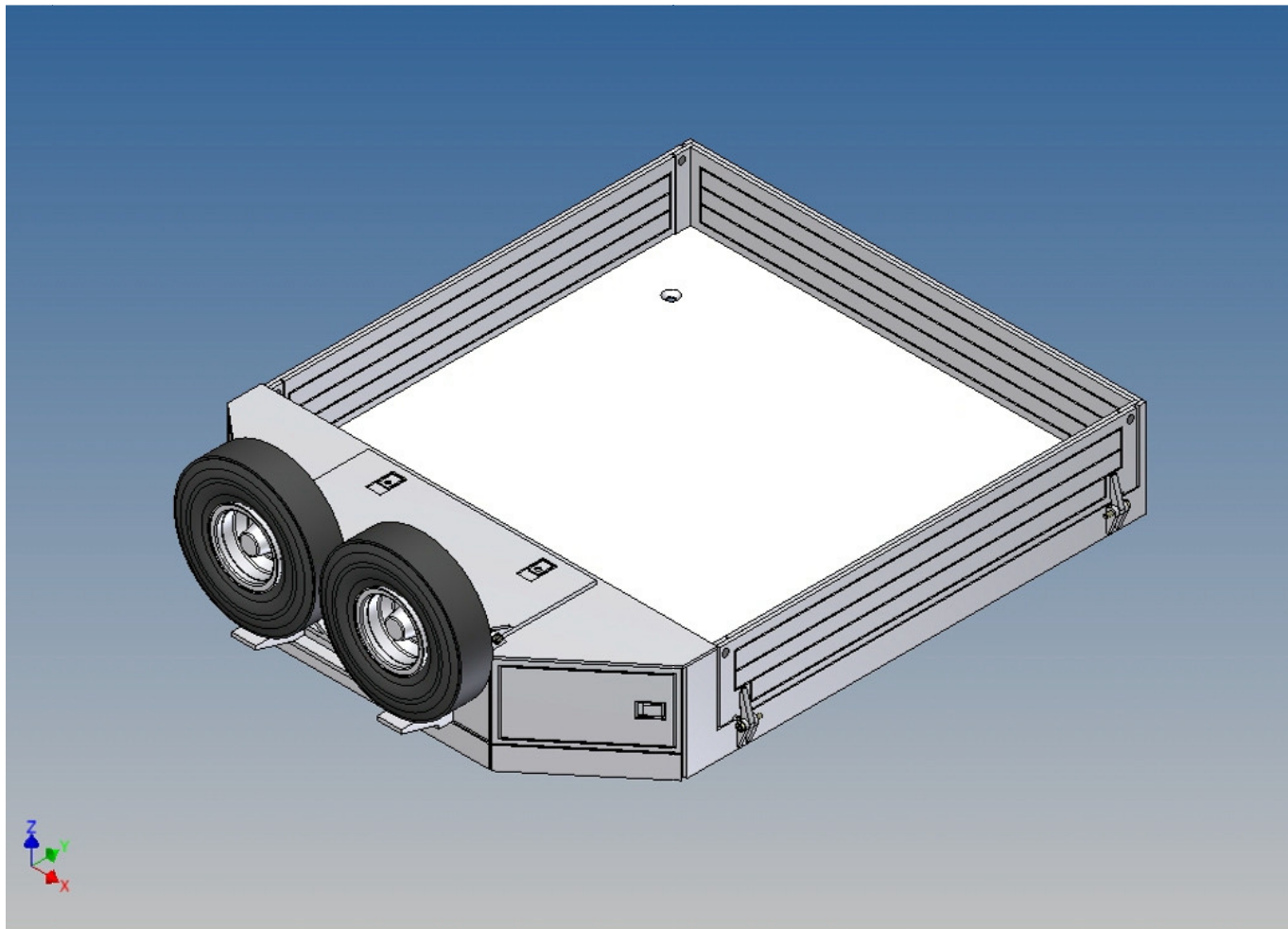

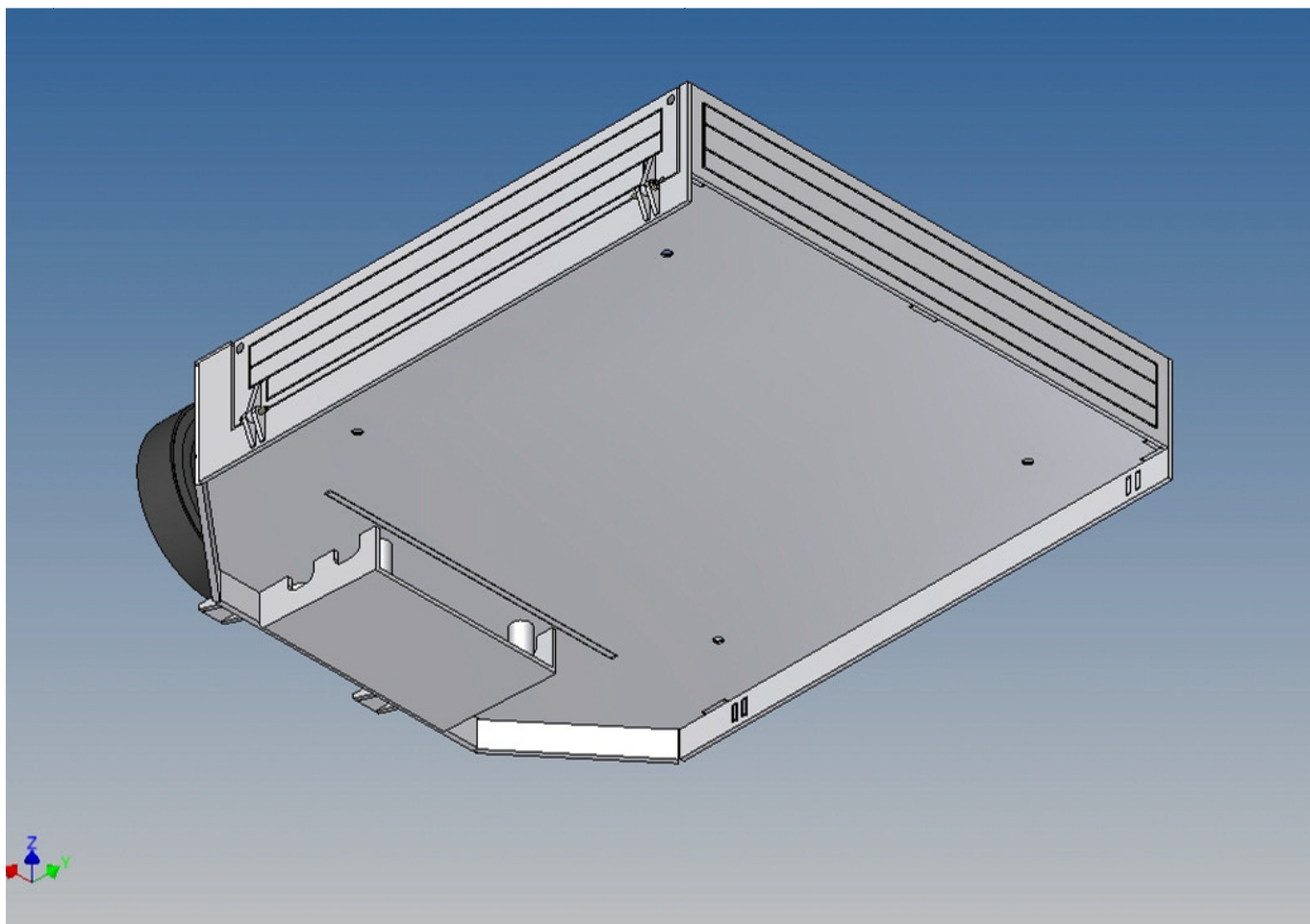
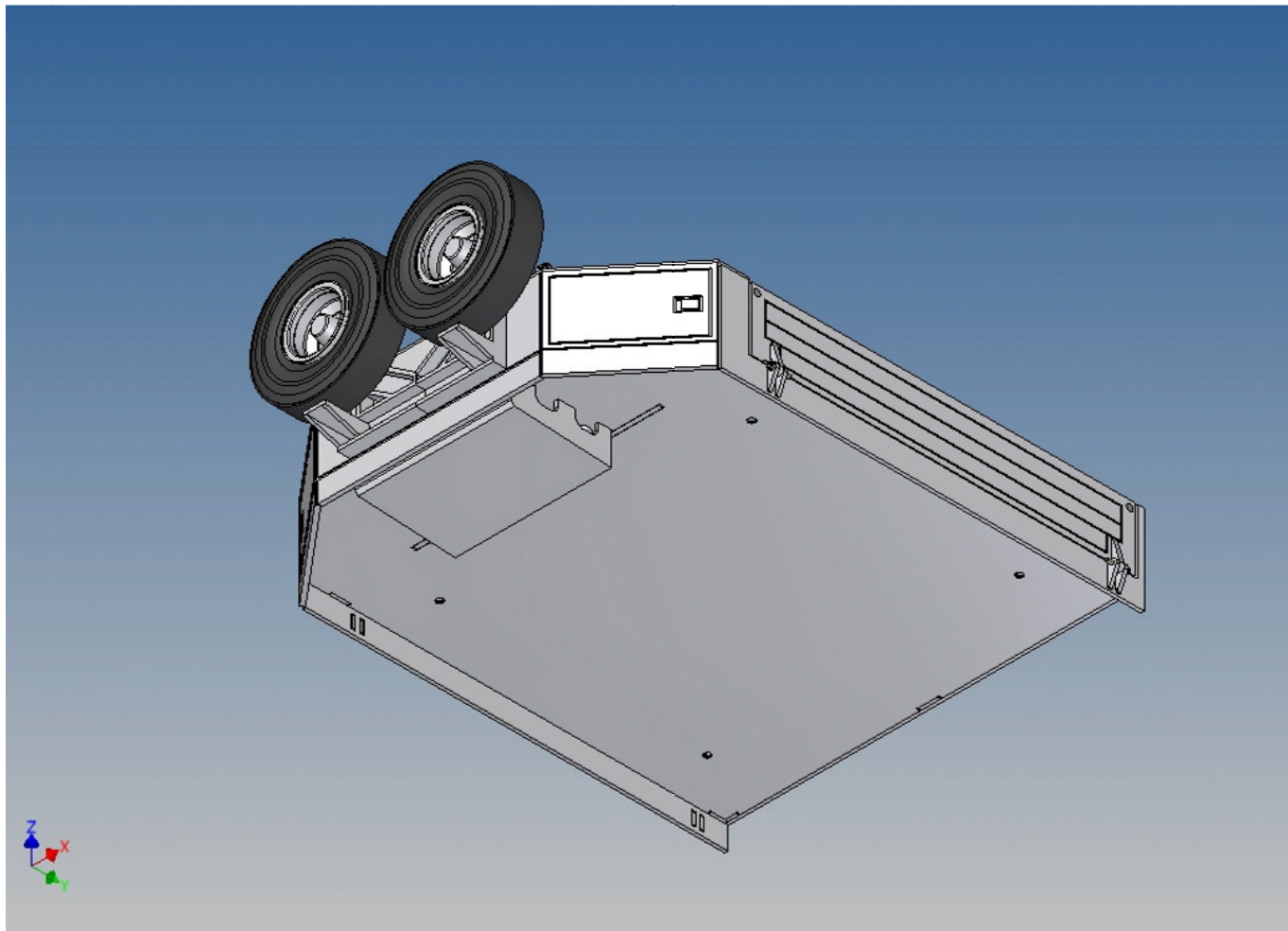

**Annotation:**

For technical reasons delivery also magnets with different dimensions may be enclosed.

Good luck and have fun - your MDTechShop team

[www.MDTechShop.de](http://www.MDTechShop.de)

For questions or replacement part requests please send a short e-mail.

**Warning:**

**This is not a toy! It contains small parts! Keep it away from young children!**