

Assembly Instruction

Storage box kit for Carson Trailer (1:14)

Best.-Nr.: 2016-9345-100/180

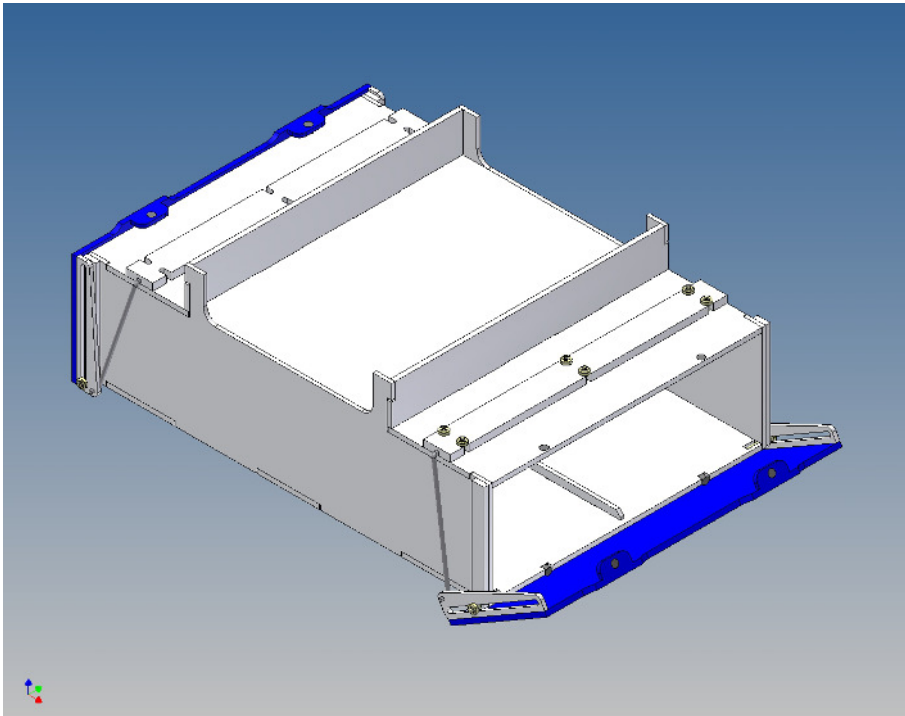

Version 2.1 – 28.04.2016

General Description

This polystyrene-milled parts set for a storage box as an accessory to the Carson Trailer (1: 14) designed.

The storage box can be mounted on the trailer frame and has on the outside of a cover with kinematics, which is held by magnets (are magnets in separate bag) .

Inside the box can technology or scale model pallets accommodated.

Holes and threads for mounting must be provided at its own discretion.

Assembly Procedure

Before you put the parts together please read the assembly instructions carefully and pay attention to the assembly sequence and test the fitting accuracy of the parts before gluing them together.

It is helpful to fix the parts at first only on a few points with super-glue and after a check along the edges fully with super-glue or a polystyrene-glue.

The parts are made of polystyrene, if you use super-glue in combination with activator spray, please be aware that the activator spray can destroy polystyrene – because of that you should use it very carefully or use only polystyrene-glue.

Step 1 (Floor):

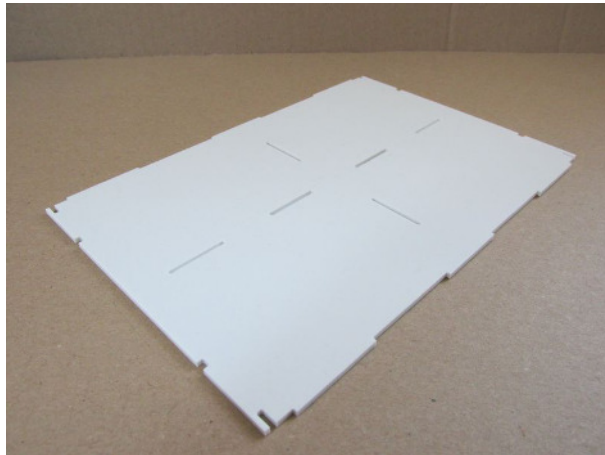

The floor has on the inside several engraved grooves. Above the ground to the 2-row storage box 130 is shown. This has a crosswise row of groove for partition and two rows of grooves for the guide rails with. The 3-row storage box 180 has four rows of slots (two left and right), the 100 box has no guide rails with but two rows of grooves for partition.

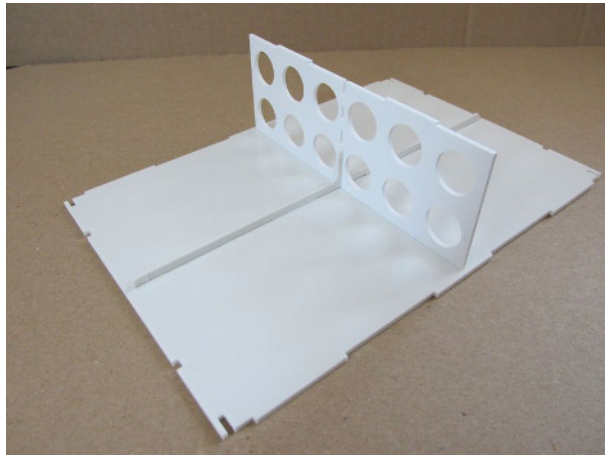

Here you can see the glued partition and the two guide rails with.

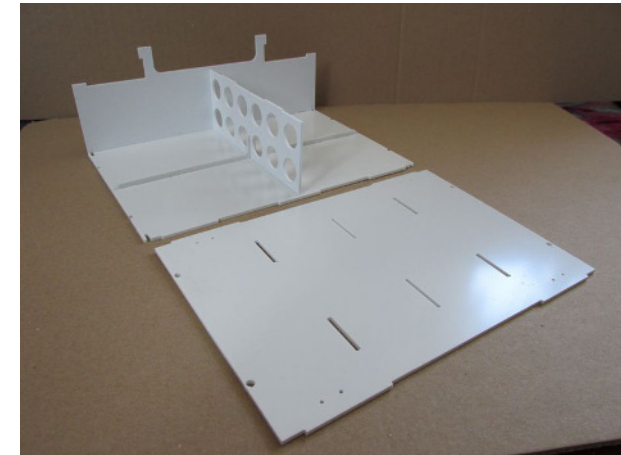

The first end wall can now be attached to the floor. Fronts can be seen the lid lying on the head. The row of grooves in the center is then placed in the assembly in the partition and the end wall.

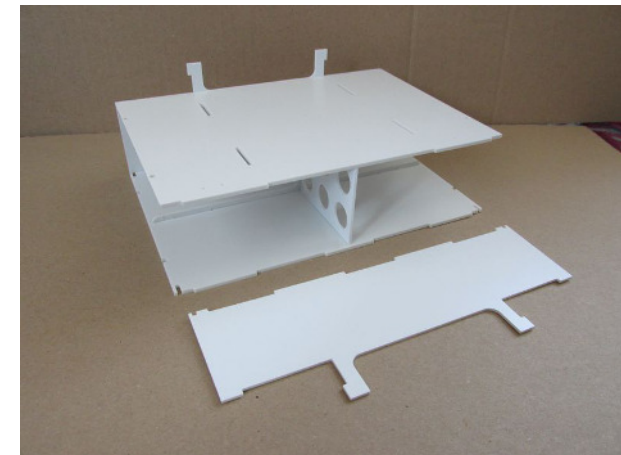

Now, the second end wall can be bonded.

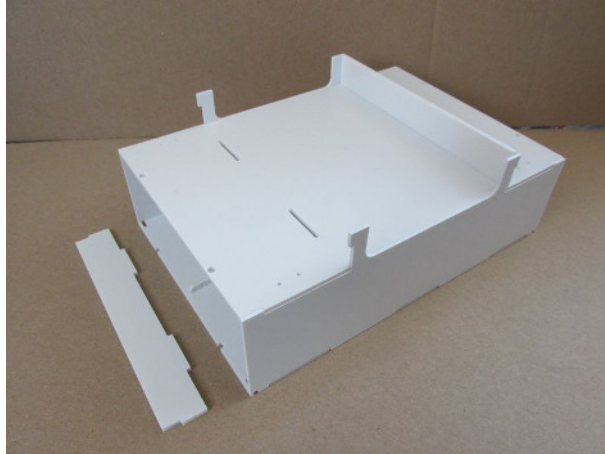

In the broken grooves the two Frame holder bars can now be glued. Here, ensure good adhesion, since the entire weight of the storage box is caught in these bars.

Step 2 (Front plate):

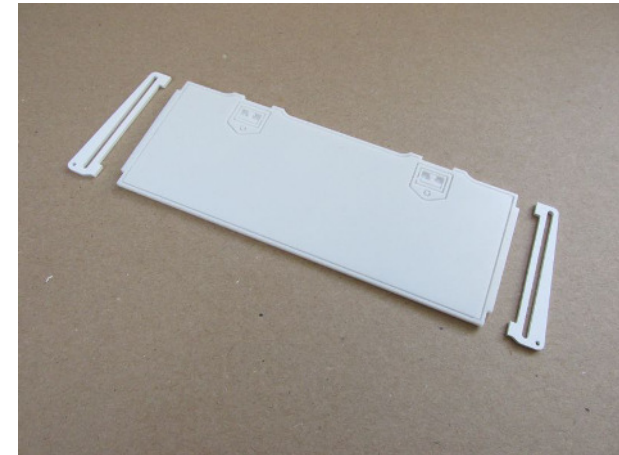

Here you see the engraved front plate of the door and lying ready for assembly.

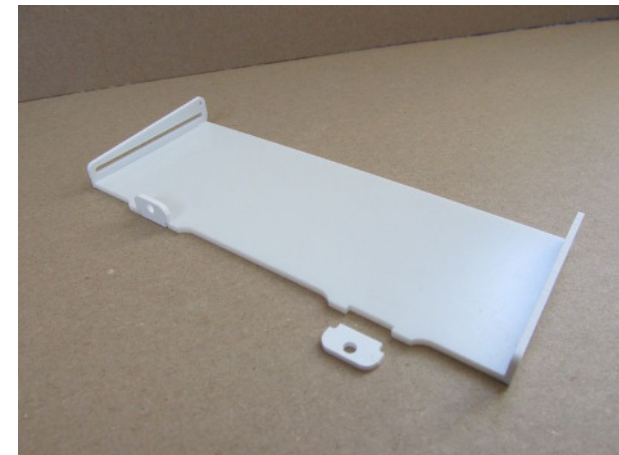

The two guide elements are inside glued flush, pay attention here to a good bond. Likewise, the magnet holder is glued in the respective groove.

Step 3 (kinematics):



On the box, the bearing strips are adhered now to the four front edges. The hole should come be closer to the forward edge and cover with the slots in the floor.



Here again to illustrate the position of the bearing strips.

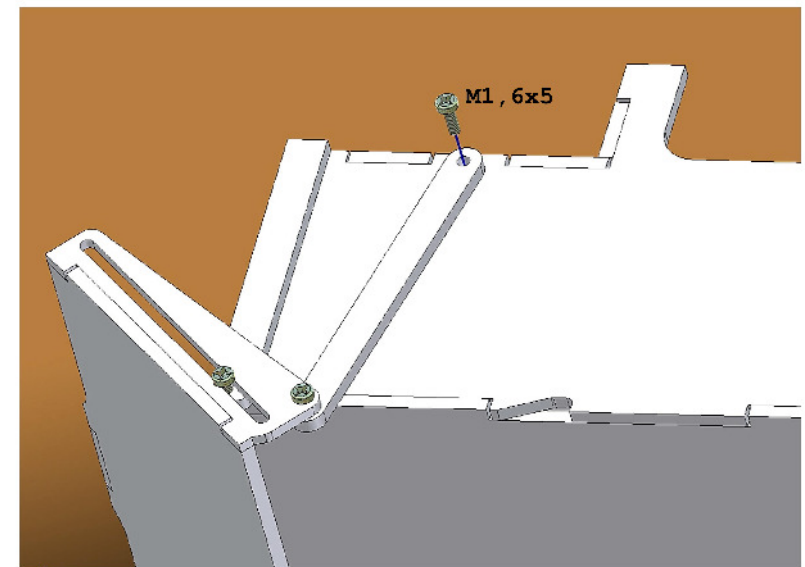
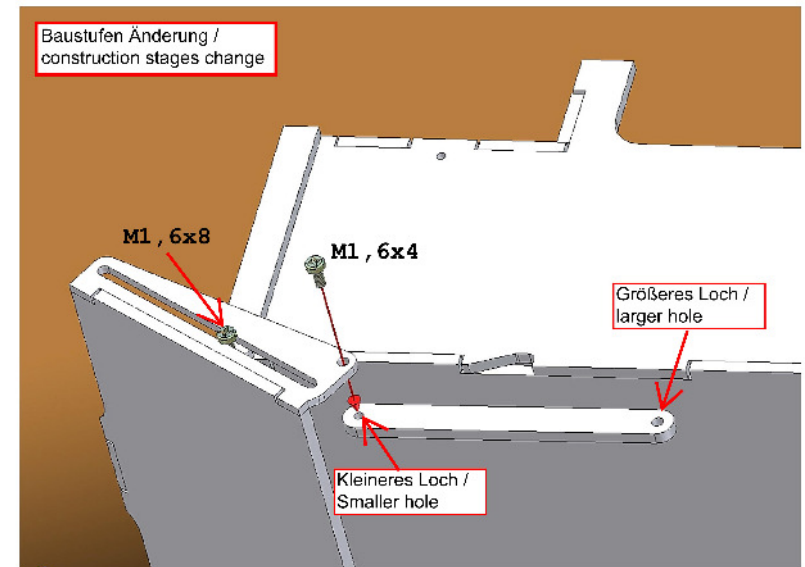

Step 4 (magnets):

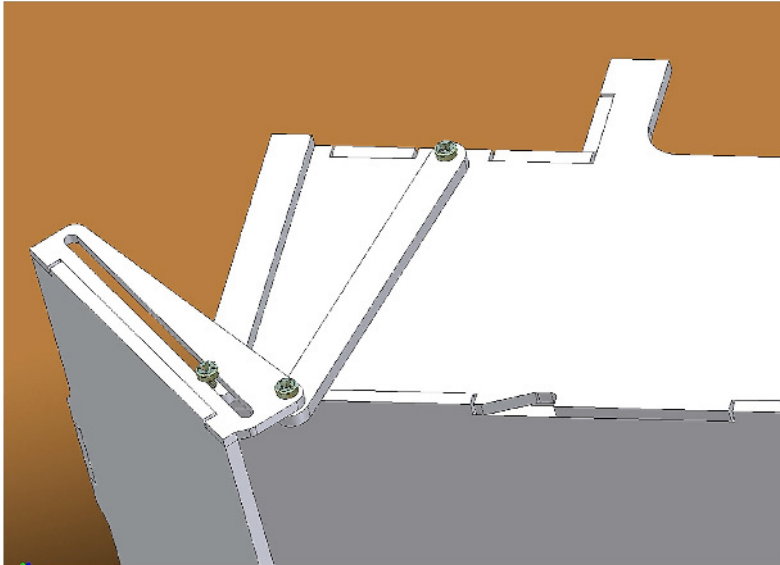

The kit contains 8 neodymium magnets at $d = 3\text{mm}$ and 4 neodymium magnets at $d = 1,5\text{mm}$.

Later, when gluing the magnets in the magnet holder and to the box, it must be ensured that the magnetic polarity are combined that the magnets do not repel each other.

The magnets are simply pressed into the holes and possibly secured with superglue.

Down in the ground can also optionally magnets be glued horizontally to keep the flap securely open.

The upper magnets in the boxing lid should be installed in any case.

Now you can still adjust to the fit of the flaps. For more matching accuracy the M1,6 screw can be used or the position of the bearing plates could be changed. Possibly should bevels mounted locally or material will be removed.

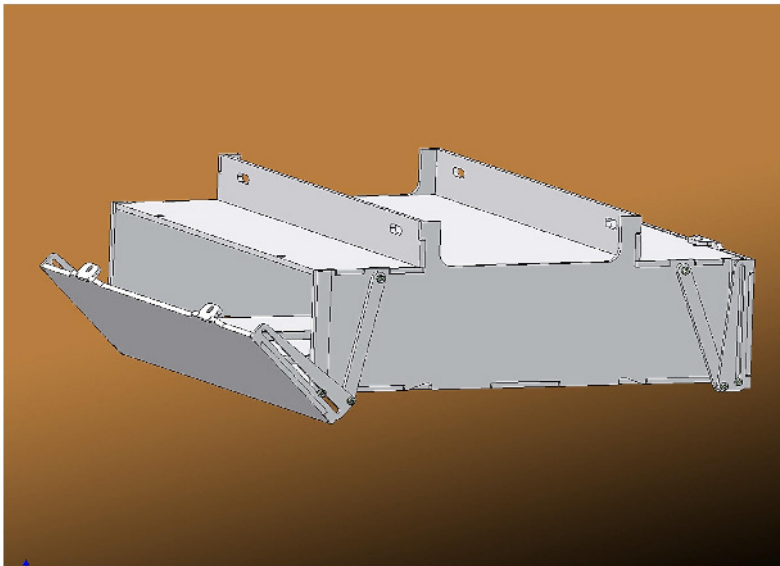

Annotation:

For technical reasons delivery also magnets with different dimensions may be enclosed.

Other new magnet pairs can be installed, this is done by their own discretion.

Good luck and have fun - your MDTechShop team

www.MDTechShop.de

For questions or replacement part requests please send a short e-mail.

Warning:

This is not a toy! It contains small parts! Keep it away from young children!