

Assembly Instruction

Storage box kit for TAMIYA Trucks (1:14)

Best.-Nr.: 2015-9101-090/130

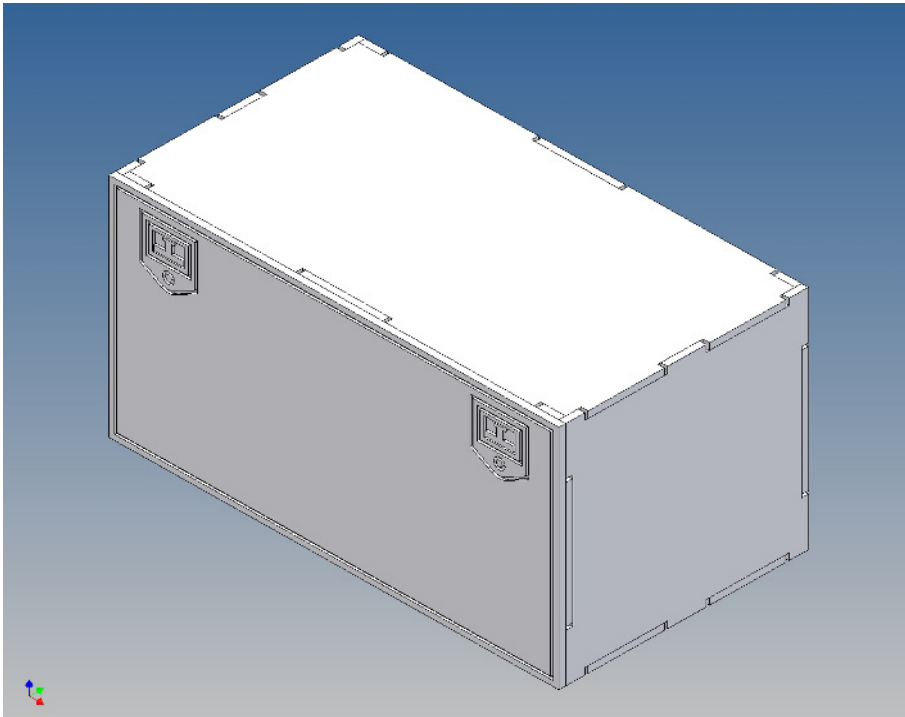

Version 1.0 – 23.12.2015

General Description

This polystyrene-milled parts set for a storage box was designed as an accessory to the TAMIYA trucks (1: 14).

The storage box can be mounted to the vehicle frame and has at the outer side a removable lid, which is held with hooks and magnets. Magnets will be in a separate bag. Pay attention to the polarity.

Inside the box technique can be accommodated.

Holes and threads for mounting must be provided at its own discretion.

For mounting on the vehicle frame are at distance spacers, these create a gap to accommodate any existing screw heads on the frame to produce

Assembly Procedure

Before you put the parts together please read the assembly instructions carefully and pay attention to the assembly sequence and test the fitting accuracy of the parts before gluing them together.

It is helpful to fix the parts at first only on a few points with super-glue and after a check along the edges fully with super-glue or a polystyrene-glue.

The parts are made of polystyrene, if you use super-glue in combination with activator spray, please be aware that the activator spray can destroy polystyrene – because of that you should use it very carefully or use only polystyrene-glue.

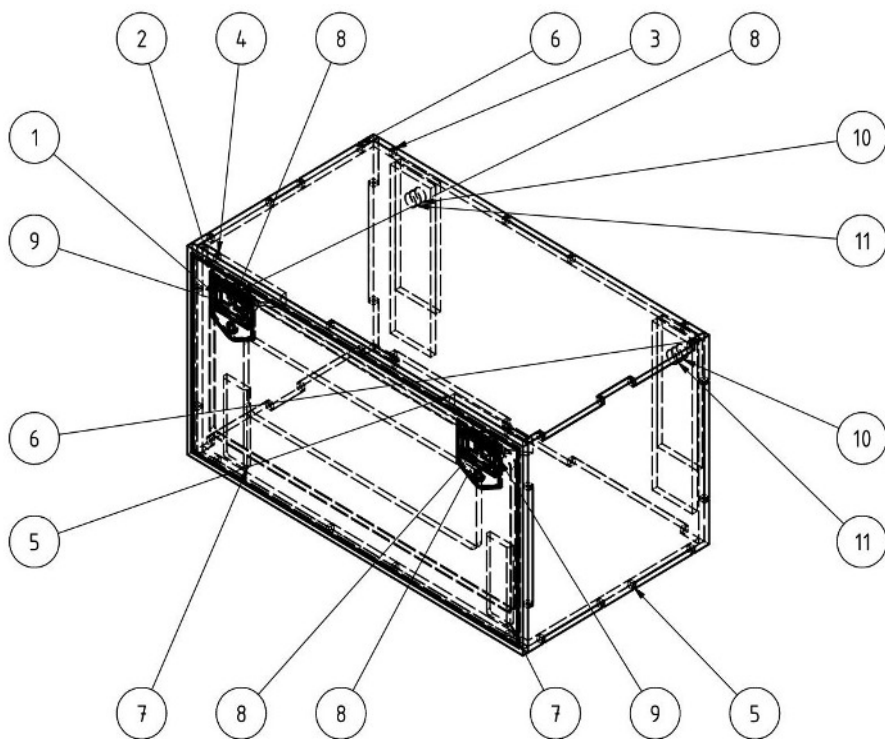

Teilleiste			
Pos.	Anz.	Bezeichnung	Bemerkung
1	1	100x52 Frontwand mit Gravur	
2	1	100x52 Füllung zu Wand mit Öffnung neu	
3	1	100x52 Rückwand	
4	1	100x52 Wand mit Öffnung neu	
5	2	100x56 Deckel Boden	
6	2	56x52 Stirnwand	
7	2	Haltestück neu	
8	4	Magnet d3x1	
9	2	Magnethalter d3	
10	2	Zwischenplatte 12x32	
11	2	Zwischenplatte 12x42	

Step 1 (engraved lid):

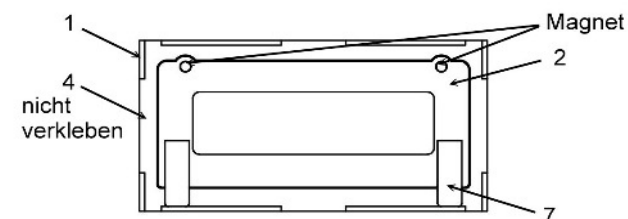
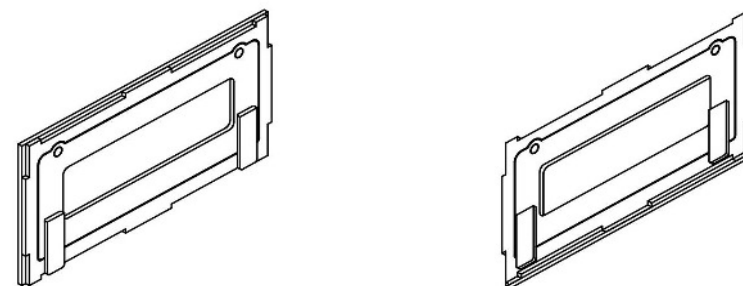
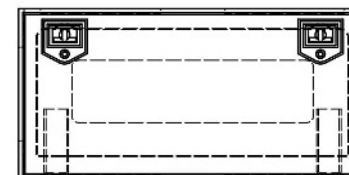

Initially, the lid is assembled, as well as take the frame member (4) as a template to help.

To ensure a good accuracy of fit of the cover to the actual box later, we clamp with at least two spring clamps the frame member (4) Round flush, from behind against the engraved lid (1) by the fitting (2) to accurately align (Engraving side out - magnet positions to lock imitations).

Before inserting or gluing the fitting the magnets must (diameter 3 mm - 1 mm thick) are glued into the part. Take care to avoid the magnetic surface and the inside is flush.

Later, when gluing the counter magnets in the magnet holder (Stage 2) ensure that the magnetic polarity is coupled in that the magnets do not repel each other.

Be at the bottom of each side, a holding lug (7) about 2 mm from the left or right edge and glued from below with a distance of 1.5 mm.

When the glue has hardened, you should feed out carefully the frame part (4), it is needed in the construction phase 2.

Step 2 (Storage box):

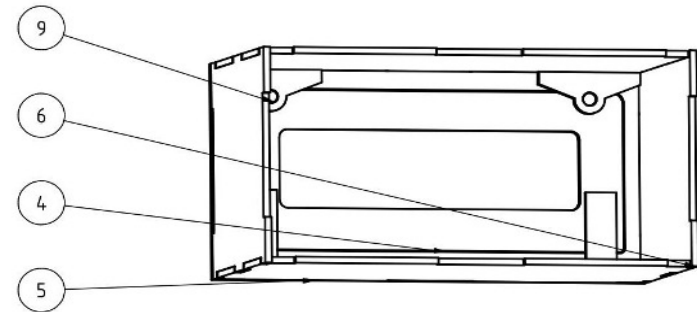

In the two magnet holders (9) each have a magnet (diameter 3 mm - 1 mm thick) is glued so that the magnet surface to the outer side is flush (Magnetic polarity note).

In the picture above, the cover is shown for illustrative purposes, set this course in the assembly aside for now.

The two end walls (6) with the bottom (5) and the frame part (4) adhering at right angles. Possibly initially fix the parts only with tape.

Place the cover (5) to the top - it is the identical part as the bottom (5).

The missing back wall (3) helps for a better positioning.

Then top each with a magnetic holder so sticking in the corners, that they rest against both edges and the magnets in the center of the bumps in the frame part (4) come to lie.

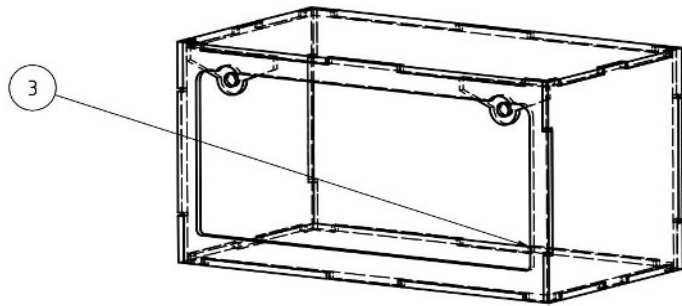

Fit the rear wall (3) back and glue especially all inner edges and the magnetic holder well.

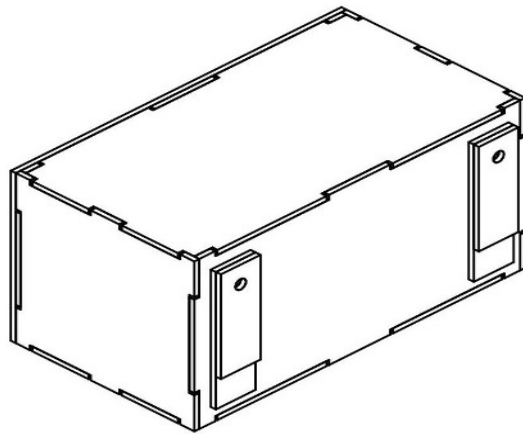

Here in the picture you can see the use of the distance spacers. At its discretion, depending pair a long and short pieces and matching drill holes.

Annotation:

For technical reasons delivery also magnets with different dimensions may be enclosed.

Good luck and have fun - your MDTechShop team

www.MDTechShop.de

For questions or replacement part requests please send a short e-mail.

Warning:

This is not a toy! It contains small parts! Keep it away from young children!